

## Recommended Changes to the Draft DVRPC FY2016 Transportation Improvement Program (TIP) for New Jersey

County	DB #	Project Title	Recommended Change
<b>DVRPC Highway Program - Schedule Adjustments or Cost Restructuring</b>			
Camden	355A	Route 295/42, Missing Moves, Bellmawr	Add \$5,500,000 DEMO (earmark) funds for a FY16 DES phase.
Mercer	D1408	Province Line Road Bike Trail	Add a \$391,000 FY16 CMAQ funded project back into the TIP for FY16 CON.
Mercer	D1507	Signal Upgrades	Add a \$1,000,000 FY14 STATE-DVRPC funded project back into the TIP for FY16 CON, and update project description by removing one of four intersections, Parkway Avenue (CR 634) at Parkside Avenue (CR 636).
Various	X065	Local CMAQ Initiatives	Decrease the FY16 EC phase by \$391,000 from \$910,000 to \$519,000 CMAQ funds to act as a resource for DB #D1408, Province Line Road Bike Trail.
<b>NJDOT Statewide Program - Schedule Adjustments or Cost Restructuring - These are Statewide Highway projects that are primarily programs managed by NJDOT on a statewide basis that are not specific to any particular MPO region or that provide direct support to NJDOT.</b>			
Various	X07A	Bridge Inspection	Increase the amount of STP funds each year from FY16 to FY25 by an overall \$4,000,000 from \$85,620,000 to \$89,620,000 STP funds.
Various	02393	Transportation and Community System Preservation Program	Remove this \$5,000,000 TCSP funded project from the TIP.
Various	04364	Transportation Safety Resource Center (TSRC)	Decrease the EC phase by a total of \$4,000,000 STP funds from FY16 to FY25 from \$16,000,000 to \$12,000,000, in which each year will reduce by \$400,000 from \$1,600,000 to \$1,200,000.

Draft for DVRPC Board as of September 8, 2015

## Recommended Changes to the Draft DVRPC FY2016 Transportation Improvement Program (TIP) for New Jersey

County	DB #	Project Title	Recommended Change
Various technical corrections, including:			
Burlington	15321	Route 70, Bridge over Mount Misery Brook	Update description and assign the correct Air Quality (AQ) code from SDX to S19 for this project in the DVRPC Highway Program.
Burlington	15385	Route 36, Nixon Drive to Pemberton Road	Correct Route # in project title to be Route 38 for this Study & Development project. Study & Development projects are currently in a conceptual phase and not yet ready to enter the design phase.
Mercer	031	Route 1, Penns Neck Improvements (CR 571)	Note MRP ID #84 for this "Tier 2" unfunded project.
Mercer	031B	Vaughn Drive Connector	Note MRP ID #138 for this "Tier 2" unfunded project.
Mercer	99368A	Route 33, Realignment, Hamilton & Robbinsville Twp.	Remove MRP ID #82 as this "Tier 2" unfunded project was previously removed from the long-range plan; correct AQ code from 2020M to FYN.
Various	D0406	RideECO Mass Marketing Efforts-- New Jersey	Update project description by replacing "Transitchek" with "RideECO." This is a project in the DVRPC Highway Program.
Various	T111, T06, T08, T09, T44, T135, T39, T34, T300	Bus Acquisition Program, Bus Passenger Facilities/Park and Ride, Bus Support Facilities and Equipment, Bus Vehicle and Facility Maintenance/Capital Maintenance, NEC Improvements, Preventive Maintenance - Bus, Preventive Maintenance - Rail, Rail Capital Maintenance, Transit Rail Initiatives	Update DVRPC-region specific information per line item, such as the number of bus garages in the region, average weekday ridership on the Northeast Corridor from 2014, etc.
Add photo credits for TIP front cover in Abstract page			
Add 7 earmark projects to the final TIP document that are in the DVRPC region, have received federal appropriations, and will not be programmed in the final S/TIP. These projects are currently found in Section 9 of the Draft STIP at <a href="http://www.state.nj.us/transportation/capital/stip1625/sec9/">http://www.state.nj.us/transportation/capital/stip1625/sec9/</a>			
Add page numbers and identify as a table for the table of contents for DVRPC Highway projects, DVRPC NJ TRANSIT projects, DVRPC DRPA/PATCO projects, Statewide Program, and Study and Development Program as Tables 11 to 15 in final TIP document.			
Note in Table 6 that SRTS and TAP projects are funded using statewide and regional SRTS and TAP funds. Also identify projects that will draw TAP or TE funds.			
Add Criteria weights chart to Appendix F: TIP Benefit Criteria			

**Draft for DVRPC Board as of September 8, 2015**

**RESOLUTION**

*by the Board of the Delaware Valley Regional Planning Commission*

**ADOPTION OF THE DVRPC FY2016 TRANSPORTATION IMPROVEMENT PROGRAM (TIP) FOR NEW JERSEY (FY2016-FY2019)**

**WHEREAS**, the Delaware Valley Regional Planning Commission (DVRPC) is the Metropolitan Planning Organization (MPO) responsible for developing and updating the Transportation Improvement Program (TIP) for the nine-county Philadelphia, Camden, and Trenton metropolitan areas as required by Section 134 of U.S.C. Title 23 and Section 5303 of U.S.C. Title 49; and,

**WHEREAS**, the Statewide and Metropolitan Planning Regulations (23 CFR Part 450 and 49 CFR Part 613) require that regional transportation plans and programs be developed by a MPO, approved by the Governor, reviewed by the Federal Transit Administration (FTA) and the Federal Highway Administration (FHWA); and,

**WHEREAS**, DVRPC has certified that the transportation planning process has been conducted in a manner meeting the requirements of all appropriate federal regulations; and,

**WHEREAS**, the nine-county DVRPC planning area has been designated by the US EPA as a nonattainment area for ozone for the 2008 eight-hour ozone standard, Delaware County has been designated a nonattainment area for the 2012 annual fine particulate matter (PM<sub>2.5</sub>) standard, portions of the counties of Burlington, Camden, Mercer and Philadelphia have been designated as a maintenance area for carbon monoxide (CO), and the nine-county planning area is part of two maintenance areas for the annual and 24-hour PM<sub>2.5</sub> standards as required by Clean Air Act as amended (CAAA) under the respective ozone, CO, and PM<sub>2.5</sub> National Ambient Air Quality Standards (NAAQS); and,

**WHEREAS**, MPO transportation plans and programs are required to conform to the purposes of State Implementation Plans (SIPs) and the CAAA under the Final Conformity Rule ("Final Rule") promulgated by the United States Environmental Protection Agency (US EPA) in November 1993 and amended in July 2004; and,

**WHEREAS**, the Final Conformity Rule requires that the MPO determine that the transportation plans and programs conform with the CAAA requirements by meeting criteria described in the Final Rule, and,

**WHEREAS**, DVRPC has completed conformity analysis of the TIPs and the Long-Range Plan according to the procedures detailed in the Final Rule under the CAAA in a manner meeting the requirements of all appropriate federal and state regulations pertaining to statewide and metropolitan planning and air quality; and,

**WHEREAS**, the analysis demonstrates that emissions of ozone precursors, direct PM<sub>2.5</sub> and PM<sub>2.5</sub> precursors are less in 2017, 2020, 2025, 2035, and 2040 than the applicable established budgets for the respective analysis year; and that emissions estimates of CO are not required for areas with limited maintenance plans, and,

**WHEREAS**, all other requirements of the Final Rule and all appropriate federal and state regulations have been met; and,

**WHEREAS**, the projects included in this TIP have been drawn from a long-range plan developed in accordance with this certified planning process and which plan has been found to conform to all applicable state and federal laws and rules pertaining to air quality, and,

**WHEREAS**, the DVRPC has provided a reasonable opportunity for citizens, transit users, private transportation providers and all interested parties to participate and have their views considered in the development and adoption of this TIP; and,

**WHEREAS**, this TIP is consistent with and furthers the implementation of the DVRPC's *Connections 2040* long-range plan, as well as local, county, regional and state plans and policies; and,

**WHEREAS**, the projects in this TIP have been fiscally constrained by the member agencies to a funding level which is reasonable for the Greater Philadelphia region to expect to receive; and,

**WHEREAS**, the projects included in this TIP were selected using a cooperative approach based on reaching consensus of the regional priority for all transportation improvements;

**NOW, THEREFORE, BE IT RESOLVED**, that the Delaware Valley Regional Planning Commission adopts the FY 2016 Transportation Improvement Program (TIP) for New Jersey (FY2016-FY2019) as the region's official selection of transportation projects for federal funding.

**BE IT FURTHER RESOLVED**, that the Delaware Valley Regional Planning Commission determines that the FY 2016 Transportation Improvement Program for New Jersey (FY2016-FY2019) conforms to the State Implementation Plan of New Jersey and is consistent with the Final Conformity Rule.

Adopted this 30th day of September 2015  
by the Board of the Delaware Valley Regional Planning Commission.

I do hereby certify that the foregoing is a true copy of Resolution No. B-FY16-003.

---

Renee Wise, Recording Secretary



**Summary of Public Comments**  
*on the DRAFT DVRPC FY2016-2019*  
*TIP for New Jersey*

THIS SECTION SUMMARIZES ALL PUBLIC COMMENTS  
THAT WERE SUBMITTED TO DVRPC DURING THE  
PUBLIC COMMENT PERIOD.

# Index of Comments on the DVRPC Draft FY2016-2019 Transportation Improvement Program (TIP) for New Jersey

ITEM ID#	COMMENTOR	SUMMARY OF COMMENT
<b>Comments Received from the General Public</b>		
<b>Burlington County</b>		
<b>DB #: 02397: Route 130, Columbus Road/Jones Street</b>		
001	Cyndi Steiner	Supports project, if it includes a high visibility continental crosswalk.
002	Enthusiastic Supporter	Can utility work be completed in Fall 2015 to allow Spring 2016 resurfacing & intersection improvement? Is there sufficient space on Route 130 for trucks waiting to make the left turn? Would the dedicated NB LT lane extend south of the intersection with Columbus?
003	John Boyle	Supports project, if it includes a high visibility continental crosswalk.
<b>DB #: 12307: Route 38, South Church Street (CR 607) to Fellowship Road (CR 673), Operational and Safety Improvements</b>		
004	Cyndi Steiner	Project lacks pedestrian crossing for Route 38. See Moorestown Bicycle Plan.
005	John Boyle	Project lacks pedestrian crossing for Route 38. See Moorestown Bicycle Plan.
<b>DB #: 12346: Route 130/206, CR 528 (Crosswicks Rd) to Rt 206 at Amboy Rd</b>		
006	Cyndi Steiner	Supports project
<b>DB #: 12346A: Route 130, CR 545 (Farnsworth Avenue)</b>		
007	Cyndi Steiner	Supports project
<b>DB #: 12415: Route 130, Van Sciver Pkwy to Crafts Creek</b>		
008	Cyndi Steiner	Van Sciver Parkway needs a safe pedestrian crossing.
009	John Boyle	Van Sciver Parkway needs a safe pedestrian crossing.
<b>DB #: D9902: Hanover Street Bridge over Rancocas Creek, CR 616</b>		
010	Cyndi Steiner	Supports project
011	John Boyle	Supports project
<b>DB #: D9912A: South Pemberton Road, CR 530, Phase 2</b>		
012	John Boyle	Not supportive of project design and requests project to include bicycle/pedestrian friendly elements.
<b>Camden County</b>		
<b>DB #: 12313: Route 42, Bridges over Blackwood Railroad Trail</b>		
013	Cyndi Steiner	Supports project's inclusion of attractive LED lighting and anti graffiti coating to the underpass
014	John Boyle	Supports project's inclusion of attractive LED lighting and anti graffiti coating to the underpass
<b>DB #: 12346: Route 130/206, CR 528 (Crosswicks Rd) to Rt 206 at Amboy Rd</b>		
015	John Boyle	Supports project
<b>DB #: 12346A: Route 130, CR 545 (Farnsworth Avenue)</b>		
016	John Boyle	Supports project
<b>DB #: 15375: Route 30, Cooper Street to Grove Street</b>		
017	Christopher Wawak	Project should include bike improvements (e.g., protected bike lanes).
<b>DB #: D0902: River Road Improvements, Cramer Hill</b>		
018	Cyndi Steiner	Supports project
019	John Boyle	Supports project
<b>DB #: D1505: ADA Improvements</b>		
020	Cyndi Steiner	Supports project
021	John Boyle	Supports project
<b>General TIP Comments: Bicycle/pedestrian improvements requests</b>		
022	Joseph Russell	Project should include a striped bike lane striped on Route 30 from the old Collingswood circle at Route 130 to the easternmost part of this project.

Friday, August 28, 2015

# Index of Comments on the DVRPC Draft FY2016-2019 Transportation Improvement Program (TIP) for New Jersey

ITEM ID#	COMMENTOR	SUMMARY OF COMMENT
<b>Comments Received from the General Public</b>		
<b>General TIP Comments: General requests, concerns, and/or questions</b>		
023	Bus Rider	There are two dangerous signals along MLK Blvd Westbound at the entrance to the Walter Rand Bus Terminal and at Broadway in the City of Camden.
024	Concerned Driver	Have either Camden or Gloucester County submitted any proposals to improve the roadway along Sicklerville/Williamstown Road near the Avandale Park-and-Ride with sidewalks, bike lanes, reduced speed limits, additional lighting, signage, or any other improvements? And if not, what would be the best way to bring this to the County's attention?
025	Jeff Taylor	Requests NJDOT to add an overhead cantilever sign above the roadway between I-295 and Fellowship Road at approximately milepost 27.42
<b>General TIP Comments: Requests for additional funding and/or staff to line item/project</b>		
026	Joseph Russell	The County Bicycle and Multi-use Trail Master Plan should be State funded.
<b>Gloucester County</b>		
<b>DB #: 07369: Route 322, Corridor Congestion Relief Project</b>		
027	Joseph Russell	Not supportive of project
<b>DB #: 97112B: Route 322, Kings Highway (CR 551)</b>		
028	Charles Dougherty	Hopes project will move forward and not be further delayed.
<b>DB #: D1203: Gloucester County Multi-Purpose Trail Extension - Glassboro Elk Trail</b>		
029	Cyndi Steiner	Supports project; TIP project description should mention that it is part of the Circuit trail network and is therefore relevant to the Long Range Plan.
030	John Boyle	Supports project; TIP project description should mention that it is part of the Circuit trail network and is therefore relevant to the Long Range Plan.
031	Kevin Somdahl-Sands	Asks if project was funded in the FY2014 TIP; concern with this project's delivery schedule; concern with Gloucester County's share of bicycle/pedestrian funding; requests for additional funding for bicycle/pedestrian infrastructure improvements in future.
032	Silvia Ascarelli	Supports project
<b>General TIP Comments: General requests, concerns, and/or questions</b>		
033	Jeff Taylor	Notes three (3) locations with traffic light sensors and coordination issues at: NJDOT jurisdiction intersection of the ramp to I-295 North at Grove Rd (County Rt. 643) and Friars Blvd in West Deptford, the NJDOT jurisdiction intersection of NJ Rt. 45 and College Blvd & Riviera Drive on the West Deptford/Deptford Twp border, and the Gloucester County jurisdiction intersection of Clements Bridge Rd (County Route 544) and Almonesson Road (County Route 621); suggests additional funds in TIP and assignment of NJDOT/county personnel to monitor traffic lights more frequently to more promptly address traffic light issues
034	Jeff Taylor	Suggests transportation and streetscape improvements for roads serving as the Gateway to Rowan, such as Route 322
<b>General TIP Comments: Requests for a new TIP project/line item</b>		
035	Jeff Taylor	Requests NJDOT to add an intersection modification project on State Route 42 and Gloucester County Route 689 (Berlin-Cross Keys Road) to the TIP
<b>Mercer County</b>		
<b>DB #: 551B: Route 29, Delaware River Pedestrian/Bike Path, Stacy Park to Assunpink Creek</b>		
036	Silvia Ascarelli	Supports project
<b>DB #: 95040: Route 206, Whitehorse Circle (CR 533, 524)</b>		
037	Cyndi Steiner	Supports project
038	John Boyle	Supports project
<b>DB #: D0701: Princeton-Hightstown Road Improvements, CR 571</b>		

Friday, August 28, 2015

# Index of Comments on the DVRPC Draft FY2016-2019 Transportation Improvement Program (TIP) for New Jersey

ITEM ID#	COMMENTOR	SUMMARY OF COMMENT
<b>Comments Received from the General Public</b>		
039	Jerry Foster	Not supportive of project design and requests project to include bicycle/pedestrian friendly elements.
040	Silvia Ascarelli	Not supportive of project design and requests project to include bicycle/pedestrian friendly elements.
<b>General TIP Comments: General requests, concerns, and/or questions</b>		
041	Mayor Liz Lempert	Suggests improvements on NJDOT routes, Alexander Street/Washington Road/Harrison Streets, and proposed bridge replacement project on Alexander Road over Stony Brook that affect Princeton Township
<b>Various Counties</b>		
<b>DB #: 06327: Local Aid Grant Management System</b>		
042	Cyndi Steiner	Supports project
043	John Boyle	Supports project
<b>DB #: 06401: Pedestrian Safety Improvement Program</b>		
044	Cyndi Steiner	Supports project
045	John Boyle	Supports project
<b>DB #: 06402: Safe Streets to Transit Program</b>		
046	Cyndi Steiner	Supports project; notes underfunding of program line item; suggests program to include safe bicycle access.
047	John Boyle	Supports project; notes underfunding of program line item; suggests program to include safe bicycle access.
<b>DB #: 06403: Pedestrian Safety Improvement Design and Construction</b>		
048	Cyndi Steiner	Supports project
049	John Boyle	Supports project
<b>DB #: 09388: Highway Safety Improvement Program Planning</b>		
050	Cyndi Steiner	Requests for additional funding to Statewide line item.
051	John Boyle	Requests for additional funding to Statewide line item.
<b>DB #: 10347: Local Aid Consultant Services</b>		
052	Cyndi Steiner	Supports project
053	John Boyle	Supports project
<b>DB #: 99409: Recreational Trails Program</b>		
054	Cyndi Steiner	Supports project
055	John Boyle	Supports project
<b>DB #: D0204: Transportation and Community Development Initiative (TCDI) DVRPC</b>		
056	Cyndi Steiner	Supports project
057	John Boyle	Supports project
<b>DB #: X03E: Resurfacing Program</b>		
058	Cyndi Steiner	Supports project
059	John Boyle	Supports project
<b>DB #: X065: Local CMAQ Initiatives</b>		
060	Cyndi Steiner	Supports project
061	John Boyle	Supports project
<b>DB #: X107: Transportation Alternatives Program</b>		
062	Cyndi Steiner	Supports project
063	John Boyle	Supports project

Friday, August 28, 2015



# Index of Comments on the DVRPC Draft FY2016-2019 Transportation Improvement Program (TIP) for New Jersey

ITEM ID#	COMMENTOR	SUMMARY OF COMMENT
<b>Comments Received from the General Public</b>		
<b>DB #: X140: Planning and Research, State</b>		
064	Cyndi Steiner	Requests dedicated funding for the Statewide Bicycle and Pedestrian Plan update.
065	John Boyle	Requests dedicated funding for the Statewide Bicycle and Pedestrian Plan update.
<b>DB #: X185: Bicycle &amp; Pedestrian Facilities/Accommodations</b>		
066	Cyndi Steiner	Requests for additional funding and staff to Statewide line item.
067	John Boyle	Requests for additional funding and staff to Statewide line item.
<b>DB #: X242: Crash Reduction Program</b>		
068	Cyndi Steiner	Include bicycle and pedestrian improvements in this Statewide program; notes rumble strip installations should be compatible based on the 2012 AASHTO Guide for the Development of Bicycle Facilities.
069	John Boyle	Include bicycle and pedestrian improvements in this Statewide program; notes rumble strip installations should be compatible based on the 2012 AASHTO Guide for the Development of Bicycle Facilities.
<b>General TIP Comments: Requests for a new TIP project/line item; bicycle/pedestrian improvement requests</b>		
070	Cyndi Steiner	Requests for a new line item in TIP for the Circuit; encourages NJDOT to replace current bicycle compatibility guidelines from the 2012 AASHTO Guide for the Development of Bicycle Facilities and the NACTO Urban Bikeway Design Guide
071	John Boyle	Requests for a new line item in TIP for the Circuit; encourages NJDOT to replace current bicycle compatibility guidelines from the 2012 AASHTO Guide for the Development of Bicycle Facilities and the NACTO Urban Bikeway Design Guide
<b>General TIP Comments: Say YES to a Circuit Line Item in the NJ TIP</b>		
072	AJ Ford	Requests for a new line item in TIP for the Circuit
073	Alan Mann	Requests for a new line item in TIP for the Circuit
074	Alan Mattioni	Requests for a new line item in TIP for the Circuit
075	Ann Gillespie	Requests for a new line item in TIP for the Circuit
076	Anthony Goodman	Requests for a new line item in TIP for the Circuit
077	Antonina Renner	Requests for a new line item in TIP for the Circuit
078	Audrey Maest	Requests for a new line item in TIP for the Circuit
079	Ben Carter	Requests for a new line item in TIP for the Circuit
080	Bill Garrett	Requests for a new line item in TIP for the Circuit
081	Brenda Englehart	Requests for a new line item in TIP for the Circuit
082	Bruce Rubin	Requests for a new line item in TIP for the Circuit
083	Bryan Richards	Requests for a new line item in TIP for the Circuit
084	Carmen Viola	Requests for a new line item in TIP for the Circuit
085	Carrie Kelly	Requests for a new line item in TIP for the Circuit
086	Cecelia Gaines	Requests for a new line item in TIP for the Circuit
087	Cheryl Dzubak	Requests for a new line item in TIP for the Circuit
088	Cheryl Huntzinger	Requests for a new line item in TIP for the Circuit
089	Chris Cominetto	Requests for a new line item in TIP for the Circuit
090	Craig Boddorff	Requests for a new line item in TIP for the Circuit
091	Craig Morgan	Requests for a new line item in TIP for the Circuit
092	Crystal Swanson	Requests for a new line item in TIP for the Circuit
093	Cyndi Steiner	Requests for a new line item in TIP for the Circuit
094	Dan Cogan	Requests for a new line item in TIP for the Circuit

Friday, August 28, 2015

# Index of Comments on the DVRPC Draft FY2016-2019 Transportation Improvement Program (TIP) for New Jersey

<i>ITEM ID#</i>	<i>COMMENTOR</i>	<i>SUMMARY OF COMMENT</i>
<b>Comments Received from the General Public</b>		
095	Daniel Hauber	Requests for a new line item in TIP for the Circuit
096	Daniel Kramer	Requests for a new line item in TIP for the Circuit
097	Daniel Rappoport	Requests for a new line item in TIP for the Circuit
098	Daniel Wakeman	Requests for a new line item in TIP for the Circuit
099	Dave Cox	Requests for a new line item in TIP for the Circuit
100	David Durham	Requests for a new line item in TIP for the Circuit
101	David Hulnick	Requests for a new line item in TIP for the Circuit
102	David Steinberg	Requests for a new line item in TIP for the Circuit
103	Denise Everett	Requests for a new line item in TIP for the Circuit
104	Dennis McDonald	Requests for a new line item in TIP for the Circuit
105	Diane Bacher	Requests for a new line item in TIP for the Circuit
106	Donald Elsas	Requests for a new line item in TIP for the Circuit
107	Donald Pillsbury	Requests for a new line item in TIP for the Circuit
108	Douglas Cowperthwaite	Requests for a new line item in TIP for the Circuit
109	Dr. Mark Waltzer	Requests for a new line item in TIP for the Circuit
110	Ed Arnold	Requests for a new line item in TIP for the Circuit
111	Eddie Monterrosa	Requests for a new line item in TIP for the Circuit
112	Eleanor Frank Hunt	Requests for a new line item in TIP for the Circuit
113	Eleanor Horne	Requests for a new line item in TIP for the Circuit
114	Frank Kearney	Requests for a new line item in TIP for the Circuit
115	Frank Wolf	Requests for a new line item in TIP for the Circuit
116	Glen Davis	Requests for a new line item in TIP for the Circuit
117	Gwyn Hurd	Requests for a new line item in TIP for the Circuit
118	Henry Jansma	Requests for a new line item in TIP for the Circuit
119	Hilary Butera	Requests for a new line item in TIP for the Circuit
120	Ilene Dougherty	Requests for a new line item in TIP for the Circuit
121	Jacquelyn Pillsbury	Requests for a new line item in TIP for the Circuit
122	Jaime Phillips	Requests for a new line item in TIP for the Circuit
123	James Andrews	Requests for a new line item in TIP for the Circuit
124	James Flaherty	Requests for a new line item in TIP for the Circuit
125	James Licht	Requests for a new line item in TIP for the Circuit
126	Jane Yosko	Requests for a new line item in TIP for the Circuit
127	Jay Meier	Requests for a new line item in TIP for the Circuit
128	Jeffrey Laurenti	Requests for a new line item in TIP for the Circuit
129	Jeffrey Meyers	Requests for a new line item in TIP for the Circuit
130	Jess Everett	Requests for a new line item in TIP for the Circuit
131	Joan Buehler	Requests for a new line item in TIP for the Circuit
132	Joan Prins	Requests for a new line item in TIP for the Circuit
133	Joe Orr	Requests for a new line item in TIP for the Circuit
134	John Joyce	Requests for a new line item in TIP for the Circuit
135	John Mcdaniel	Requests for a new line item in TIP for the Circuit
136	John Mueller	Requests for a new line item in TIP for the Circuit

Friday, August 28, 2015

# Index of Comments on the DVRPC Draft FY2016-2019 Transportation Improvement Program (TIP) for New Jersey

<i>ITEM ID#</i>	<i>COMMENTOR</i>	<i>SUMMARY OF COMMENT</i>
<b>Comments Received from the General Public</b>		
137	John Poserina	Requests for a new line item in TIP for the Circuit
138	Joseph Brescia	Requests for a new line item in TIP for the Circuit
139	Joseph Russell	Requests for a new line item in TIP for the Circuit
140	Judyann McCarthy	Requests for a new line item in TIP for the Circuit
141	Julie Quinn	Requests for a new line item in TIP for the Circuit
142	June Bente	Requests for a new line item in TIP for the Circuit
143	Justin Clerval	Requests for a new line item in TIP for the Circuit
144	Kaitlyn O'Loughlin	Requests for a new line item in TIP for the Circuit
145	Karen Dieterly	Requests for a new line item in TIP for the Circuit
146	Ken Goldberg	Requests for a new line item in TIP for the Circuit
147	Ken Wilkie	Requests for a new line item in TIP for the Circuit
148	Kevin Caviston	Requests for a new line item in TIP for the Circuit
149	Kyle Konopka	Requests for a new line item in TIP for the Circuit
150	Lauren Calise	Requests for a new line item in TIP for the Circuit
151	Lisa Joy	Requests for a new line item in TIP for the Circuit
152	Lyndsey Fraser	Requests for a new line item in TIP for the Circuit
153	M. Murphy	Requests for a new line item in TIP for the Circuit
154	Marc Silver	Requests for a new line item in TIP for the Circuit
155	Marie Holmdal	Requests for a new line item in TIP for the Circuit
156	Michael Cannon	Requests for a new line item in TIP for the Circuit
157	Michael Castagner	Requests for a new line item in TIP for the Circuit
158	Michael Vitez	Requests for a new line item in TIP for the Circuit
159	Michael Wisniewski	Requests for a new line item in TIP for the Circuit
160	Mike Murphy	Requests for a new line item in TIP for the Circuit
161	Mindy Gumminger	Requests for a new line item in TIP for the Circuit
162	Neil Samuels	Requests for a new line item in TIP for the Circuit
163	Norman Beil	Requests for a new line item in TIP for the Circuit
164	P. Schindel	Requests for a new line item in TIP for the Circuit
165	Pam Mount	Requests for a new line item in TIP for the Circuit
166	Patrice Leonetti	Requests for a new line item in TIP for the Circuit
167	Patricia Addis-Hudson	Requests for a new line item in TIP for the Circuit
168	Patricia Lyons	Requests for a new line item in TIP for the Circuit
169	Patrick Randow	Requests for a new line item in TIP for the Circuit
170	Paul Moul	Requests for a new line item in TIP for the Circuit
171	Paul Van Cleve	Requests for a new line item in TIP for the Circuit
172	Paul Viggiano	Requests for a new line item in TIP for the Circuit
173	Renee Meland	Requests for a new line item in TIP for the Circuit
174	Richard Moore	Requests for a new line item in TIP for the Circuit
175	Richard Titley	Requests for a new line item in TIP for the Circuit
176	Rick Moore	Requests for a new line item in TIP for the Circuit
177	Robert Bonner	Requests for a new line item in TIP for the Circuit
178	Robert Cummings	Requests for a new line item in TIP for the Circuit

Friday, August 28, 2015

# Index of Comments on the DVRPC Draft FY2016-2019 Transportation Improvement Program (TIP) for New Jersey

ITEM ID#	COMMENTOR	SUMMARY OF COMMENT
<b>Comments Received from the General Public</b>		
179	Ron Bruner	Requests for a new line item in TIP for the Circuit
180	S. Nisenfeld	Requests for a new line item in TIP for the Circuit
181	Sam Hartman	Requests for a new line item in TIP for the Circuit
182	Sam Spanier	Requests for a new line item in TIP for the Circuit
183	Sandra Shapiro	Requests for a new line item in TIP for the Circuit
184	Scott Krause	Requests for a new line item in TIP for the Circuit
185	Scott Layou	Requests for a new line item in TIP for the Circuit
186	Shelley Hill	Requests for a new line item in TIP for the Circuit
187	Silvia Ascarelli	Requests for a new line item in TIP for the Circuit
188	Stephen Brown	Requests for a new line item in TIP for the Circuit
189	Stephen Nerney	Requests for a new line item in TIP for the Circuit
190	Steve Friedlander	Requests for a new line item in TIP for the Circuit
191	Steven Fenster	Requests for a new line item in TIP for the Circuit
192	Tara Emrick	Requests for a new line item in TIP for the Circuit
193	The Circuit Coalition	Requests for a new line item in TIP for the Circuit
194	Thomas Atherholt	Requests for a new line item in TIP for the Circuit
195	Tim Ifill	Requests for a new line item in TIP for the Circuit
196	Tom Hammell	Requests for a new line item in TIP for the Circuit
197	Tom Messick	Requests for a new line item in TIP for the Circuit
198	William Hunt	Requests for a new line item in TIP for the Circuit
<b>DRPA/PATCO</b>		
<b>DB #: D0906: Install Elevators, PATCO</b>		
199	Joseph Russell	Supports project
<b>DB #: DR036: Transit Enhancements</b>		
200	Cyndi Steiner	Supports project
201	John Boyle	Supports project
<b>DB #: DR046: DRPA - Rebuild PATCO Cars</b>		
202	Cyndi Steiner	Supports project
203	John Boyle	Supports project
<b>NJ TRANSIT</b>		
<b>DB #: T210: Transit Enhancements/Transp Altern Prog (TAP)/Altern Transit Improv (ATI)</b>		
204	Joseph Russell	Suggests Bus Rapid Transit study for Routes 70 and 73
<b>DB #: T300: Transit Rail Initiatives</b>		
205	Joseph Russell	Line item should emphasize the Camden-Glassboro Light Rail Line and NJ TRANSIT's Atlantic City line.
<b>DB #: T44: NEC Improvements</b>		
206	Joseph Russell	Supports project
<b>DB #: T88: Study and Development</b>		
207	Joseph Russell	Line item should fund a study of improvements to the Walter Rand Transportation Center in City of Camden because it does not service as many busses as they arrive at the station, and it will have to be expanded when the Camden-Glassboro line is built.

Friday, August 28, 2015



**Agency Responses to  
Public Comments**  
*on the DRAFT DVRPC FY2016-2019  
TIP for New Jersey*

---

THIS SECTION INCLUDES ALL RESPONSES TO THE  
PUBLIC COMMENTS THAT WERE SUBMITTED DURING  
THE PUBLIC COMMENT PERIOD.

# Summary of Agency Responses on the DVRPC Draft FY2016-2019 Transportation Improvement Program (TIP) for New Jersey

## Responses Received for Comments from the General Public

### Burlington County

#### DB #: 02397: Route 130, Columbus Road/Jones Street

Item ID: 001, 003

**Agency Response by DVRPC:**

Thank you for your comment. It has been forwarded to NJDOT.

**Agency Response by NJDOT:**

Support acknowledged.

Item ID: 002

**Agency Response by NJDOT:**

As noted, the utility construction phase of work is scheduled for the spring of 2016, as the project is currently in design. Prior to the start of construction, the design would have to be reviewed and approved and, in addition, the construction would have to be advertised, bid, and awarded. Thus, there is not enough time to complete the construction work in the Fall 2015. As noted in the description, this project provides a dedicated left-turn lane on Jones Street from Route 130 northbound.

#### DB #: 12307: Route 38, South Church Street (CR 607) to Fellowship Road (CR 673), Operational and Safety Improvements

Item ID: 004, 005

**Agency Response by NJDOT:**

NJDOT will consider the Moorestown bicycle plan during the preliminary phase of work scheduled for FY 2016.

#### DB #: 12346: Route 130/206, CR 528 (Crosswicks Rd) to Rt 206 at Amboy Rd

Item ID: 006

**Agency Response by DVRPC:**

Thank you for your comment. It has been forwarded to NJDOT.

**Agency Response by NJDOT:**

Support acknowledged.

#### DB #: 12346A: Route 130, CR 545 (Farnsworth Avenue)

Item ID: 007

**Agency Response by DVRPC:**

Thank you for your comment. It has been forwarded to NJDOT.

**Agency Response by NJDOT:**

Support acknowledged.

#### DB #: 12415: Route 130, Van Sciver Pkwy to Crafts Creek

Item ID: 008, 009

**Agency Response by NJDOT:**

This is a resurfacing, therefore a pedestrian crossing is not anticipated at this time.

#### DB #: D9902: Hanover Street Bridge over Rancocas Creek, CR 616

Item ID: 010, 011

**Agency Response by Burlington County:**

Thank you for your support.

#### DB #: D9912A: South Pemberton Road, CR 530, Phase 2

# Summary of Agency Responses

## on the

### DVRPC Draft FY2016-2019 Transportation Improvement Program (TIP)

### for New Jersey

#### Responses Received for Comments from the General Public

**Item ID:** 012

**Agency Response by Burlington County:**

Burlington County intends to comply with all applicable federal and state regulations with regard to bicycle and pedestrian access along CR 530. The additional ROW necessary for the construction of sidewalks, however has been limited by the presence of the project within the Pinelands. Bus stops will be appropriately protected and built to NJ TRANSIT recommendations.

#### Camden County

**DB #: 12313: Route 42, Bridges over Blackwood Railroad Trail**

**Item ID:** 013, 014

**Agency Response by DVRPC:**

Thank you for your comment. It has been forwarded to NJDOT.

**Agency Response by NJDOT:**

NJDOT will consider both LED lighting and anti graffiti coating during the design phase of work scheduled for FY 2017.

**DB #: 12346: Route 130/206, CR 528 (Crosswicks Rd) to Rt 206 at Amboy Rd**

**Item ID:** 015

**Agency Response by DVRPC:**

Thank you for your comment. It has been forwarded to NJDOT.

**Agency Response by NJDOT:**

Support acknowledged.

**DB #: 12346A: Route 130, CR 545 (Farnsworth Avenue)**

**Item ID:** 016

**Agency Response by DVRPC:**

Thank you for your comment. It has been forwarded to NJDOT.

**Agency Response by NJDOT:**

Support acknowledged.

**DB #: 15375: Route 30, Cooper Street to Grove Street**

**Item ID:** 017

**Agency Response by NJDOT:**

NJDOT is about to begin a study, called Concept Development for the Rt 30 Cooper Street to Grove Street, UPC 153750, in City of Camden, Borough of Oaklyn and Borough of Haddon Heights. During the study, the need for a bicycle facility will be reviewed. It may be possible to add a bicycle facility to this segment of Rt 30 but DOT will not make this decision until completing the Concept Development study.

**DB #: D0902: River Road Improvements, Cramer Hill**

**Item ID:** 018, 019

**Agency Response by DVRPC:**

Thank you for your comment. It has been forwarded to the City of Camden.

**Agency Response by City of Camden:**

Thank you for your support.

**DB #: D1505: ADA Improvements**

# Summary of Agency Responses on the DVRPC Draft FY2016-2019 Transportation Improvement Program (TIP) for New Jersey

## Responses Received for Comments from the General Public

**Item ID:** 020, 021

**Agency Response by DVRPC:**

Thank you for your comment. It has been forwarded to the City of Camden.

**Agency Response by City of Camden:**

Thank you for your support.

### General TIP Comments: Bicycle/pedestrian improvements requests

**Item ID:** 022

**Agency Response by NJDOT:**

Assuming Mr. Russell is referring to the Route 30, Cooper Street to Grove Street (DB #15375) project in City of Camden, Borough of Oaklyn and Borough of Haddon Heights, this project is about to begin a study, called Concept Development, by NJDOT. During the study, the need for a bicycle facility will be reviewed. It may be possible to add a bicycle facility to this segment of Rt 30 but NJDOT will not make this decision until completing the Concept Development study."

### General TIP Comments: General requests, concerns, and/or questions

**Item ID:** 023

**Agency Response by DVRPC:**

Thank you for your comment. It has been forwarded to the City of Camden.

**Item ID:** 024

**Agency Response by Camden County:**

At this time Camden County is not aware of any safety issues within it cart way. Issues related to sidewalks, speed limit, speed enforcement and lighting are local issues that should be address on a municipal level. This road is not currently scheduled for re-engineering or maintenance. When it does get scheduled the County partners with the local municipality to help provide roadways enhancements that meet everyone's needs.

**Agency Response by Gloucester County:**

The Avandale Park and Ride is within Camden County. The County line for Gloucester County is about a mile away with the Avandale facility separated within Camden County by the AC Expressway interchange and a bridge over the Egg Harbor River before you enter Gloucester County's jurisdiction. Gloucester County starts at the Holiday City development. Any improvements within Gloucester County would have little direct impact on this facility. Gloucester County has requested through DVRPC local scope development funding for the Gloucester County's jurisdictional section of Sicklerville Road (it was not funded however).

**Item ID:** 025

**Agency Response by NJDOT:**

NJDOT has two Programs that address Sign Structure issues; DBNUM: X239 / UPC: 800008 Sign Structure Inspection Program and DBNUM: X239A Sign Structure Rehabilitation/Replacement Program.

### General TIP Comments: Requests for additional funding and/or staff to line item/project

**Item ID:** 026

**Agency Response by Camden County:**

The County is implementing this plan through its annual road program. The County uses a Complete Streets policy and reviews and considers the need for such facilities for each road project. Through State Aid and Federal resources like Transportation Enhancements and CMAQ funding, the County uses TIP money regularly to achieve the goals of the Bicycle and Multi-use Trail Plan.

## Gloucester County

**DB #: 07369: Route 322, Corridor Congestion Relief Project**



# Summary of Agency Responses

## on the

### DVRPC Draft FY2016-2019 Transportation Improvement Program (TIP)

### for New Jersey

#### Responses Received for Comments from the General Public

Item ID: 027

##### Agency Response by DVRPC:

Thank you for your comments on this project. DVRPC concurs with your concern about adding new road capacity without careful planning. It leads a regional Congestion Management Process for the purpose of integrated, multimodal planning to manage congestion while advancing regional goals. Please note that this project in Harrison Township is already completed and has been opened to traffic since 2012. The project appears on the TIP because of the Mullica Hill Congestion Relief Project Agreement signed by NJDOT and Gloucester County in 2007. Both parties agreed that NJDOT would provide \$15 million total State funds to Gloucester County for this project starting with \$1 million per year over three fiscal years beginning in State Fiscal Year (SFY) 2009 to SFY 2011, then \$1.5 million per year over four fiscal years from SFY 2012 to SFY 2015, and then \$2 million per year over three fiscal years from SFY 2016 to SFY 2018. Gloucester County would be responsible for any costs exceeding the \$15 million. The delay along U.S. Route 322 through the village of Mullica Hill was one of the most noticeable bottleneck problems in the region at the time, where a Level of Service F was common during any peak period (off-season or during the summer months). For further information, please visit <http://co.gloucester.nj.us/322/rt322.cfm>.

##### Agency Response by Gloucester County:

This project has already been constructed for a number of years. The project has improved travel times vastly more than the 2 minutes that Mr. Russell referenced. The project (part of the Mullica Hill By-Pass) was extremely successful and has been awarded the project of the year by DVRPC in 2012.

**DB #: 97112B: Route 322, Kings Highway (CR 551)**

Item ID: 028

##### Agency Response by NJDOT:

The project is currently in the final months of Preliminary Engineering and Final Design will be initiated by the end of the year (2015). Final Design will take approximately one year to complete, therefore the project can be advertised and awarded for Construction in the Spring of 2017.

**DB #: D1203: Gloucester County Multi-Purpose Trail Extension - Glassboro Elk Trail**

# Summary of Agency Responses on the DVRPC Draft FY2016-2019 Transportation Improvement Program (TIP) for New Jersey

## Responses Received for Comments from the General Public

**Item ID:** 029, 030

**Agency Response by DVRPC:**

Your suggestion has been included on the table of Recommended Changes for the final TIP document.

**Agency Response by Gloucester County:**

Thank you for your support.

**Item ID:** 031

**Agency Response by DVRPC:**

The TIP is a four-year program that is updated every two years and represents the best estimate of the projects' costs and schedules. It is not uncommon for a project to appear in more than one TIP, e.g. the FY2012 TIP, FY2014 TIP, and FY2016 TIP since each TIP is for a four year period, and two of the years always overlap. It frequently takes several years and possibly multiple TIP Updates for a project to move through all of its phases. As a result, phases frequently get carried over to the next program update. The TIP is a reimbursement program. Funds do not get distributed just because a phase is listed sometime in the four(4) years—the phase must be at least close to beginning—what we call “federally authorized” or “state encumbered” before it would no longer show in a program. This particular project appears to progress quite on schedule, and the \$2 million construction authorization will be obtained FY16, the same as was identified in the FY2012 program. This project first appeared in the FY2012 TIP for final design in FY13, and right-of-way and construction were programmed in FY16. In the current FY2014 TIP, right-of-way is expected to be “state encumbered” this federal fiscal year 2015 (FY15), and construction still shows in FY16. And finally, there is still expectation in the new FY2016 TIP that construction authorization will be obtained in FY16. Please note that a project that is on the TIP must follow the NJDOT project delivery process from preliminary engineering to final design and if necessary, right-of-way acquisition, to construction. This process is often complex and resource intensive in a resource limited world, which not surprisingly can often take more than a year for a project to be officially completed.

In regards to Gloucester County's “share of funds to improve running/bicycling infrastructure,” the region has scarce resources to address the many needs of the existing transportation system, and the region's main priority is to maintain and bring our transportation facilities into a state-of-good repair, extend the useful life of a facility, or remove a functionally obsolete bridge rating, followed by improving safety and reducing congestion (see DVRPC's TIP Benefit Criteria). For this reason, the Draft FY2016 NJ TIP primarily contains more roadway and bridge repair/rehabilitation projects than bicycle/pedestrian/streetscape improvement projects. This does not, however, indicate that roadway and bridge repair/rehabilitation projects exclude bicycling/pedestrian accommodations. Note that in addition to our regional highway and transit programs, our region continues to benefit from additional NJDOT statewide ADA, bicycle and pedestrian improvements/accommodations, recreational trails, Park and Ride/TDM, Safe Routes to School and Transit, Transit Village, and Transportation Alternatives projects over the next four years (FY16 to FY19). See Table 7 in the FY2016 NJ TIP that shows a list of various bicycle/pedestrian/streetscape projects in Gloucester County that are funded by the Transportation Alternatives Program (TAP) from 2000 to 2014.

**Agency Response by Gloucester County:**

The project is on schedule with ROW authorization this year with construction authorization for the following year. Given the schedule for release of funds through NJDOT and approval process to allow the bidding process to proceed, actual construction approval lags one year behind the authorization approval.

**Item ID:** 032

**Agency Response by Gloucester County:**

Thank you for your support.

## General TIP Comments: General requests, concerns, and/or questions

Friday, September 04, 2015

Page 5 of 13

# Summary of Agency Responses

## on the

### DVRPC Draft FY2016-2019 Transportation Improvement Program (TIP)

### for New Jersey

#### Responses Received for Comments from the General Public

**Item ID:** 033

**Agency Response by NJDOT:**

NJDOT has a Program that addresses Traffic Signal coordination; DBNUM: 15343 / UPC: 153430 Intelligent Traffic Signal Systems.

**Item ID:** 034

**Agency Response by NJDOT:**

NJDOT has dedicated Management Systems which continuously address issues related to congestion and safety on the state's highways. NJDOT has a Program that addresses issues related to scenery on the state's highways; DBNUM: X200C New Jersey Scenic Byways Program.

#### General TIP Comments: Requests for a new TIP project/line item

**Item ID:** 035

**Agency Response by NJDOT:**

NJDOT has a Program that addresses Intersection issues; DBNUM: 98333 Intersection Improvement Program (Project Implementation). NJDOT also has a Program that addresses Traffic Signal Issues; DBNUM: X47 Traffic Signal Replacement.

#### Mercer County

**DB #: 551B: Route 29, Delaware River Pedestrian/Bike Path, Stacy Park to Assunpink Creek**

**Item ID:** 036

**Agency Response by NJDOT:**

The earmark, NJ041 Public Law 105-178, was designated for this and other projects near Route 29. However, it was determined that the estimated right-of-way purchase and construction costs are prohibitive. Therefore, this pedestrian / bike path, was placed "on hold." The remaining earmark funds were expended on three other eligible projects along Route 29. Including nearly \$1.6 million for South of Lalor Street to Cass Street, \$395,000 for Rt. 29 bike path to Stacey Park, and \$2.2 million for Route 29, Landscape Deck Park.

**DB #: 95040: Route 206, Whitehorse Circle (CR 533, 524)**

**Item ID:** 037, 038

**Agency Response by DVRPC:**

Thank you for your comment. It has been forwarded to NJDOT.

**Agency Response by NJDOT:**

Support acknowledged.

**DB #: D0701: Princeton-Hightstown Road Improvements, CR 571**

# Summary of Agency Responses on the DVRPC Draft FY2016-2019 Transportation Improvement Program (TIP) for New Jersey

## Responses Received for Comments from the General Public

Item ID: 039, 040

### Agency Response by Mercer County:

As stated during the FY2012 NJ TIP Update in response to public comments on DB# D0701, "Princeton-Hightstown Road Improvements, CR 571" for the segment between Clarksville and Wallace Roads, comments generally praise the project for adding bicycle and pedestrian amenities in what West Windsor Township desires to be a 'main street', mixed-use district near the Princeton Junction train station. Most commentators urge the project to go further. The pedestrian crossing at Sherbrooke Drive attracted particular concern. Aware of this concern, Mercer County recently conditioned approval of a site plan for Windsor Plaza redevelopment on the installation of rectangular rapid flashing beacons and other pedestrian improvements at this location. These will persist as an existing condition through the federal project. With concurrence from West Windsor, the County will also consider lowering the speed limit to 25 MPH. Other comments, however, urge significant design changes that reduce travel speeds and create refuges for crossing pedestrians.

A project for this section has been on the TIP twice before. After graduating to the TIP in 1993, the West Windsor Township Council reversed its endorsement of a project to add pedestrian amenities and widen the road to 5 lanes. The Council re-iterated its opposition to widening when NJDOT listed a similar project in the 2002 Local Scoping program. Thereafter, West Windsor took the lead and in 2005 both its Planning Board and its Council endorsed a design for a three-lane section, including extensive bicycle and pedestrian amenities, following a thorough alternatives analysis and public outreach process. After very minor changes during Preliminary Design, the current TIP moves the project forward into final design. Significant changes to the design at this point will force the project to be dropped from the TIP and revert back to the alternatives analysis phase. This will delay implementation for years, if not preclude it from ever receiving federal funding.

In the public outreach process leading to the preferred alternative, some citizens voiced concerns similar to those raised today. As a result, the final preferred alternative amalgamated the design with the smallest cartway width (to reduce pedestrian crossing distances) and the design with continuous bikeable shoulders. To go further, as advocated by the West Windsor Bicycle and Pedestrian Alliance, and eliminate auxiliary lanes, reduce turning radii, and introduce other traffic calming elements, conflicts with the imperative that this segment of CR 571 safely move vehicular traffic.

CR 571 is a Principal Arterial (AADT ~20,000) and serves as the only direct link between the NJ Turnpike, Princeton Junction train station, US Route 1, and the Township and Borough of Princeton. Turn volumes are high at signalized intersections, where auxiliary lanes will improve operations and safety. Without auxiliary lanes to enhance the free flow of through traffic—including Bus Rapid Transit vehicles travelling in traffic on this segment—opportunities for regional economic development may be jeopardized. In every project such as this, the final preferred alternative must be a compromise. In this case, regional mobility needs must be accommodated while enhancing safety for all travel modes.

### General TIP Comments: General requests, concerns, and/or questions

Item ID: 041

### Agency Response by NJDOT:

Regarding Route 1: NJDOT has dedicated management systems which continuously address issues related to safety, congestion, drainage, pavement, pedestrian and bridge needs on the state's highways. Regarding Route 206: All projects receiving federal funding are required to evaluate direct, secondary, indirect and cumulative impacts, such as air quality impacts, increased congestion, and impacts to quality of life, in accordance with the National Environmental Policy Act (NEPA). Regarding Route 27: NJDOT's Pedestrian Safety Improvement Program" funds construction of pedestrian safety enhancements at intersections, sidewalk installation, and traffic calming measures; the Bicycle and Pedestrian Facilities program addresses bicycle and pedestrian, transit and ADA travel needs through the development of improvements on state, county and local systems. NJDOT staff will work with DVRPC to investigate the best approach for addressing pedestrian needs on this roadway.

### Agency Response by Mercer County:

Mercer County concurs with the Princeton Mayor's comments on the draft 2016 TIP. The Alexander Road bridge over Stony Brook is the only facility over which the County has jurisdiction and we have been working directly with Princeton's staff to advance this project.

## Various Counties

DB #: 06327: Local Aid Grant Management System

Friday, September 04, 2015

Page 7 of 13

# Summary of Agency Responses

## on the

### DVRPC Draft FY2016-2019 Transportation Improvement Program (TIP)

### for New Jersey

#### Responses Received for Comments from the General Public

**Item ID:** 042, 043

**Agency Response by DVRPC:**

Thank you for your comment. It has been forwarded to NJDOT.

**Agency Response by NJDOT:**

Support acknowledged.

#### DB #: 06401: Pedestrian Safety Improvement Program

**Item ID:** 044, 045

**Agency Response by DVRPC:**

Thank you for your comment. It has been forwarded to NJDOT.

**Agency Response by NJDOT:**

Support acknowledged.

#### DB #: 06402: Safe Streets to Transit Program

**Item ID:** 046, 047

**Agency Response by DVRPC:**

Thank you for your comment. It has been forwarded to NJDOT.

**Agency Response by NJDOT:**

This program provides funds to counties and municipalities to improve the overall safety and accessibility for mass transit riders walking to transit facilities, encourage mass transit users to walk to transit station, and facilitate the implementation of projects and activities that will improve safety in the vicinity of transit facilities.

- The Division of Local Aid and Economic administers three programs that promotes bicycling as an alternate mode of transportation in New Jersey.

- The Municipal Aid program has a Bikeway category open to all municipalities. Eligible Local Public Agencies can apply during the defined application period. Consideration is given to projects that make improvements to roadways for bike/car sharing, increasing lane/shoulder widths to accommodate bicycling and construction of bike facilities separated from the roadway. This program is open to all municipalities.

- The Bikeway program is open to all municipalities and counties. Eligible Local Public Agencies can apply during the defined application period. Consideration is given projects that add new Bike facilities where there is none and provide connectivity to existing facilities.

- The Transit Village(TV) program is open to all designated TV municipalities. Eligible Local Public Agencies can apply during the defined application period. Consideration is given to projects that provided dedicated bicycle access to Transit or within a Transit Village. Examples of acceptable types of improvements would include bike paths, bike lanes, bike racks or lockers and bicycle safe grates. In FY 2016, over \$200 million in TTF funds to Counties and Municipalities through our various grant programs.

#### DB #: 06403: Pedestrian Safety Improvement Design and Construction

**Item ID:** 048, 049

**Agency Response by DVRPC:**

Thank you for your comment. It has been forwarded to NJDOT.

**Agency Response by NJDOT:**

Support acknowledged.

#### DB #: 09388: Highway Safety Improvement Program Planning

**Item ID:** 050, 051

**Agency Response by NJDOT:**

New Jersey has a separate Bicycle and Pedestrian Safety Improvement Program where the amount is dedicated specifically for Pedestrian and Bicycle Safety related projects.

#### DB #: 10347: Local Aid Consultant Services

# Summary of Agency Responses on the DVRPC Draft FY2016-2019 Transportation Improvement Program (TIP) for New Jersey

## Responses Received for Comments from the General Public

**Item ID:** 052, 053

**Agency Response by DVRPC:**

Thank you for your comment. It has been forwarded to NJDOT.

**Agency Response by NJDOT:**

Support acknowledged.

**DB #: 99409: Recreational Trails Program**

**Item ID:** 054, 055

**Agency Response by DVRPC:**

Thank you for your comment. It has been forwarded to NJDOT.

**Agency Response by NJDOT:**

Support acknowledged.

**DB #: D0204: Transportation and Community Development Initiative (TCDI) DVRPC**

**Item ID:** 056, 057

**Agency Response by DVRPC:**

Thank you for your support.

**DB #: X03E: Resurfacing Program**

**Item ID:** 058, 059

**Agency Response by DVRPC:**

Thank you for your comment. It has been forwarded to NJDOT.

**Agency Response by NJDOT:**

The State-funded resurfacing program is designed to preserve the highway infrastructure, extend the life of the pavement, and provide smooth riding surfaces. There are various programs and projects to implement complete streets, including bike lanes.

**DB #: X065: Local CMAQ Initiatives**

**Item ID:** 060, 061

**Agency Response by DVRPC:**

Thank you for your support.

**Agency Response by NJDOT:**

Support acknowledged.

**DB #: X107: Transportation Alternatives Program**

**Item ID:** 062, 063

**Agency Response by DVRPC:**

Thank you for your comment. It has been forwarded to NJDOT.

**Agency Response by NJDOT:**

Support acknowledged.

**DB #: X140: Planning and Research, State**

**Item ID:** 064, 065

**Agency Response by NJDOT:**

NJDOT is updating the Statewide Bicycle and Pedestrian Master Plan as part of the Office of Bike / Ped's Federal work program. Expected completion is June 2016.

**DB #: X185: Bicycle & Pedestrian Facilities/Accommodations**

# Summary of Agency Responses

## on the

### DVRPC Draft FY2016-2019 Transportation Improvement Program (TIP)

### for New Jersey

#### Responses Received for Comments from the General Public

**Item ID:** 066, 067

**Agency Response by NJDOT:**

Additional funding and staffing is not necessary.

**DB #: X242: Crash Reduction Program**

**Item ID:** 068, 069

**Agency Response by NJDOT:**

NJDOT has a separate Pedestrian Safety Program which includes Bicycles as well. During design phase, the bicycle compatibility is decided by the Design Services.

**General TIP Comments: Requests for a new TIP project/line item; bicycle/pedestrian improvement requests**

**Item ID:** 070, 071

**Agency Response by DVRPC:**

Thank you for your comment. DVRPC supports the development of a regional multi-use trail system. Improving bicycle and pedestrian facilities is important for those residents that use these modes to meet their daily needs, including travel to jobs and local errands. Creating an interconnected network of multi-use trails provides an alternative to motorized transportation. Improved local, non-motorized mobility promotes economic development and enhances quality of life. DVRPC included the Circuit in Connections 2040: Plan for Greater Philadelphia. This 750-mile interconnected regional multi-use trail network will provide for bicycle and pedestrian access across the region, complementing local investments in bike lanes, sidewalks, and similar infrastructure. Investments have been made in Circuit trails in all four New Jersey counties in DVRPC's service area, and more are identified in New Jersey's FY2016 Transportation Improvement Program. Though a Circuit-specific line item is not included in this TIP, DVRPC will continue to explore options for increasing investment in these important facilities.

**Agency Response by NJDOT:**

NJDOT is updating its Bicycle Compatible Guidelines and it is expected that this update will reference the latest AASHTO information and possible NACTO information.

**General TIP Comments: Say YES to a Circuit Line Item in the NJ TIP**

# Summary of Agency Responses on the DVRPC Draft FY2016-2019 Transportation Improvement Program (TIP) for New Jersey

## Responses Received for Comments from the General Public

**Item ID:** 072, 073, 074, 075, 076, 077, 078, 079, 080, 081, 082, 083, 084, 085, 086, 087, 088, 089, 090, 091, 092, 093, 094, 095, 096, 097, 098, 099, 100, 101, 102, 103, 104, 105, 106, 107, 108, 109, 110, 111, 112, 113, 114, 115, 116, 117, 118, 119, 120, 121, 122,

### Agency Response by DVRPC:

Thank you for your comment. DVRPC supports the development of a regional multi-use trail system. Improving bicycle and pedestrian facilities is important for those residents that use these modes to meet their daily needs, including travel to jobs and local errands. Creating an interconnected network of multi-use trails provides an alternative to motorized transportation. Improved local, non-motorized mobility promotes economic development and enhances quality of life. DVRPC included the Circuit in Connections 2040: Plan for Greater Philadelphia. This 750-mile interconnected regional multi-use trail network will provide for bicycle and pedestrian access across the region, complementing local investments in bike lanes, sidewalks, and similar infrastructure. Investments have been made in Circuit trails in all four New Jersey counties in DVRPC's service area, and more are identified in New Jersey's FY2016 Transportation Improvement Program. Though a Circuit-specific line item is not included in this TIP, DVRPC will continue to explore options for increasing investment in these important facilities.

### Agency Response by Burlington County:

See attached letter for Burlington County's response to comments that request a new line item in the TIP for the construction of Circuit trails in the DVRPC region.

### Agency Response by Camden County:

Camden County supports the development of an inner connected regional trail system and is currently using the TIP programs like Transportation Enhancements to improve trails and bike lanes within the County. Camden County uses local, county and federal resources to support all trail development throughout the County.

### Agency Response by Gloucester County:

Thank you for your support. The County of Gloucester will continue to be an advocate for trail funding within Gloucester County. The County continues to push for funding the Circuit Trail system with the current ROW and Construction funding contained within the TIP for the extension of the Multi-Purpose Trail from its current terminus at Delsea Drive (Route 47) to Rowan University and to the Elk Township Recreational Park (which connects to the Elephant Swamp Trail and Salem County). We are actively looking at funding opportunities for the continuation of the Circuit Trail beyond Rowan University to existing facilities at Chestnut Branch Park and onward to Camden County's Blackwood Trail. Branch trails are also being looked at for funding including connections to Washington Lake Park and James Atkinson Park.

### Agency Response by Mercer County:

Mercer County values the enthusiasm and energy of our local biking and active recreation advocates. We do more by working together. In this spirit, in recent months, County staff have worked with municipal representatives on the Mercer County Bicycle and Pedestrian Task Force, hosted by the Greater Mercer Transportation Management Association, to identify current and future potential multi-purpose trail projects, especially those that tie into larger networks. Projects were prioritized for funding from sources that suited their stage of development, size, complexity, and so on, and County staff continue to advocate for those funds and add projects to the priority list.

Different funding sources have different requirements and federal funds allocated in a TIP line item are the most onerous, for which only large projects executed by local governments are appropriate. State funds, also allocated through the TIP, are a little more flexible. Mercer County actively advocates for local trail projects under existing federal funding programs, including Transportation Alternatives, Congestion Mitigation and Air Quality, Safe Routes To Schools, Safe Routes To Transit, and other State DOT and DEP programs. For specific, construction-ready projects of appropriate size, the County will also support individual TIP actions. If a number of such projects arise in our work with trail partners in years to come, the County will consider advocating for an ongoing TIP line item. The County will also continue to make significant investments in trail, bike, and pedestrian facility development using County Open Space and highway and bridge capital programs.

So, to our partners and enthusiastic advocates, thanks for watching, thanks for pushing, and let's keep pushing in the same direction.

## DRPA/PATCO

**DB #: D0906: Install Elevators, PATCO**

Friday, September 04, 2015

Page 11 of 13



# Summary of Agency Responses

## on the

### DVRPC Draft FY2016-2019 Transportation Improvement Program (TIP)

### for New Jersey

#### Responses Received for Comments from the General Public

**Item ID:** 199

**Agency Response by DRPA/PATCO:**

Thank you for your comment and your support of this project. As stewards of public assets, it is the mission of DRPA/PATCO to provide for the safe and efficient operation of transportation services and facilities in a manner that creates value for the public we serve. We will continue to work to maintain and improve our assets for the benefit of those using our services.

**DB #: DR036: Transit Enhancements**

**Item ID:** 200, 201

**Agency Response by DRPA/PATCO:**

Thank you for your comment and your support of this project. As stewards of public assets, it is the mission of DRPA/PATCO to provide for the safe and efficient operation of transportation services and facilities in a manner that creates value for the public we serve. We will continue to work to maintain and improve our assets for the benefit of those using our services.

**DB #: DR046: DRPA - Rebuild PATCO Cars**

**Item ID:** 202, 203

**Agency Response by DRPA/PATCO:**

Thank you for your comment and your support of this project. As stewards of public assets, it is the mission of DRPA/PATCO to provide for the safe and efficient operation of transportation services and facilities in a manner that creates value for the public we serve. We will continue to work to maintain and improve our assets for the benefit of those using our services.

#### NJ TRANSIT

**DB #: T210: Transit Enhancements/Transp Altern Prog (TAP)/Altern Transit Improv (ATI)**

**Item ID:** 204

**Agency Response by NJ TRANSIT:**

Although there are currently two transit expansion studies being undertaken in the region (Route 42/55/676 BRT and the GCL), the current budget makes no provision for transit expansion. There are neither the funds nor the capacity to undertake an additional transit expansion analysis at this time. If it was deemed a regional priority, NJ TRANSIT would be willing to provide technical support, as we are able, to an MPO-led effort to study potential ridership demand for such proposed new BRT services. Any such effort should include an analysis of the costs of providing the service.

**DB #: T300: Transit Rail Initiatives**

**Item ID:** 205

**Agency Response by NJ TRANSIT:**

The Glassboro-Camden Line (GCL) project has advanced to the Environmental Analysis phase. NJ TRANSIT is funding the \$8.1 million environmental study, with the Delaware River Port Authority (DRPA) acting as project manager. The project team, in coordination with the Federal Transit Administration, the federal lead agency, is preparing an Environmental Impact Statement in compliance with federal regulations. Identification of funding for construction of the GCL, and designation of a sponsoring agency, remain outstanding issues relating to this project.

**DB #: T44: NEC Improvements**

**Item ID:** 206

**Agency Response by NJ TRANSIT:**

NJ TRANSIT partnered with Amtrak, and performed environmental work, for improvements that will allow trains to travel faster on the Northeast Corridor (NEC) between Trenton and New Brunswick. The purpose of this work was to develop a draft signal block layout plan as Amtrak embarked on their High Speed Rail funded upgrade of the Northeast Corridor. The goal was to ensure that NJ TRANSIT's capacity needs on the NEC are met in concert with Amtrak achieving the higher speeds required in the High Speed Rail project.

NJ TRANSIT remains engaged with Amtrak on all matters relating to the NEC in New Jersey, including capital improvements, future plans, and implementation of higher speed services, including understanding the impacts of higher speed Amtrak services upon NJ TRANSIT's train operations.

Friday, September 04, 2015

Page 12 of 13

# Summary of Agency Responses on the DVRPC Draft FY2016-2019 Transportation Improvement Program (TIP) for New Jersey

## Responses Received for Comments from the General Public

DB #: T88: Study and Development

Item ID: 207

### Agency Response by NJ TRANSIT:

NJ TRANSIT has been engaged with local partners interested in the redevelopment of downtown Camden, including discussions about potential redevelopment projects, the impacts on the local transportation system, and potential transit improvements supportive of redevelopment efforts, including the primary transit facility serving downtown Camden – the Walter Rand Transportation center. These discussions continue.

# Board of Chosen Freeholders County of Burlington

P.O. BOX 6000

MOUNT HOLLY, NEW JERSEY

08060-6000



**Office of:**

**COUNTY FREEHOLDERS**

Mary Ann C. O'Brien, *Director*

Aimee R. Belgard

Joseph B. Donnelly

Bruce D. Garganio

Joanne Schwartz

EVE A. CULLINAN

*County Administrator*

Gina M. Wheatley

*Clerk of the Board*

Phone: (609) 265-5020

Fax: (609) 702-7000

Kwan P. Hui

Transportation Planner

Office of Capital Programs, DVRPC

190 N. Independence Mall West, 8th Floor

Philadelphia, PA 19106

RE: Burlington County Response to Public Comments,  
Draft FY2016 Transportation Improvement Program (TIP) for New Jersey,  
'Completing the Circuit'

Dear Kwan:

On behalf of the Burlington County Board of Chosen Freeholders, I want to thank the public for their comments on the Draft 2016 Transportation Improvement Program for New Jersey and reiterate Burlington County's commitment to construct regional trails.

At the June 24, 2015 public meeting, the Burlington County Freeholder Board voted to restore the 2015 Open Space, Recreation, and Farmland and Historic Preservation Trust Fund back to the voter approved rate of four cents. This tax serves as the County's dedicated park and trail funding source.

Many of the speakers at the public hearing vocalized their interest in developing the County's regional trail network. Building these trail connections remains a County priority. We're working with other governmental agencies and non-profit organizations in the greater Philadelphia region to complete the Circuit, a multi-use trail network in Pennsylvania and New Jersey (see [www.ConnectTheCircuit.org](http://www.ConnectTheCircuit.org)).

Burlington County's adopted Parks and Open Space Master Plan lays out our goal to interconnect our parks with over 80 miles of land and water based trails, including the Rancocas Creek Greenway, the Delaware River Heritage Trail and the Kinkora Trail.

Developing this trail network is extremely important for the following reasons:

**Health/Wellness.** The obesity epidemic in our nation must be addressed. With schools reducing gym classes and our population aging, it is critical that we provide daily, convenient exercise opportunities for everyone.

**Economic Development.** It's good business for the local economy to draw visitors to our area to spend dollars at our Main Street cafes, bike shops and other service providers.

**Transportation.** We want to increase transportation options for our residents by connecting trails to public transit, including the RiverLine light rail system.

**Safety.** Families need to have safe access to hiking and biking. Roads like US Route 130 are extremely dangerous to pedestrians. Staff is working to provide safe crossings of these roads and dedicated off-road opportunities to improve safety.

The Freeholder Board has committed millions of dollars to acquire the 'connective tissue' for these trails. We are committing more resources to build them. To leverage our dollars, staff has been directed to apply for available grants, such as Federal TIGER, Transportation Alternatives Program and DVRPC Regional Trails Program funds.

As a result, trail planning and construction projects are coming on-line, such as the recently completed 2.8 mile segment of the Delaware River Heritage Trail and the soon to be constructed 3 mile Kinkora Trail section connecting Mansfield Township Community Park to Springfield Township's Memorial Park. Burlington County is not slowing down our regional trail efforts. We're pedaling harder than ever to connect the Circuit!

Sincerely,



Joseph B. Donnelly  
Freeholder

Cc: Mary Pat Robbie, Director, Resource Conservation  
Eric Arpert, Public Information Officer  
Carol A. Thomas, Principal Planner, Transportation  
Matthew J. Johnson, Coordinator, Open Space Acquisition and Development



**Original Public Comments**  
***on the DRAFT DVRPC FY2016-2019***  
***TIP for New Jersey***

---

THIS SECTION INCLUDES ALL COMMENTS THAT  
DVRPC RECEIVED DURING THE  
PUBLIC COMMENT PERIOD.



# PUBLIC COMMENT FORM

## DRAFT FY2016 FOR NEW JERSEY



Item ID# 156

**Name:** Michael Cannon

**County:** Various Counties

**Project Title:** General Comment

**Comment:**

Dear Camden County Freeholder Cappelli and other DVRPC Board members,

I support the construction of new trails in Camden County and throughout the rest of the region that together will build 750 miles of the Circuit, the region's trail network. I support the dedication of federal transportation funds towards Circuit Trails in Mercer, Burlington, Camden and Gloucester counties. Please consider adding a line item to the FY2016 TIP for Circuit Trails similar to the \$5 million line item that DVRPC recently created in the Pennsylvania TIP. We must start now to build for the FUTURE, whatever it may bring.

Michael Cannon

Laurel Springs, NJ 08021

Comment ID: 49



# PUBLIC COMMENT FORM

## DRAFT FY2016 FOR NEW JERSEY



Item ID# 150

**Name:** Lauren Calise

**County:** Various Counties

**Project Title:** General Comment

**Comment:**

Dear Gloucester County Freeholder Chila and other DVRPC Board members,

I support the construction of new trails in Gloucester County and throughout the rest of the region that together will build 750 miles of the Circuit, the region's trail network. I support the dedication of federal transportation funds towards Circuit Trails in Mercer, Burlington, Camden and Gloucester counties. Please consider adding a line item to the FY2016 TIP for Circuit Trails similar to the \$5 million line item that DVRPC recently created in the Pennsylvania TIP.

Lauren Calise

Mantua, NJ 08051

Comment ID: 50



# PUBLIC COMMENT FORM

## DRAFT FY2016 FOR NEW JERSEY



Item ID# 157

**Name:** Michael Castagner

**County:** Various Counties

**Project Title:** General Comment

**Comment:**

Dear Burlington County Freeholder Garganio and other DVRPC Board members,

I support the construction of new trails in Burlington County and throughout the rest of the region that together will build 750 miles of the Circuit, the region's trail network. I support the dedication of federal transportation funds towards Circuit Trails in Mercer, Burlington, Camden and Gloucester counties. Please consider adding a line item to the FY2016 TIP for Circuit Trails similar to the \$5 million line item that DVRPC recently created in the Pennsylvania TIP.

Michael Castagner

Willingboro, NJ 08046

Comment ID: 51





# PUBLIC COMMENT FORM

## DRAFT FY2016 FOR NEW JERSEY



Item ID# 126

**Name:** Jane Yosko

**County:** Various Counties

**Project Title:** General Comment

**Comment:**

Dear Camden County Freeholder Cappelli and other DVRPC Board members,

I support the construction of new trails in Camden County and throughout the rest of the region that together will build 750 miles of the Circuit, the region's trail network. I support the dedication of federal transportation funds towards Circuit Trails in Mercer, Burlington, Camden and Gloucester counties. Please consider adding a line item to the FY2016 TIP for Circuit Trails similar to the \$5 million line item that DVRPC recently created in the Pennsylvania TIP.

Jane Yosko

Cherry Hill, NJ 08034

Comment ID: 52



# PUBLIC COMMENT FORM

## DRAFT FY2016 FOR NEW JERSEY



Item ID# 121

**Name:** Jacquelyn Pillsbury

**County:** Various Counties

**Project Title:** General Comment

**Comment:**

Dear County Executive Hughes and other DVRPC Board members,

I support the construction of new trails in Mercer County and throughout the rest of the region that together will build 750 miles of the Circuit, the region's trail network. I support the dedication of federal transportation funds towards Circuit Trails in Mercer, Burlington, Camden and Gloucester counties. Please consider adding a line item to the FY2016 TIP for Circuit Trails similar to the \$5 million line item that DVRPC recently created in the Pennsylvania TIP.

Jacquelyn Pillsbury

Lawrenceville, NJ 08648

Comment ID: 53



# PUBLIC COMMENT FORM

## DRAFT FY2016 FOR NEW JERSEY



Item ID# 173

**Name:** Renee Meland

**County:** Various Counties

**Project Title:** General Comment

**Comment:**

Dear Burlington County Freeholder Garganio and other DVRPC Board members,

I support the construction of new trails in Burlington County and throughout the rest of the region that together will build 750 miles of the Circuit, the region's trail network. I support the dedication of federal transportation funds towards Circuit Trails in Mercer, Burlington, Camden and Gloucester counties. Please consider adding a line item to the FY2016 TIP for Circuit Trails similar to the \$5 million line item that DVRPC recently created in the Pennsylvania TIP.

Renee Meland

Marlton, NJ 08053

Comment ID: 54



# PUBLIC COMMENT FORM

## DRAFT FY2016 FOR NEW JERSEY



Item ID# 187

**Name:** Silvia Ascarelli

**County:** Various Counties

**Project Title:** General Comment

**Comment:**

Dear County Executive Hughes and other DVRPC Board members,

I support the construction of new trails in Mercer County and throughout the rest of the region that together will build 750 miles of the Circuit, the region's trail network. I support the dedication of federal transportation funds towards Circuit Trails in Mercer, Burlington, Camden and Gloucester counties. Please consider adding a line item to the FY2016 TIP for Circuit Trails similar to the \$5 million line item that DVRPC recently created in the Pennsylvania TIP.

Did you see the recent survey that shows a majority of Mercer County residents favor paying just \$2 more per year per person for trails? That's a start!

Trails plus protected bike lanes and sidewalks give people choices in how they get around - whether to run an errand, get to school or get to work - or just go get some fresh air. Not only do they help us be healthy (and reduce stress) but they are far, far cheaper than widening a roadway.

Please support trails by adding a line item for funding the Circuit - for the health of Mercer County.

Silvia Ascarelli

Princeton Junction, NJ 08550

Comment ID: 55



# PUBLIC COMMENT FORM

## DRAFT FY2016 FOR NEW JERSEY



Item ID# 135

**Name:** John Mcdaniel

**County:** Various Counties

**Project Title:** General Comment

**Comment:**

Dear County Executive Hughes and other DVRPC Board members,

I support the construction of new trails in Mercer County and throughout the rest of the region that together will build 750 miles of the Circuit, the region's trail network. I support the dedication of federal transportation funds towards Circuit Trails in Mercer, Burlington, Camden and Gloucester counties. Please consider adding a line item to the FY2016 TIP for Circuit Trails similar to the \$5 million line item that DVRPC recently created in the Pennsylvania TIP.

John Mcdaniel

Lawrenceville, NJ 08648

Comment ID: 56



# PUBLIC COMMENT FORM

## DRAFT FY2016 FOR NEW JERSEY



Item ID#

**Name:** Richard Titley

**County:** Various Counties

**Project Title:** General Comment

**Comment:**

Dear Gloucester County Freeholder Chila and other DVRPC Board members,

I support the construction of new trails in Gloucester County and throughout the rest of the region that together will build 750 miles of the Circuit, the region's trail network. I support the dedication of federal transportation funds towards Circuit Trails in Mercer, Burlington, Camden and Gloucester counties. Please consider adding a line item to the FY2016 TIP for Circuit Trails similar to the \$5 million line item that DVRPC recently created in the Pennsylvania TIP.

Richard Titley

Pitman, NJ 08071

Comment ID: 57



# PUBLIC COMMENT FORM

## DRAFT FY2016 FOR NEW JERSEY



Item ID# 032

**Name:** Silvia Ascarelli

**County:** Gloucester County

**Project Title:** Gloucester County Multi-Purpose Trail Extension - Glassboro Elk Trail

**DB#:** D1203

**Comment:**

Excellent! Extending and linking trails and destinations makes a trail much more useful.

Comment ID: 17



# PUBLIC COMMENT FORM

## DRAFT FY2016 FOR NEW JERSEY



Item ID# 207

**Name:** Joseph Russell

**County:** NJ TRANSIT

**Project Title:** Study and Development

**DB#:** T88

**Comment:**

I would love to see funds go toward studying improving or overhauling the Walter Rand Transportation Center on Broadway in Camden. Currently it does not service as many busses as arrive at the station, and it will have to be expanded when the Camden-Glassboro line gets built.

Comment ID: 22





# PUBLIC COMMENT FORM

## DRAFT FY2016 FOR NEW JERSEY



Item ID# 115

**Name:** Frank Wolf

**County:** Various Counties

**Project Title:** General Comment

**Comment:**

Dear Camden County Freeholder Cappelli and other DVRPC Board members,

I support the construction of new trails in Camden County and throughout the rest of the region that together will build 750 miles of the Circuit, the region's trail network. I support the dedication of federal transportation funds towards Circuit Trails in Mercer, Burlington, Camden and Gloucester counties. Please consider adding a line item to the FY2016 TIP for Circuit Trails similar to the \$5 million line item that DVRPC recently created in the Pennsylvania TIP.

Frank Wolf

Pennsauken, NJ 08110

Comment ID: 29



# PUBLIC COMMENT FORM

## DRAFT FY2016 FOR NEW JERSEY



Item ID# 107

**Name:** Donald Pillsbury

**County:** Various Counties

**Project Title:** General Comment

**Comment:**

Dear County Executive Hughes and other DVRPC Board members,

I support the construction of new trails in Mercer County and throughout the rest of the region that together will build 750 miles of the Circuit, the region's trail network. I support the dedication of federal transportation funds towards Circuit Trails in Mercer, Burlington, Camden and Gloucester counties. Please consider adding a line item to the FY2016 TIP for Circuit Trails similar to the \$5 million line item that DVRPC recently created in the Pennsylvania TIP.

Donald Pillsbury

Lawrenceville, NJ 08648

Comment ID: 30



# PUBLIC COMMENT FORM

## DRAFT FY2016 FOR NEW JERSEY



Item ID# 122

**Name:** Jaime Phillips

**County:** Various Counties

**Project Title:** General Comment

**Comment:**

Dear Camden County Freeholder Cappelli and other DVRPC Board members,

I support the construction of new trails in Camden County and throughout the rest of the region that together will build 750 miles of the Circuit, the region's trail network. I support the dedication of federal transportation funds towards Circuit Trails in Mercer, Burlington, Camden and Gloucester counties. Please consider adding a line item to the FY2016 TIP for Circuit Trails similar to the \$5 million line item that DVRPC recently created in the Pennsylvania TIP.

I support creating bike trails because while living in Copenhagen, Denmark, I was able to bike everywhere with great safety and speed. Often, it was even the fastest way to get around. This option created choice in residents' lifestyles, which is something that I see as paramount to livability and personal freedom in the United States. These trails provide a viable choice to bike, which supports health and can reduce transportation costs for some families.

Again, please consider adding a line item to the FY2016 TIP for Circuit Trails similar to the \$5 million line item that DVRPC recently created in the Pennsylvania TIP. Support livability in South Jersey and the Greater Philadelphia Region!

Jaime Phillips

Cherry Hill, NJ 08003

Comment ID: 31



# PUBLIC COMMENT FORM

## DRAFT FY2016 FOR NEW JERSEY



Item ID# 101

**Name:** David Hulnick

**County:** Various Counties

**Project Title:** General Comment

**Comment:**

Dear Camden County Freeholder Cappelli and other DVRPC Board members,

I support the construction of new trails in Camden County and throughout the rest of the region that together will build 750 miles of the Circuit, the region's trail network. I support the dedication of federal transportation funds towards Circuit Trails in Mercer, Burlington, Camden and Gloucester counties. Please consider adding a line item to the FY2016 TIP for Circuit Trails similar to the \$5 million line item that DVRPC recently created in the Pennsylvania TIP.

David Hulnick

Cherry Hill, NJ 08003

Comment ID: 32



# PUBLIC COMMENT FORM

## DRAFT FY2016 FOR NEW JERSEY



Item ID# 118

**Name:** Henry Jansma

**County:** Various Counties

**Project Title:** General Comment

**Comment:**

Dear Camden County Freeholder Cappelli and other DVRPC Board members,

I support the construction of new trails in Camden County and throughout the rest of the region that together will build 750 miles of the Circuit, the region's trail network. I support the dedication of federal transportation funds towards Circuit Trails in Mercer, Burlington, Camden and Gloucester counties. Please consider adding a line item to the FY2016 TIP for Circuit Trails similar to the \$5 million line item that DVRPC recently created in the Pennsylvania TIP.

Thank you for your service to our County.

Sincerely,

Henry Jansma

Mt. Ephraim, NJ 08059

Comment ID: 33



# PUBLIC COMMENT FORM

## DRAFT FY2016 FOR NEW JERSEY



Item ID# 166

**Name:** Patrice Leonetti

**County:** Various Counties

**Project Title:** General Comment

**Comment:**

Dear Camden County Freeholder Cappelli and other DVRPC Board members,

I support the construction of new trails in Camden County and throughout the rest of the region that together will build 750 miles of the Circuit, the region's trail network. I support the dedication of federal transportation funds towards Circuit Trails in Mercer, Burlington, Camden and Gloucester counties. Please consider adding a line item to the FY2016 TIP for Circuit Trails similar to the \$5 million line item that DVRPC recently created in the Pennsylvania TIP.

Patrice Leonetti

Haddon Heights, NJ 08035

Comment ID: 34



# PUBLIC COMMENT FORM

## DRAFT FY2016 FOR NEW JERSEY



Item ID# 196

**Name:** Tom Hammell

**County:** Various Counties

**Project Title:** General Comment

**Comment:**

Dear County Executive Hughes and other DVRPC Board members,

I support the construction of new trails in Mercer County and throughout the rest of the region that together will build 750 miles of the Circuit, the region's trail network. I support the dedication of federal transportation funds towards Circuit Trails in Mercer, Burlington, Camden and Gloucester counties. Please consider adding a line item to the FY2016 TIP for Circuit Trails similar to the \$5 million line item that DVRPC recently created in the Pennsylvania TIP.

Tom Hammell

East Windsor, NJ 08520

Comment ID: 35



# PUBLIC COMMENT FORM

## DRAFT FY2016 FOR NEW JERSEY



Item ID# 081

**Name:** Brenda Englehart

**County:** Various Counties

**Project Title:** General Comment

**Comment:**

Dear Gloucester County Freeholder Chila and other DVRPC Board members,

I support the construction of new trails in Gloucester County and throughout the rest of the region that together will build 750 miles of the Circuit, the region's trail network. I support the dedication of federal transportation funds towards Circuit Trails in Mercer, Burlington, Camden and Gloucester counties. Please consider adding a line item to the FY2016 TIP for Circuit Trails similar to the \$5 million line item that DVRPC recently created in the Pennsylvania TIP.

Brenda Englehart

Sewell, NJ 08080

Comment ID: 36





# PUBLIC COMMENT FORM

## DRAFT FY2016 FOR NEW JERSEY



Item ID# 198

**Name:** William Hunt

**County:** Various Counties

**Project Title:** General Comment

**Comment:**

Dear Burlington County Freeholder Garganio and other DVRPC Board members,

I support the construction of new trails in Burlington County and throughout the rest of the region that together will build 750 miles of the Circuit, the region's trail network. I support the dedication of federal transportation funds towards Circuit Trails in Mercer, Burlington, Camden and Gloucester counties. Please consider adding a line item to the FY2016 TIP for Circuit Trails similar to the \$5 million line item that DVRPC recently created in the Pennsylvania TIP.

william hunt

Edgewater Park, NJ 08010

Comment ID: 37



# PUBLIC COMMENT FORM

## DRAFT FY2016 FOR NEW JERSEY



Item ID# 022

**Name:** Joseph Russell

**County:** Camden County

**Project Title:** General Comment

**Comment:**

Hello,

I'd like to comment on the Route 30 resurfacing from Camden to Haddon Heights. As part of this resurfacing, I would like to see a bike lane striped on the stretch of Route 30 from the old Collingswood circle at Route 130 to the easternmost part of this project on Route 30. South Jersey has shown its willingness to accommodate non-car road users, shown by the adoption on the part of both Camden County and NJDOT of Complete Streets policies. And as a resident of Collingswood who bikes around very frequently, I know that it would be used by people who get around this dense collection of towns by bike.

Comment ID: 13



# PUBLIC COMMENT FORM

## DRAFT FY2016 FOR NEW JERSEY



Item ID# 017

**Name:** Christopher Wawak

**County:** Camden County

**Project Title:** Route 30, Cooper Street to Grove Street

**DB#:** 15375

**Comment:**

Please include bike improvements like protected bike lanes as part of this project.

Comment ID: 14



# PUBLIC COMMENT FORM

## DRAFT FY2016 FOR NEW JERSEY



Item ID# 206

**Name:** Joseph Russell

**County:** NJ TRANSIT

**Project Title:** NEC Improvements

**DB#:** T44

**Comment:**

NEC improvements are vital to New Jersey. Improving the tracks to allow Amtrak and NJ Transit trains to hit high speeds, such as by straightening them out, would be a boon to the region.

Comment ID: 23



# PUBLIC COMMENT FORM

## DRAFT FY2016 FOR NEW JERSEY



Item ID# 204

**Name:** Joseph Russell

**County:** NJ TRANSIT

**Project Title:** Transit Enhancements/Transp Altern Prog (TAP)/Altern Transit Improv (ATI)

**DB#:** T210

**Comment:**

I would love to see a Bus Rapid Transit study done for the Routes 70 and 38 corridor. Currently, these routes lack timely, reliable transit, and are often congested with cars during rush hour. Given that a train line along these routes is unavailable, and that NJ Transit busses along the line are much slower than driving and more expensive than PATCO, if that is an option for people, BRT along these routes may be beneficial to the region.

Comment ID: 24



# PUBLIC COMMENT FORM

## DRAFT FY2016 FOR NEW JERSEY



Item ID# 154

**Name:** Marc Silver

**County:** Various Counties

**Project Title:** General Comment

**Comment:**

Dear Camden County Freeholder Cappelli and other DVRPC Board members,

I support the construction of new trails in Camden County and throughout the rest of the region that together will build 750 miles of the Circuit, the region's trail network. I support the dedication of federal transportation funds towards Circuit Trails in Mercer, Burlington, Camden and Gloucester counties. Please consider adding a line item to the FY2016 TIP for Circuit Trails similar to the \$5 million line item that DVRPC recently created in the Pennsylvania TIP.

Thanks very much for considering!

Marc Silver

Cherry Hill, NJ 08003

Comment ID: 38



# PUBLIC COMMENT FORM

## DRAFT FY2016 FOR NEW JERSEY



Item ID# 102

**Name:** David Steinberg

**County:** Various Counties

**Project Title:** General Comment

**Comment:**

Dear Camden County Freeholder Cappelli and other DVRPC Board members,

I support the construction of new trails in Camden County and throughout the rest of the region that together will build 750 miles of the Circuit, the region's trail network. I support the dedication of federal transportation funds towards Circuit Trails in Mercer, Burlington, Camden and Gloucester counties. Please consider adding a line item to the FY2016 TIP for Circuit Trails similar to the \$5 million line item that DVRPC recently created in the Pennsylvania TIP.

David Steinberg

Haddon Heights, NJ, 08035

Comment ID: 39



# PUBLIC COMMENT FORM

## DRAFT FY2016 FOR NEW JERSEY



Item ID# 142

**Name:** June Bente

**County:** Various Counties

**Project Title:** General Comment

**Comment:**

Dear County Executive Hughes and other DVRPC Board members,

I support the construction of new trails in Mercer County and throughout the rest of the region that together will build 750 miles of the Circuit, the region's trail network. I support the dedication of federal transportation funds towards Circuit Trails in Mercer, Burlington, Camden and Gloucester counties. Please consider adding a line item to the FY2016 TIP for Circuit Trails similar to the \$5 million line item that DVRPC recently created in the Pennsylvania TIP.

June Bente

Hopewell, NJ 08525

Comment ID: 40





# PUBLIC COMMENT FORM

## DRAFT FY2016 FOR NEW JERSEY



Item ID# 160

**Name:** Mike Murphy

**County:** Various Counties

**Project Title:** General Comment

**Comment:**

Dear Gloucester County Freeholder Chila and other DVRPC Board members,

I support the construction of new trails in Gloucester County and throughout the rest of the region that together will build 750 miles of the Circuit, the region's trail network. I support the dedication of federal transportation funds towards Circuit Trails in Mercer, Burlington, Camden and Gloucester counties. Please consider adding a line item to the FY2016 TIP for Circuit Trails similar to the \$5 million line item that DVRPC recently created in the Pennsylvania TIP.

mike murphy

swedesboro, NJ 08085

Comment ID: 41



# PUBLIC COMMENT FORM

## DRAFT FY2016 FOR NEW JERSEY



Item ID# 171

**Name:** Paul Van Cleve

**County:** Various Counties

**Project Title:** General Comment

**Comment:**

Dear Burlington County Freeholder Garganio and other DVRPC Board members,

I support the construction of new trails in Burlington County and throughout the rest of the region that together will build 750 miles of the Circuit, the region's trail network. I support the dedication of federal transportation funds towards Circuit Trails in Mercer, Burlington, Camden and Gloucester counties. Please consider adding a line item to the FY2016 TIP for Circuit Trails similar to the \$5 million line item that DVRPC recently created in the Pennsylvania TIP.

Paul Van Cleve

Lumberton, NJ 08048

Comment ID: 42



# PUBLIC COMMENT FORM

## DRAFT FY2016 FOR NEW JERSEY



Item ID# 112

**Name:** Eleanor Frank Hunt

**County:** Various Counties

**Project Title:** General Comment

**Comment:**

Dear Burlington County Freeholder Garganio and other DVRPC Board members,

I support the construction of new trails in Burlington County and throughout the rest of the region that together will build 750 miles of the Circuit, the region's trail network. I support the dedication of federal transportation funds towards Circuit Trails in Mercer, Burlington, Camden and Gloucester counties. Please consider adding a line item to the FY2016 TIP for Circuit Trails similar to the \$5 million line item that DVRPC recently created in the Pennsylvania TIP.

Eleanor Frank Hunt

beverly, NJ 08010

Comment ID: 43



# PUBLIC COMMENT FORM

## DRAFT FY2016 FOR NEW JERSEY



Item ID# 138

**Name:** Joseph Brescia

**County:** Various Counties

**Project Title:** General Comment

**Comment:**

Dear Camden County Freeholder Cappelli and other DVRPC Board members,

I support the construction of new trails in Camden County and throughout the rest of the region that together will build 750 miles of the Circuit, the region's trail network. I support the dedication of federal transportation funds towards Circuit Trails in Mercer, Burlington, Camden and Gloucester counties. Please consider adding a line item to the FY2016 TIP for Circuit Trails similar to the \$5 million line item that DVRPC recently created in the Pennsylvania TIP.

Joseph Brescia

Oaklyn, NJ 08107

Comment ID: 44



# PUBLIC COMMENT FORM

## DRAFT FY2016 FOR NEW JERSEY



Item ID# 028

**Name:** Charles Dougherty

**County:** Gloucester County

**Project Title:** Route 322, Kings Highway (CR 551)

**DB#:** 97112B

**Comment:**

This project was entered into the NJDOT pipeline in 1997. That means that it will have taken 20 years to improve one intersection. One can only hope that whatever caused the delays and the resultant inflation of the cost has now been resolved and this highly needed improvement will move forward without further delay.

Comment ID: 12



# PUBLIC COMMENT FORM

## DRAFT FY2016 FOR NEW JERSEY



Item ID# 040

**Name:** Silvia Ascarelli

**County:** Mercer County

**Project Title:** Princeton-Hightstown Road Improvements, CR 571

**DB#:** D0701

**Comment:**

I am happy to see funding for this improvement to CR571. When there was a public comment period in West Windsor several years ago, I was one of several who were concerned about the idea of "bike-compatible shoulders" rather than proper bike lanes. Please install bike lanes, not shoulders. There is a legal and qualitative difference.

I also am concerned about the speed limit. This is supposed to be a downtown and a place where people want to walk and motorists can see the stores and want to pull in. It should not be seen first and foremost as a through road from the train station and Route 1 to points east (and out of town). So please make the speed limit no more than 30 mph (25 would be even better).

Please note there should soon be sidewalks on Cranbury Road. Together, these projects are a bit step in making West Windsor's Main Street more accessible to nearby residents -- and more pleasant.

Thank you.

Silvia Ascarelli

Comment ID: 15



# PUBLIC COMMENT FORM

## DRAFT FY2016 FOR NEW JERSEY



Item ID# 036

**Name:** Silvia Ascarelli

**County:** Mercer County

**Project Title:** Route 29, Delaware River Pedestrian/Bike Path, Stacy Park to Assunpink Creek

**DB#:** 551B

**Comment:**

Excellent!!

Comment ID: 16



# PUBLIC COMMENT FORM

## DRAFT FY2016 FOR NEW JERSEY



Item ID# 002

**Name:** Enthusiastic Supporter

**County:** Burlington County

**Project Title:** Route 130, Columbus Road/Jones Street

**DB#:** 02397

**Comment:**

Commuting both ways on Route 130 every weekday, I welcome every intersection improvement along this corridor. It appears that utility funding is in place for the project as of 6/2014, can that utility work be completed in Fall 2015, which would allow for Spring 2016 resurfacing and intersection improvement?

Also, one minor concern with the proposed signal improvements... Trucks seem to be a high proportion of the NB left turns Route 130 onto Jones, is there sufficient space on Route 130 for trucks waiting to make the left turn? Would the dedicated NB LT lane extend south of the intersection with Columbus?

Comment ID: 18





# PUBLIC COMMENT FORM

## DRAFT FY2016 FOR NEW JERSEY



Item ID# 023

**Name:** Bus Rider

**County:** Camden County

**Project Title:** General Comment

**Comment:**

In the City of Camden, there are two signals along MLK Blvd Westbound which seem to be very dangerous. They are at the entrance to the Walter Rand Bus Terminal and at the intersection with Broadway. Westbound drivers get a green light while cars or buses waiting to turn right have to wait. Those right turns should have their own dedicated turn lane, or else the signals should be coordinated so that the westbound drivers get a green light only when the right turns are also allowed.

Comment ID: 19



# PUBLIC COMMENT FORM

## DRAFT FY2016 FOR NEW JERSEY



Item ID# 205

**Name:** Joseph Russell

**County:** NJ TRANSIT

**Project Title:** Transit Rail Initiatives

**DB#:** T300

**Comment:**

There are two initiatives I would like to see emphasized for South Jersey. One is the Camden-Glassboro light rail project. This is an important connection for a growing Gloucester County that will not only give its residents a reliable rail link to jobs in Camden and Philadelphia, but also improve access to educational institutions in towns along the route.

The second is the improvement of NJ Transit's Atlantic City line. This line could be much more useful to South Jersey if its frequency was increased (as it stands, its schedule is far too sparse to live up to its potential). I would like to see a transfer at the PATCO Woodcrest station, an extension to the Philadelphia airport utilizing current track south of 30th Street Station, and a study into a connection with the Broad Street Line in North Philadelphia. As it stands now, the Atlantic City line is South Jersey's only one-seat ride to West Philadelphia and University City, which is seeing a boom in jobs. Giving South Jerseyans a one-seat ride to these jobs should help to get more people onto transit in our region.

Comment ID: 21



# PUBLIC COMMENT FORM

## DRAFT FY2016 FOR NEW JERSEY



Item ID# 027

**Name:** Joseph Russell

**County:** Gloucester County

**Project Title:** Route 322, Corridor Congestion Relief Project

**DB#:** 07369

**Comment:**

I would like to express concerns about this project. An article in the Gloucester County times reports that this project would reduce waiting "by more than two minutes." That doesn't seem like a significant savings to justify building an entirely new roadway. It also quotes a local resident who says "he believes that Route 322 would soon be faced with the same congestion issues as more drivers are drawn to the new roadway" adding that "eventually, we'll have the same problems."

I strongly believe that merely increasing road capacity or creating new roads will do nothing to mitigate congestion. As we see every time new lane miles are added to are region, congestion just becomes worse. Smarter transportation alternatives should be promoted here instead of simply widening roadways, drawing more cars to the road.

Comment ID: 25



# PUBLIC COMMENT FORM

## DRAFT FY2016 FOR NEW JERSEY



Item ID# 075

**Name:** Ann Gillespie

**County:** Various Counties

**Project Title:** General Comment

**Comment:**

Dear Camden County Freeholder Cappelli and other DVRPC Board members,

I support the construction of new trails in Camden County and throughout the rest of the region that together will build 750 miles of the Circuit, the region's trail network. I support the dedication of federal transportation funds towards Circuit Trails in Mercer, Burlington, Camden and Gloucester counties. Please consider adding a line item to the FY2016 TIP for Circuit Trails similar to the \$5 million line item that DVRPC recently created in the Pennsylvania TIP.

We have some key parts to this transportation system already in place. Connecting the parts makes the whole system much more useful. Use of the trails would blossom if connected.

Ann Gillespie

Audubon, NJ 08106

Comment ID: 26



# PUBLIC COMMENT FORM

## DRAFT FY2016 FOR NEW JERSEY



Item ID# 012

**Name:** John Boyle

**County:** Burlington County

**Project Title:** South Pemberton Road, CR 530, Phase 2

**DB#:** D9912A

**Comment:**

Bicycle Coalition of Greater Philadelphia Comment - We do not support this project as it is designed.

1 - We believe that the 6 foot shoulder should be widened to 8 feet and striped/signed as buffered bike lanes.

2 - Widening the lanes from 10 ft to 12 ft will further encourage speeding which is already an issue.

3 - Curb cuts, crosswalks and ped signals need to be included at the intersection with 38/206. The Wawa built sidewalks without access to the intersection which includes a NJ Transit bus stop.

4 - Crosswalks, pedestrian refuges and rapid flashing beacons are needed for the NJ Transit bus stop at Birmingham Rd.

Comment ID: 28



# PUBLIC COMMENT FORM

## DRAFT FY2016 FOR NEW JERSEY



Item ID# 024

**Name:** Concerned Driver

**County:** Camden County

**Project Title:** General Comment

**Comment:**

Near the Avandale NJ Transit Park and Ride, Sicklerville Road / Williamstown Road is very unfriendly to pedestrians and bicyclists. The speed limit on the road is 45 mph (although vehicles, including trucks, are travelling far faster than the speed limit), yet people continue to walk and bike there all the time, presumably to get to/from the bus stops on the road, to/from the Park and Ride, and to/from residences and businesses along this corridor. This is especially dangerous at night since the road is very dark.

Have either Camden or Gloucester County submitted any proposals to improve the roadway with sidewalks, bike lanes, reduced speed limits, additional lighting, signage, or any other improvements? And if not, what would be the best way to bring this to the County's attention?

Comment ID: 20



# PUBLIC COMMENT FORM

## DRAFT FY2016 FOR NEW JERSEY



Item ID# 039

**Name:** Jerry Foster

**County:** Mercer County

**Project Title:** Princeton-Hightstown Road Improvements, CR 571

**DB#:** D0701

**Comment:**

Please re-design this project to meet the goals of the West Windsor Twp Redevelopment Plan to create a bicycle and pedestrian friendly downtown in West Windsor. The current design, as reviewed by the public in 2009, is not bicycle and pedestrian friendly, despite the project description. For further details, see these recommendations:

<http://wwbpa.org/wp-content/uploads/2010/01/WWBPA-Rt-571-Recommendations-Final.pdf>

Public officials are not aware of the key facts surrounding this project - for example, County Executive Hughes reported in March of 2012 that the road "accommodates an Annual Average Daily Traffic flow of 20,000 vehicles per day" (see: <http://wwbpa.org/wp-content/uploads/2012/03/Hughes-Response-to-TSTC-Mar-1-2012.pdf> ), while NJDOT's Traffic Volume Counts website reports only 14,211 AADT in June of 2012 (see: [http://www.state.nj.us/transportation/refdata/roadway/traffic\\_counts/](http://www.state.nj.us/transportation/refdata/roadway/traffic_counts/) ).

Clearly, a poor design decision will be made if you assume ever-increasing traffic (in 2009 the volume was reported as "about 17,000 vehicles per day" at the public review meeting) that is not realized in actuality.

West Windsor's mayor has indicated willingness to bring the design into alignment with the vision of the redevelopment plan at town hall meetings, but no redesign has been reviewed by the public to date.

Please redesign this project to be bicycle and pedestrian friendly, then fund construction.

Regards,

Jerry Foster

15 Suffolk Lane

West Windsor, NJ 08550

President, West Windsor Bicycle and Pedestrian Alliance

Comment ID: 27





# PUBLIC COMMENT FORM

## DRAFT FY2016 FOR NEW JERSEY



Item ID# 072

**Name:** AJ Ford

**County:** Various Counties

**Project Title:** General Comment

**Comment:**

Dear County Executive Hughes and other DVRPC Board members,

I support the construction of new trails in Mercer County and throughout the rest of the region that together will build 750 miles of the Circuit, the region's trail network. I support the dedication of federal transportation funds towards Circuit Trails in Mercer, Burlington, Camden and Gloucester counties. Please consider adding a line item to the FY2016 TIP for Circuit Trails similar to the \$5 million line item that DVRPC recently created in the Pennsylvania TIP.

Thanks for your help in making this happen!

Respectfully,

AJ Ford

Mercerville, NJ 08619

Comment ID: 45





# PUBLIC COMMENT FORM

## DRAFT FY2016 FOR NEW JERSEY



Item ID# 091

**Name:** Craig Morgan

**County:** Various Counties

**Project Title:** General Comment

**Comment:**

Dear Camden County Freeholder Cappelli and other DVRPC Board members,

I support the construction of new trails in Camden County and throughout the rest of the region that together will build 750 miles of the Circuit, the region's trail network. I support the dedication of federal transportation funds towards Circuit Trails in Mercer, Burlington, Camden and Gloucester counties. Please consider adding a line item to the FY2016 TIP for Circuit Trails similar to the \$5 million line item that DVRPC recently created in the Pennsylvania TIP.

Craig Morgan

Westmont, NJ 0810

Comment ID: 46



# PUBLIC COMMENT FORM

## DRAFT FY2016 FOR NEW JERSEY



Item ID# 144

**Name:** Kaitlyn O'Loughlin

**County:** Various Counties

**Project Title:** General Comment

**Comment:**

Dear Camden County Freeholder Cappelli and other DVRPC Board members,

I support the construction of new trails in Camden County and throughout the rest of the region that together will build 750 miles of the Circuit, the region's trail network. I support the dedication of federal transportation funds towards Circuit Trails in Mercer, Burlington, Camden and Gloucester counties. Please consider adding a line item to the FY2016 TIP for Circuit Trails similar to the \$5 million line item that DVRPC recently created in the Pennsylvania TIP.

We are a biking and public transit family who own a home in Collingswood. The density, walkability, and transit oriented development (both historic and contemporary) of our town and many others like it throughout the county provides us an unparalleled opportunity to connect our communities with bike and pedestrian oriented infrastructure with very little cost, especially when compared to automobile oriented infrastructure. In the coming low-carbon economy bicycles and electric traction public transit will be increasingly important and investing assertively now in trails, segregated lanes, and other bike/ped friendly improvements will allow our communities to get ahead of the curve and not only reduce our climate change impacts but make us more resilient in the face of such change. I am an avid cyclist who despite dozens of collisions with motor vehicles rides daily, but most folk interested in bicycling for exercise, utility, business, and/or pleasure do not feel safe enough on our busy urban streets to bike by themselves, let alone with their children. A few small improvements from restriping to add bike lanes all the way up to building segregated trails/lanes/cycletracks can make the idea of biking palatable enough to folk who otherwise would drive.

We are fortunate to live in a beautiful historic area with relatively flat low lying land with many creeks, streams, and parks. Leveraging these natural endowments with a world class network of bike trails and smart public transit hubs can serve to keep Camden County and her many fine communities relevant in this new century.

Sincerely,

Kait O'Loughlin

Kaitlyn O'Loughlin

Collingswood, NJ 08107

Comment ID: 47



# PUBLIC COMMENT FORM

## DRAFT FY2016 FOR NEW JERSEY



Item ID# 139

**Name:** Joseph Russell

**County:** Various Counties

**Project Title:** General Comment

**Comment:**

Dear DVRPC,

I wanted to send a note of support for the construction of new trails in Camden County and throughout the rest of the region that together will build 750 miles of the Circuit, the region's trail network. I support the dedication of federal transportation funds towards Circuit Trails in Mercer, Burlington, Camden and Gloucester counties. Please consider adding a line item to the FY2016 TIP for Circuit Trails similar to the \$5 million line item that DVRPC recently created in the Pennsylvania TIP.

Thanks for your time!

Joseph Russell

Collingswood, NJ

Comment ID: 48



# PUBLIC COMMENT FORM

## DRAFT FY2016 FOR NEW JERSEY



Item ID# 195

**Name:** Tim Ifill

**County:** Various Counties

**Project Title:** General Comment

**Comment:**

Dear Camden County Freeholder Cappelli and other DVRPC Board members,

I support the construction of new trails in Camden County and throughout the rest of the region that together will build 750 miles of the Circuit, the region's trail network. I support the dedication of federal transportation funds towards Circuit Trails in Mercer, Burlington, Camden and Gloucester counties. Please consider adding a line item to the FY2016 TIP for Circuit Trails similar to the \$5 million line item that DVRPC recently created in the Pennsylvania TIP.

Tim Ifill

Collingswood, NJ 08108

Comment ID: 87



# PUBLIC COMMENT FORM

## DRAFT FY2016 FOR NEW JERSEY



Item ID# 086

**Name:** Cecelia Gaines

**County:** Various Counties

**Project Title:** General Comment

**Comment:**

Dear Burlington County Freeholder Garganio and other DVRPC Board members,

I support the construction of new trails in Burlington County and throughout the rest of the region that together will build 750 miles of the Circuit, the region's trail network. I support the dedication of federal transportation funds towards Circuit Trails in Mercer, Burlington, Camden and Gloucester counties. Please consider adding a line item to the FY2016 TIP for Circuit Trails similar to the \$5 million line item that DVRPC recently created in the Pennsylvania TIP.

Cecelia Gaines

Medford Lakes, NJ 08055

Comment ID: 88



# PUBLIC COMMENT FORM

## DRAFT FY2016 FOR NEW JERSEY



Item ID# 070

**Name:** Cyndi Steiner

**County:** Various Counties

**Project Title:** General Comment

**Comment:**

General Comments:

We support the dedication of federal transportation funds towards Circuit Trails in Mercer, Burlington, Camden and Gloucester counties. We strongly encourage DVRPC to create a line item to the FY2016 TIP for Circuit Trails similar to the \$5 million line item that DVRPC recently created in the Pennsylvania TIP. DVRPC made a commitment in its 2040 Connections Plan to build out the Circuit by 2040. A 2015 telephone public opinion poll found strong public support for building new Circuit Trails in the four New Jersey counties and for dedicating transportation funds toward the construction of new trails in those counties. A new line item with dedicated funding would be an appropriate measure to meet the public's interest in and support for building out the Circuit and to implement DVRPC's Long-Range Plan.

NJDOT, Mercer County and Camden County transportation projects are subject to their respective complete streets policies. But without any way to measure the need or implementation of complete streets it is impossible to know if these policies are having any effect on the road design process and adjacent development.

Bicycle compatibility on State projects often means the inclusion of shoulders. Shoulders are inadequate because they fail to provide safe bicycle movement through intersections. NJDOT's Bicycle Compatibility Guidelines were developed in 1995. We encourage NJDOT to replace the current bicycle compatibility guidelines with recommendations from the 2012 AASHTO Guide for the Development of Bicycle Facilities and the NACTO Urban Bikeway Design Guide.

Further to this comment, the implementation of bike lanes on Rt 35 through Seaside Park show how outdated the NJDOT guidelines are. These bike lanes are placed directly in the door zone, rather than providing a buffer.

Comment ID: 135



# PUBLIC COMMENT FORM

## DRAFT FY2016 FOR NEW JERSEY



Item ID# 029

**Name:** Cyndi Steiner

**County:** Gloucester County

**Project Title:** Gloucester County Multi-Purpose Trail Extension - Glassboro Elk Trail

**DB#:** D1203

**Comment:**

We support this project, the description should note that this part of the Circuit Trail network and therefore relevant to the Long Range Plan.

Comment ID: 136





# PUBLIC COMMENT FORM

## DRAFT FY2016 FOR NEW JERSEY



Item ID# 052

**Name:** Cyndi Steiner

**County:** Various Counties

**Project Title:** Local Aid Consultant Services

**DB#:** 10347

**Comment:**

We strongly support technical assistance to administrators of Local Aid projects. A similar program administered by PENNDOT and DVRPC has proven the value of this

Comment ID: 137





# PUBLIC COMMENT FORM

## DRAFT FY2016 FOR NEW JERSEY



Item ID# 200

**Name:** Cyndi Steiner

**County:** DRPA/PATCO

**Project Title:** Transit Enhancements

**DB#:** DR036

**Comment:**

We thank DRPA/PATCO for the improvement in bike parking infrastructure, including inside paid area bike parking at Center City Stations and surveillance cameras at bike parking facilities throughout the system.

Comment ID: 138



# PUBLIC COMMENT FORM

## DRAFT FY2016 FOR NEW JERSEY



Item ID# 066

**Name:** Cyndi Steiner

**County:** Various Counties

**Project Title:** Bicycle & Pedestrian Facilities/Accommodations

**DB#:** X185

**Comment:**

Please provide provide more funding and adequate staff for this very important line item.

Comment ID: 139



# PUBLIC COMMENT FORM

## DRAFT FY2016 FOR NEW JERSEY



Item ID# 050

**Name:** Cyndi Steiner

**County:** Various Counties

**Project Title:** Highway Safety Improvement Program Planning

**DB#:** 09388

**Comment:**

Please increase the share of this funding to pedestrian and bicycle safety as these modes represent 30% of traffic fatalities in NJ.

Comment ID: 140



# PUBLIC COMMENT FORM

## DRAFT FY2016 FOR NEW JERSEY



Item ID# 058

**Name:** Cyndi Steiner

**County:** Various Counties

**Project Title:** Resurfacing Program

**DB#:** X03E

**Comment:**

The resurfacing program is an excellent opportunity for NJDOT to advance their complete streets implementation by including new bike lanes and higher visibility crosswalks.

Comment ID: 141



# PUBLIC COMMENT FORM

## DRAFT FY2016 FOR NEW JERSEY



Item ID# 068

**Name:** Cyndi Steiner

**County:** Various Counties

**Project Title:** Crash Reduction Program

**DB#:** X242

**Comment:**

Bicycle and Pedestrian should be included in this program. Rumble strip installations should be bicycle compatible as defined by the 2012 AASHTO Guide for the Development of Bicycle Facilities.

Comment ID: 142



# PUBLIC COMMENT FORM

## DRAFT FY2016 FOR NEW JERSEY



Item ID# 064

**Name:** Cyndi Steiner

**County:** Various Counties

**Project Title:** Planning and Research, State

**DB#:** X140

**Comment:**

Funds should be dedicated for updating the Statewide Bicycle and Pedestrian Plan.

Comment ID: 143



# PUBLIC COMMENT FORM

## DRAFT FY2016 FOR NEW JERSEY



Item ID# 046

**Name:** Cyndi Steiner

**County:** Various Counties

**Project Title:** Safe Streets to Transit Program

**DB#:** 06402

**Comment:**

We support this - but the program is underfunded and the scope should be expanded to include safe bicycle access.

Comment ID: 144



# PUBLIC COMMENT FORM

## DRAFT FY2016 FOR NEW JERSEY



Item ID# 004

**Name:** Cyndi Steiner

**County:** Burlington County

**Project Title:** Route 38, South Church Street (CR 607) to Fellowship Road (CR 673), Operational and Safety Improvements

**DB#:** 12307

**Comment:**

This project as presented showed no pedestrian crossing for Route 38.

The Moorestown bicycle plan calls for sharrows on S. Church Rd and for a connecting multi-use trail on the north side of Route 38.

Comment ID: 145





# PUBLIC COMMENT FORM

## DRAFT FY2016 FOR NEW JERSEY



Item ID# 006

**Name:** Cyndi Steiner

**County:** Burlington County

**Project Title:** Route 130/206, CR 528 (Crosswicks Rd) to Rt 206 at Amboy Rd

**DB#:** 12346

**Comment:**

We strongly support these projects and would be interested in providing input.

Comment ID: 146



# PUBLIC COMMENT FORM

## DRAFT FY2016 FOR NEW JERSEY



Item ID# 007

**Name:** Cyndi Steiner

**County:** Burlington County

**Project Title:** Route 130, CR 545 (Farnsworth Avenue)

**DB#:** 12346A

**Comment:**

We strongly support these projects and would be interested in providing input.

Comment ID: 147



# PUBLIC COMMENT FORM

## DRAFT FY2016 FOR NEW JERSEY



Item ID# 001

**Name:** Cyndi Steiner

**County:** Burlington County

**Project Title:** Route 130, Columbus Road/Jones Street

**DB#:** 02397

**Comment:**

We support this project with the inclusion of high visibility continental crosswalk

Comment ID: 149



# PUBLIC COMMENT FORM

## DRAFT FY2016 FOR NEW JERSEY



Item ID# 013

**Name:** Cyndi Steiner

**County:** Camden County

**Project Title:** Route 42, Bridges over Blackwood Railroad Trail

**DB#:** 12313

**Comment:**

We support the inclusion of attractive LED lighting and anti graffiti coating to the underpass.

Comment ID: 150



# PUBLIC COMMENT FORM

## DRAFT FY2016 FOR NEW JERSEY



Item ID# 010

**Name:** Cyndi Steiner

**County:** Burlington County

**Project Title:** Hanover Street Bridge over Rancocas Creek, CR 616

**DB#:** D9902

**Comment:**

Projects we support without additional comment: DB# D9902 D1505 D0902 95040 X065 D0204 06327 06403 06401 99409 X107 DR046

Comment ID: 151



# PUBLIC COMMENT FORM

## DRAFT FY2016 FOR NEW JERSEY



Item ID# 071

**Name:** John Boyle

**County:** Various Counties

**Project Title:** General Comment

**Comment:**

We support the dedication of federal transportation funds towards Circuit Trails in Mercer, Burlington, Camden and Gloucester counties. We strongly encourage DVRPC to create a line item to the FY2016 TIP for Circuit Trails similar to the \$5 million line item that DVRPC recently created in the Pennsylvania TIP. DVRPC made a commitment in its 2040 Connections Plan to build out the Circuit by 2040. A 2015 telephone public opinion poll found strong public support for building new Circuit Trails in the four New Jersey counties and for dedicating transportation funds toward the construction of new trails in those counties. A new line item with dedicated funding would be an appropriate measure to meet the public's interest in and support for building out the Circuit and to implement DVRPC's Long-Range Plan.

NJDOT, Mercer County and Camden County transportation projects are subject to their respective complete streets policies. But without any way to measure the need or implementation of complete streets it is impossible to know if these policies are having any effect on the road design process and adjacent development.

Bicycle compatibility on State projects often means the inclusion of shoulders. Shoulders are inadequate because they fail to provide safe bicycle movement through intersections. NJDOT's Bicycle Compatibility Guidelines were developed in 1995. We encourage NJDOT to replace the current bicycle compatibility guidelines with recommendations from the 2012 AASHTO Guide for the Development of Bicycle Facilities and the NACTO Urban Bikeway Design Guide.

Comment ID: 104



# PUBLIC COMMENT FORM

## DRAFT FY2016 FOR NEW JERSEY



Item ID# 030

**Name:** John Boyle

**County:** Gloucester County

**Project Title:** Gloucester County Multi-Purpose Trail Extension - Glassboro Elk Trail

**DB#:** D1203

**Comment:**

We support this project, the description should note that this part of the Circuit Trail network and therefore relevant to the Long Range Plan.

Comment ID: 105



# PUBLIC COMMENT FORM

## DRAFT FY2016 FOR NEW JERSEY



Item ID# 053

**Name:** John Boyle

**County:** Various Counties

**Project Title:** Local Aid Consultant Services

**DB#:** 10347

**Comment:**

We strongly support technical assistance to administrators of Local Aid projects. A similar program administered by PENNDOT and DVRPC has proven the value of this

Comment ID: 106





# PUBLIC COMMENT FORM

## DRAFT FY2016 FOR NEW JERSEY



Item ID# 201

**Name:** John Boyle

**County:** DRPA/PATCO

**Project Title:** Transit Enhancements

**DB#:** DR036

**Comment:**

We thank DRPA/PATCO for the improvement in bike parking infrastructure, including inside paid area bike parking at Center City Stations and surveillance cameras at bike parking facilities throughout the system.

Comment ID: 107



# PUBLIC COMMENT FORM

## DRAFT FY2016 FOR NEW JERSEY



Item ID# 067

**Name:** John Boyle

**County:** Various Counties

**Project Title:** Bicycle & Pedestrian Facilities/Accommodations

**DB#:** X185

**Comment:**

Please provide provide more funding and adequate staff for this very important line item.

Comment ID: 108



# PUBLIC COMMENT FORM

## DRAFT FY2016 FOR NEW JERSEY



Item ID# 051

**Name:** John Boyle

**County:** Various Counties

**Project Title:** Highway Safety Improvement Program Planning

**DB#:** 09388

**Comment:**

Please increase the share of this funding to pedestrian and bicycle safety as these modes represent 30% of traffic fatalities in NJ.

Comment ID: 109



# PUBLIC COMMENT FORM

## DRAFT FY2016 FOR NEW JERSEY



Item ID# 059

**Name:** John Boyle

**County:** Various Counties

**Project Title:** Resurfacing Program

**DB#:** X03E

**Comment:**

The resurfacing program is an excellent opportunity for NJDOT to advance their complete streets implementation by including new bike lanes and higher visibility crosswalks.

Comment ID: 110



# PUBLIC COMMENT FORM

## DRAFT FY2016 FOR NEW JERSEY



Item ID# 069

**Name:** John Boyle

**County:** Various Counties

**Project Title:** Crash Reduction Program

**DB#:** X242

**Comment:**

Bicycle and Pedestrian should be included in this program. Rumble strip installations should be bicycle compatible as defined by the 2012 AASHTO Guide for the Development of Bicycle Facilities.

Comment ID: 111



# PUBLIC COMMENT FORM

## DRAFT FY2016 FOR NEW JERSEY



Item ID# 065

**Name:** John Boyle

**County:** Various Counties

**Project Title:** Planning and Research, State

**DB#:** X140

**Comment:**

Funds should be dedicated for updating the Statewide Bicycle and Pedestrian Plan.

Comment ID: 112



# PUBLIC COMMENT FORM

## DRAFT FY2016 FOR NEW JERSEY



Item ID# 047

**Name:** John Boyle

**County:** Various Counties

**Project Title:** Safe Streets to Transit Program

**DB#:** 06402

**Comment:**

We support this - but the program is underfunded and the scope should be expanded to include safe bicycle access.

Comment ID: 113



# PUBLIC COMMENT FORM

## DRAFT FY2016 FOR NEW JERSEY



Item ID# 005

**Name:** John Boyle

**County:** Burlington County

**Project Title:** Route 38, South Church Street (CR 607) to Fellowship Road (CR 673), Operational and Safety Improvements

**DB#:** 12307

**Comment:**

This project as presented showed no pedestrian crossing for Route 38.

The Moorestown bicycle plan calls for sharrows on S. Church Rd and for a connecting multi-use trail on the north side of Route 38.

Comment ID: 114





# PUBLIC COMMENT FORM

## DRAFT FY2016 FOR NEW JERSEY



Item ID# 015

**Name:** John Boyle

**County:** Camden County

**Project Title:** Route 130/206, CR 528 (Crosswicks Rd) to Rt 206 at Amboy Rd

**DB#:** 12346

**Comment:**

We strongly support these projects and would be interested in providing input.

Comment ID: 115



# PUBLIC COMMENT FORM

## DRAFT FY2016 FOR NEW JERSEY



Item ID# 016

**Name:** John Boyle

**County:** Camden County

**Project Title:** Route 130, CR 545 (Farnsworth Avenue)

**DB#:** 12346A

**Comment:**

We strongly support these projects and would be interested in providing input.

Comment ID: 116



# PUBLIC COMMENT FORM

## DRAFT FY2016 FOR NEW JERSEY



Item ID# 009

**Name:** John Boyle

**County:** Burlington County

**Project Title:** Route 130, Van Sciver Pkwy to Crafts Creek

**DB#:** 12415

**Comment:**

A safe pedestrian crossing is needed at Van Sciver Parkway to accommodate businesses on both sides of the highway (Willingboro Town Center, Dealerships, Various Small businesses).

Comment ID: 117



# PUBLIC COMMENT FORM

## DRAFT FY2016 FOR NEW JERSEY



Item ID# 003

**Name:** John Boyle

**County:** Burlington County

**Project Title:** Route 130, Columbus Road/Jones Street

**DB#:** 02397

**Comment:**

We support this project with the inclusion of high visibility continental crosswalk

Comment ID: 118



# PUBLIC COMMENT FORM

## DRAFT FY2016 FOR NEW JERSEY



Item ID# 014

**Name:** John Boyle

**County:** Camden County

**Project Title:** Route 42, Bridges over Blackwood Railroad Trail

**DB#:** 12313

**Comment:**

We support the inclusion of attractive LED lighting and anti graffiti coating to the underpass.

Comment ID: 119



# PUBLIC COMMENT FORM

## DRAFT FY2016 FOR NEW JERSEY



Item ID# 011

**Name:** John Boyle

**County:** Burlington County

**Project Title:** Hanover Street Bridge over Rancocas Creek, CR 616

**DB#:** D9902

**Comment:**

Projects we support without additional comment: DB# D9902 D1505 D0902 95040 X065 D0204 06327 06403 06401 99409 X107 DR046

Comment ID: 120



# PUBLIC COMMENT FORM

## DRAFT FY2016 FOR NEW JERSEY



Item ID# 021

**Name:** John Boyle

**County:** Camden County

**Project Title:** ADA Improvements

**DB#:** D1505

**Comment:**

Projects we support without additional comment: DB# D9902 D1505 D0902 95040 X065 D0204 06327 06403 06401 99409 X107 DR046

Comment ID: 121



# PUBLIC COMMENT FORM

## DRAFT FY2016 FOR NEW JERSEY



Item ID# 199

**Name:** Joseph Russell

**County:** DRPA/PATCO

**Project Title:** Install Elevators, PATCO

**DB#:** D0906

**Comment:**

Great project. This will make it easier for those with strollers, bikes, heavy luggage, and the disabled to use PATCO.

Comment ID: 78





# PUBLIC COMMENT FORM

## DRAFT FY2016 FOR NEW JERSEY



Item ID# 019

**Name:** John Boyle

**County:** Camden County

**Project Title:** River Road Improvements, Cramer Hill

**DB#:** D0902

**Comment:**

Projects we support without additional comment: DB# D9902 D1505 D0902 95040 X065 D0204 06327 06403 06401 99409 X107 DR046

Comment ID: 122



# PUBLIC COMMENT FORM

## DRAFT FY2016 FOR NEW JERSEY



Item ID# 038

**Name:** John Boyle

**County:** Mercer County

**Project Title:** Route 206, Whitehorse Circle (CR 533, 524)

**DB#:** 95040

**Comment:**

Projects we support without additional comment: DB# D9902 D1505 D0902 95040 X065 D0204 06327 06403 06401 99409 X107 DR046

Comment ID: 123



# PUBLIC COMMENT FORM

## DRAFT FY2016 FOR NEW JERSEY



Item ID# 061

**Name:** John Boyle

**County:** Various Counties

**Project Title:** Local CMAQ Initiatives

**DB#:** X065

**Comment:**

Projects we support without additional comment: DB# D9902 D1505 D0902 95040 X065 D0204 06327 06403 06401 99409 X107 DR046

Comment ID: 124



# PUBLIC COMMENT FORM

## DRAFT FY2016 FOR NEW JERSEY



Item ID# 057

**Name:** John Boyle

**County:** Various Counties

**Project Title:** Transportation and Community Development Initiative (TCDI) DVRPC

**DB#:** D0204

**Comment:**

Projects we support without additional comment: DB# D9902 D1505 D0902 95040 X065 D0204 06327 06403 06401 99409 X107 DR046

Comment ID: 125



# PUBLIC COMMENT FORM

## DRAFT FY2016 FOR NEW JERSEY



Item ID# 043

**Name:** John Boyle

**County:** Various Counties

**Project Title:** Local Aid Grant Management System

**DB#:** 06327

**Comment:**

Projects we support without additional comment: DB# D9902 D1505 D0902 95040 X065 D0204 06327 06403 06401 99409 X107 DR046

Comment ID: 126



# PUBLIC COMMENT FORM

## DRAFT FY2016 FOR NEW JERSEY



Item ID# 049

**Name:** John Boyle

**County:** Various Counties

**Project Title:** Pedestrian Safety Improvement Design and Construction

**DB#:** 06403

**Comment:**

Projects we support without additional comment: DB# D9902 D1505 D0902 95040 X065 D0204 06327 06403 06401 99409 X107 DR046

Comment ID: 127



# PUBLIC COMMENT FORM

## DRAFT FY2016 FOR NEW JERSEY



Item ID# 045

**Name:** John Boyle

**County:** Various Counties

**Project Title:** Pedestrian Safety Improvement Program

**DB#:** 06401

**Comment:**

Projects we support without additional comment: DB# D9902 D1505 D0902 95040 X065 D0204 06327 06403 06401 99409 X107 DR046

Comment ID: 128



# PUBLIC COMMENT FORM

## DRAFT FY2016 FOR NEW JERSEY



Item ID# 055

**Name:** John Boyle

**County:** Various Counties

**Project Title:** Recreational Trails Program

**DB#:** 99409

**Comment:**

Projects we support without additional comment: DB# D9902 D1505 D0902 95040 X065 D0204 06327 06403 06401 99409 X107 DR046

Comment ID: 129





# PUBLIC COMMENT FORM

## DRAFT FY2016 FOR NEW JERSEY



Item ID# 063

**Name:** John Boyle

**County:** Various Counties

**Project Title:** Transportation Alternatives Program

**DB#:** X107

**Comment:**

Projects we support without additional comment: DB# D9902 D1505 D0902 95040 X065 D0204 06327 06403 06401 99409 X107 DR046

Comment ID: 130



# PUBLIC COMMENT FORM

## DRAFT FY2016 FOR NEW JERSEY



Item ID# 203

**Name:** John Boyle

**County:** DRPA/PATCO

**Project Title:** DRPA - Rebuild PATCO Cars

**DB#:** DR046

**Comment:**

Projects we support without additional comment: DB# D9902 D1505 D0902 95040 X065 D0204 06327 06403 06401 99409 X107 DR046

Comment ID: 131



# PUBLIC COMMENT FORM

## DRAFT FY2016 FOR NEW JERSEY



**Name:** Jeff Taylor

**County:** Gloucester County

**Project Title:** General Comment

**Comment:**

August 10, 2015

This letter regards traffic lights: Sensors and coordination of lights

New Jersey Department of Transportation and many county transportation departments have transitioned their traffic signal traffic detectors to optical cameras whenever possible. However, the failure rate on these optical sensors seems to be quite high, especially compared to the in-ground loop detectors

There appears to be numerous intersections where the loop detectors performed well for many years, but after the optical sensors have been installed experience an unusually high rate of issues or malfunctions. Many times, the light will default to a full green cycle for a side road or turning lane, even though no traffic is present.

While the locations with issues vary, currently three signals with issues are the NJDOT jurisdiction intersection of the ramp to I-295 North at Grove Rd (County Rt. 643) and Friars Blvd in West Deptford, the NJDOT jurisdiction intersection of NJ Rt. 45 and College Blvd & Riviera Drive on the West Deptford/Deptford Twp border, and the Gloucester County jurisdiction intersection of Clements Bridge Rd (County Route 544) and Almonesson Road (County Route 621). In all 3 of these examples, the signals are cycling at full green for all traffic movements, which in most cases is giving an unnecessary long green light to the minor roads and/or left turn signals (if applicable), and the result is typically providing the main road with the minimum allotted green time, which is increasing congestion or unnecessarily stopping traffic on the main road.

In addition, on some roads such as Route 45, the traffic light signal progression is off. This is a relatively recent occurrence over the past few years, but there's definitely an issue compared to several years ago. Route 45 in the Deptford/West Deptford/Woodbury Heights area is a divided roadway, signed as 50 mph between Main Street (Route 553A) in Mantua and Griscom Lane/Elm Ave in West Deptford/Woodbury Heights), and has some but relatively limited driveways for both residential and commercial properties. Previously, one could get from at least the Parkville Station Road light to and sometimes through the Griscom Lane/Elm Ave light without stopping travelling in both directions. However, for the past 2 or 3 years, the signal in-between these intersections at College Blvd/Riviera Drive appears to be mistimed, as it will turn red as traffic approaches it from either direction. This signal, as mentioned above, also cycles for the side road traffic regardless if traffic is present, and will remain green for the side road even though traffic has cleared the intersection. While on some occasions traffic may be moving at well above (or below) the speed limit and reaches the light prior to it cycling, this doesn't appear to be the issue here as traffic moving at the speed limit, as well as slower and faster traffic appear to reach the intersection while it is red. The result is that motorists on Route 45 are stopping at every traffic light.

As the divided road portion of Route 45 is from Woodbury to Mantua, it would be beneficial to coordinate these lights so that traffic flow can safely move through these lights without necessary stopping. With traffic stopping at every light, it severely increases the time to get just a few miles on a roadway that otherwise doesn't experience any congestion. When traffic on Route 45 gets a green signal at any of the above mentioned intersections, it tends to remain bunched up, only to approach the next intersection as the light turns red. In addition, traffic on the side roads are often times waiting at a red light when no traffic is passing, only to get their green light just as the traffic on Route 45 is reaching the light.

While I'm familiar with Route 45's conditions as I have lived in the area my entire life and travel the road nearly daily, it is by far not the only through road where signal progression is lacking.

In order to reduce both the sensor issues and the progression issues, additional funds should be allocated in the TIP each year in order for a faster response to issues when they appear, and faster response times when the issue is reported via NJDOT's Highway Maintenance Reporting form available on their website. Additionally, local NJDOT maintenance yards or other NJDOT or county personnel should be assigned to monitor traffic lights more frequently, including signal coordination, to more promptly address issues regarding traffic lights.

Sincerely,

Jeff Taylor

Comment ID: 132



# PUBLIC COMMENT FORM

## DRAFT FY2016 FOR NEW JERSEY



Item ID# 034

**Name:** Jeff Taylor

**County:** Gloucester County

**Project Title:** General Comment

**Comment:**

August 10, 2015

Please note: This letter was originally sent in for the FY12 New Jersey TIP. However, even though the jurisdiction for US 322 in this area is NJDOT, for unknown reasons, the letter was forwarded to Gloucester County's Public Works department, which of course responded back that it wasn't their jurisdiction. Please forward this modified letter to NJDOT for their review.

Rowan University in Glassboro, NJ continues to diversify its programs, increasingly adding students to its campus every year. For the majority of students from outside the area, they arrive by taking major limited access highways such as NJ Route 42 and NJ Route 55 to US Route 322. Upon exiting onto Route 322, the roadway quickly narrows down to a narrow 2 lane roadway, generally wooded in nature, but otherwise unkempt. It is approximately 1 to 1.5 miles to Rowan University from Route 55.

This 'Gateway to Rowan' can be vastly improved, providing students and visitors with a much more satisfying introduction to Gloucester County's premier University.

Route 322 should be widened from its present 2 lanes with minor 3 foot shoulders. The roadway could become 5 lanes wide – 2 travel lanes each direction, along with a continuous center turn lane, from the Route 55 interchange area to Bowe Blvd. Alternatively, the widened roadway could be 2 lanes in both directions with a landscaped median and turning lanes as needed. Additionally, full right shoulders should be added in both directions. The wider roadway will allow for a more visually pleasing trip towards the University, while the turning lanes will remove turning traffic from the travel lanes, resulting in reduced congestion and safer traffic flow.

East of Bowe Blvd, Rt. 322 should narrow down to 3 lanes – 1 lane per direction plus a center turn lane. After the existing railroad crossing, the center turn lane can end, at which point Rt. 322 will narrow down to 2 lanes – 1 lane per direction. This will not only preserve the existing roadway thru Rowan University, it will also serve as a natural speed reducing feature to better protect students and pedestrians walking around the University.

While this idea may involve purchasing some right-of-way from the front of the properties along Rt. 322 between Rt. 55 and Rowan University, in general the main structures of these properties are located far enough back from the roadway that they should be relatively unaffected by the roadway widening.

Where possible, visually pleasing designs techniques can be added to Rt. 322, including plants, trees and other foliage. Signage for Rowan University can be added to this area as well to assist motorists visiting the area.

Sincerely,

Jeff Taylor

Comment ID: 133



# PUBLIC COMMENT FORM

## DRAFT FY2016 FOR NEW JERSEY



Item ID# 165

**Name:** Pam Mount

**County:** Various Counties

**Project Title:** General Comment

**Comment:**

Dear County Executive Hughes and other DVRPC Board members,

I support the construction of new trails in Mercer County and throughout the rest of the region that together will build 750 miles of the Circuit, the region's trail network. I support the dedication of federal transportation funds towards Circuit Trails in Mercer, Burlington, Camden and Gloucester counties. Please consider adding a line item to the FY2016 TIP for Circuit Trails similar to the \$5 million line item that DVRPC recently created in the Pennsylvania TIP.

pam mount

princeton, NJ 08540

Comment ID: 79



# PUBLIC COMMENT FORM

## DRAFT FY2016 FOR NEW JERSEY



Item ID# 078

**Name:** Audrey Maest

**County:** Various Counties

**Project Title:** General Comment

**Comment:**

Dear County Executive Hughes and other DVRPC Board members,

I support the construction of new trails in Mercer County and throughout the rest of the region that together will build 750 miles of the Circuit, the region's trail network. I support the dedication of federal transportation funds towards Circuit Trails in Mercer, Burlington, Camden and Gloucester counties. Please consider adding a line item to the FY2016 TIP for Circuit Trails similar to the \$5 million line item that DVRPC recently created in the Pennsylvania TIP.

audrey maest

princeton, NJ 08540

Comment ID: 80



# PUBLIC COMMENT FORM

## DRAFT FY2016 FOR NEW JERSEY



Item ID#

**Name:** Edward Arnold

**County:** Various Counties

**Project Title:** General Comment

**Comment:**

Dear Gloucester County Freeholder Chila and other DVRPC Board members,

I support the construction of new trails in Gloucester County and throughout the rest of the region that together will build 750 miles of the Circuit, the region's trail network. I support the dedication of federal transportation funds towards Circuit Trails in Mercer, Burlington, Camden and Gloucester counties. Please consider adding a line item to the FY2016 TIP for Circuit Trails similar to the \$5 million line item that DVRPC recently created in the Pennsylvania TIP.

Edward Arnold

Sicklerville, NJ 0808

Comment ID: 81





# PUBLIC COMMENT FORM

## DRAFT FY2016 FOR NEW JERSEY



### Item ID#

**Name:** Julie Quinn

**County:** Various Counties

**Project Title:** General Comment

### Comment:

Dear Burlington County Freeholder Garganio and other DVRPC Board members,

I support the construction of new trails in Burlington County and throughout the rest of the region that together will build 750 miles of the Circuit, the region's trail network. I support the dedication of federal transportation funds towards Circuit Trails in Mercer, Burlington, Camden and Gloucester counties. Please consider adding a line item to the FY2016 TIP for Circuit Trails similar to the \$5 million line item that DVRPC recently created in the Pennsylvania TIP.

Julie Quinn

Medford, NJ 08055

Comment ID: 82



# PUBLIC COMMENT FORM

## DRAFT FY2016 FOR NEW JERSEY



Item ID# 106

**Name:** Donald Elsas

**County:** Various Counties

**Project Title:** General Comment

**Comment:**

Dear Camden County Freeholder Cappelli and other DVRPC Board members,

I support the construction of new trails in Camden County and throughout the rest of the region that together will build 750 miles of the Circuit, the region's trail network. I support the dedication of federal transportation funds towards Circuit Trails in Mercer, Burlington, Camden and Gloucester counties. Please consider adding a line item to the FY2016 TIP for Circuit Trails similar to the \$5 million line item that DVRPC recently created in the Pennsylvania TIP.

Donald Elsas

Cherry Hill, NJ 08003

Comment ID: 83



# PUBLIC COMMENT FORM

## DRAFT FY2016 FOR NEW JERSEY



Item ID# 085

**Name:** Carrie Kelly

**County:** Various Counties

**Project Title:** General Comment

**Comment:**

Dear Camden County Freeholder Cappelli and other DVRPC Board members,

I support the construction of new trails in Camden County and throughout the rest of the region that together will build 750 miles of the Circuit, the region's trail network. I support the dedication of federal transportation funds towards Circuit Trails in Mercer, Burlington, Camden and Gloucester counties. Please consider adding a line item to the FY2016 TIP for Circuit Trails similar to the \$5 million line item that DVRPC recently created in the Pennsylvania TIP.

Carrie Kelly

Cherry Hill, NJ 08034

Comment ID: 84



# PUBLIC COMMENT FORM

## DRAFT FY2016 FOR NEW JERSEY



Item ID# 100

**Name:** David Durham

**County:** Various Counties

**Project Title:** General Comment

**Comment:**

Dear Gloucester County Freeholder Chila and other DVRPC Board members,

I support the construction of new trails in Gloucester County and throughout the rest of the region that together will build 750 miles of the Circuit, the region's trail network. I support the dedication of federal transportation funds towards Circuit Trails in Mercer, Burlington, Camden and Gloucester counties. Please consider adding a line item to the FY2016 TIP for Circuit Trails similar to the \$5 million line item that DVRPC recently created in the Pennsylvania TIP.

David Durham

Wenonah, NJ 08090

Comment ID: 85



# PUBLIC COMMENT FORM

## DRAFT FY2016 FOR NEW JERSEY



Item ID# 137

**Name:** John Poserina

**County:** Various Counties

**Project Title:** General Comment

**Comment:**

Dear Camden County Freeholder Cappelli and other DVRPC Board members,

I support the construction of new trails in Camden County and throughout the rest of the region that together will build 750 miles of the Circuit, the region's trail network. I support the dedication of federal transportation funds towards Circuit Trails in Mercer, Burlington, Camden and Gloucester counties. Please consider adding a line item to the FY2016 TIP for Circuit Trails similar to the \$5 million line item that DVRPC recently created in the Pennsylvania TIP.

I am particularly interested in a safe bicycle connection between Camden/Cherry Hill and Hamilton/Trenton. I would ride my bike to work on occasion if there were a safe route.

John Poserina

Cherry Hill, NJ 08034

Comment ID: 86



# PUBLIC COMMENT FORM

## DRAFT FY2016 FOR NEW JERSEY



Item ID# 149

**Name:** Kyle Konopka

**County:** Various Counties

**Project Title:** General Comment

**Comment:**

Dear Camden County Freeholder Cappelli and other DVRPC Board members,

I support the construction of new trails in Camden County and throughout the rest of the region that together will build 750 miles of the Circuit, the region's trail network. I support the dedication of federal transportation funds towards Circuit Trails in Mercer, Burlington, Camden and Gloucester counties. Please consider adding a line item to the FY2016 TIP for Circuit Trails similar to the \$5 million line item that DVRPC recently created in the Pennsylvania TIP.

Kyle Konopka

Haddon Heights, NJ 08035

Comment ID: 91



# PUBLIC COMMENT FORM

## DRAFT FY2016 FOR NEW JERSEY



Item ID# 099

**Name:** Dave Cox

**County:** Various Counties

**Project Title:** General Comment

**Comment:**

Dear Camden County Freeholder Cappelli and other DVRPC Board members,

I support the construction of new trails in Camden County and throughout the rest of the region that together will build 750 miles of the Circuit, the region's trail network. I support the dedication of federal transportation funds towards Circuit Trails in Mercer, Burlington, Camden and Gloucester counties. Please consider adding a line item to the FY2016 TIP for Circuit Trails similar to the \$5 million line item that DVRPC recently created in the Pennsylvania TIP.

Dave Cox

Haddon Heights, NJ 08035

Comment ID: 92



# PUBLIC COMMENT FORM

## DRAFT FY2016 FOR NEW JERSEY



Item ID# 120

**Name:** Ilene Dougherty

**County:** Various Counties

**Project Title:** General Comment

**Comment:**

Dear Burlington County Freeholder Garganio and other DVRPC Board members,

I support the construction of new trails in Burlington County and throughout the rest of the region that together will build 750 miles of the Circuit, the region's trail network. I support the dedication of federal transportation funds towards Circuit Trails in Mercer, Burlington, Camden and Gloucester counties. Please consider adding a line item to the FY2016 TIP for Circuit Trails similar to the \$5 million line item that DVRPC recently created in the Pennsylvania TIP.

Ilene Dougherty

Maple Shade, NJ 08052

Comment ID: 58





# PUBLIC COMMENT FORM

## DRAFT FY2016 FOR NEW JERSEY



Item ID#

**Name:** Lisa Joy

**County:** Various Counties

**Project Title:** General Comment

**Comment:**

Dear Burlington County Freeholder Garganio and other DVRPC Board members,

I support the construction of new trails in Burlington County and throughout the rest of the region that together will build 750 miles of the Circuit, the region's trail network. I support the dedication of federal transportation funds towards Circuit Trails in Mercer, Burlington, Camden and Gloucester counties. Please consider adding a line item to the FY2016 TIP for Circuit Trails similar to the \$5 million line item that DVRPC recently created in the Pennsylvania TIP.

Lisa Joy

Trenton, NJ 08620

Comment ID: 59



# PUBLIC COMMENT FORM

## DRAFT FY2016 FOR NEW JERSEY



Item ID# 151

**Name:** Lisa Joy

**County:** Various Counties

**Project Title:** General Comment

**Comment:**

Dear County Executive Hughes and other DVRPC Board members,

I support the construction of new trails in Mercer County and throughout the rest of the region that together will build 750 miles of the Circuit, the region's trail network. I support the dedication of federal transportation funds towards Circuit Trails in Mercer, Burlington, Camden and Gloucester counties. Please consider adding a line item to the FY2016 TIP for Circuit Trails similar to the \$5 million line item that DVRPC recently created in the Pennsylvania TIP.

Lisa Joy

Trenton, NJ 08620

Comment ID: 60



# PUBLIC COMMENT FORM

## DRAFT FY2016 FOR NEW JERSEY



Item ID# 134

**Name:** John Joyce

**County:** Various Counties

**Project Title:** General Comment

**Comment:**

Dear Burlington County Freeholder Garganio and other DVRPC Board members,

I support the construction of new trails in Burlington County and throughout the rest of the region that together will build 750 miles of the Circuit, the region's trail network. I support the dedication of federal transportation funds towards Circuit Trails in Mercer, Burlington, Camden and Gloucester counties. Please consider adding a line item to the FY2016 TIP for Circuit Trails similar to the \$5 million line item that DVRPC recently created in the Pennsylvania TIP.

John Joyce

Shamong, NJ 08088

Comment ID: 61



# PUBLIC COMMENT FORM

## DRAFT FY2016 FOR NEW JERSEY



Item ID# 147

**Name:** Ken Wilkie

**County:** Various Counties

**Project Title:** General Comment

**Comment:**

Dear County Executive Hughes and other DVRPC Board members,

I support the construction of new trails in Mercer County and throughout the rest of the region that together will build 750 miles of the Circuit, the region's trail network. I support the dedication of federal transportation funds towards Circuit Trails in Mercer, Burlington, Camden and Gloucester counties. Please consider adding a line item to the FY2016 TIP for Circuit Trails similar to the \$5 million line item that DVRPC recently created in the Pennsylvania TIP.

Ken Wilkie

Hamilton Square, NJ 08690

Comment ID: 62



# PUBLIC COMMENT FORM

## DRAFT FY2016 FOR NEW JERSEY



Item ID# 129

**Name:** Jeffrey Meyers

**County:** Various Counties

**Project Title:** General Comment

**Comment:**

Dear Camden County Freeholder Cappelli and other DVRPC Board members,

I support the construction of new trails in Camden County and throughout the rest of the region that together will build 750 miles of the Circuit, the region's trail network. I support the dedication of federal transportation funds towards Circuit Trails in Mercer, Burlington, Camden and Gloucester counties. Please consider adding a line item to the FY2016 TIP for Circuit Trails similar to the \$5 million line item that DVRPC recently created in the Pennsylvania TIP.

Jeffrey Meyers

Cherry Hill, NJ 08003

Comment ID: 63



# PUBLIC COMMENT FORM

## DRAFT FY2016 FOR NEW JERSEY



Item ID# 125

**Name:** James Licht

**County:** Various Counties

**Project Title:** General Comment

**Comment:**

Dear Gloucester County Freeholder Chila and other DVRPC Board members,

I support the construction of new trails in Gloucester County and throughout the rest of the region that together will build 750 miles of the Circuit, the region's trail network. I support the dedication of federal transportation funds towards Circuit Trails in Mercer, Burlington, Camden and Gloucester counties. Please consider adding a line item to the FY2016 TIP for Circuit Trails similar to the \$5 million line item that DVRPC recently created in the Pennsylvania TIP.

James Licht

Sewell, NJ 08080

Comment ID: 64



# PUBLIC COMMENT FORM

## DRAFT FY2016 FOR NEW JERSEY



Item ID# 176

**Name:** Rick Moore

**County:** Various Counties

**Project Title:** General Comment

**Comment:**

Dear Burlington County Freeholder Garganio and other DVRPC Board members,

I support the construction of new trails in Burlington County and throughout the rest of the region that together will build 750 miles of the Circuit, the region's trail network. I support the dedication of federal transportation funds towards Circuit Trails in Mercer, Burlington, Camden and Gloucester counties. Please consider adding a line item to the FY2016 TIP for Circuit Trails similar to the \$5 million line item that DVRPC recently created in the Pennsylvania TIP.

Rick Moore

Palmyra, NJ 08065

Comment ID: 65



# PUBLIC COMMENT FORM

## DRAFT FY2016 FOR NEW JERSEY



Item ID# 164

**Name:** P. Schindel

**County:** Various Counties

**Project Title:** General Comment

**Comment:**

Dear County Executive Hughes and other DVRPC Board members,

I support the construction of new trails in Mercer County and throughout the rest of the region that together will build 750 miles of the Circuit, the region's trail network. I support the dedication of federal transportation funds towards Circuit Trails in Mercer, Burlington, Camden and Gloucester counties. Please consider adding a line item to the FY2016 TIP for Circuit Trails similar to the \$5 million line item that DVRPC recently created in the Pennsylvania TIP.

P. Schindel

Lawrenceville, NJ 08648

Comment ID: 66





# PUBLIC COMMENT FORM

## DRAFT FY2016 FOR NEW JERSEY



Item ID# 082

**Name:** Bruce Rubin

**County:** Various Counties

**Project Title:** General Comment

**Comment:**

Dear Camden County Freeholder Cappelli and other DVRPC Board members,

I support the construction of new trails in Camden County and throughout the rest of the region that together will build 750 miles of the Circuit, the region's trail network. I support the dedication of federal transportation funds towards Circuit Trails in Mercer, Burlington, Camden and Gloucester counties. Please consider adding a line item to the FY2016 TIP for Circuit Trails similar to the \$5 million line item that DVRPC recently created in the Pennsylvania TIP.

Bruce Rubin

Voorhees, NJ 08043

Comment ID: 67



# PUBLIC COMMENT FORM

## DRAFT FY2016 FOR NEW JERSEY



Item ID# 168

**Name:** Patricia Lyons

**County:** Various Counties

**Project Title:** General Comment

**Comment:**

Dear Burlington County Freeholder Garganio and other DVRPC Board members,

I support the construction of new trails in Burlington County and throughout the rest of the region that together will build 750 miles of the Circuit, the region's trail network. I support the dedication of federal transportation funds towards Circuit Trails in Mercer, Burlington, Camden and Gloucester counties. Please consider adding a line item to the FY2016 TIP for Circuit Trails similar to the \$5 million line item that DVRPC recently created in the Pennsylvania TIP.

Patricia Lyons

Moorestown, NJ 08057

Comment ID: 68



# PUBLIC COMMENT FORM

## DRAFT FY2016 FOR NEW JERSEY



Item ID# 103

**Name:** Denise Everett

**County:** Various Counties

**Project Title:** General Comment

**Comment:**

Dear Gloucester County Freeholder Chila and other DVRPC Board members,

I support the construction of new trails in Gloucester County and throughout the rest of the region that together will build 750 miles of the Circuit, the region's trail network. I support the dedication of federal transportation funds towards Circuit Trails in Mercer, Burlington, Camden and Gloucester counties. Please consider adding a line item to the FY2016 TIP for Circuit Trails similar to the \$5 million line item that DVRPC recently created in the Pennsylvania TIP.

Trails add so much to a community - a way to commute, exercise and commune with nature and family and friends. When my husband and I look for places to visit, we look for trails the area has to explore. More and more people are coming to value trail systems like this. Trails that offer ways to commute have even more value.

Please add this line item to the proposal.

Denise Everett

Pitman, NJ 08071

Comment ID: 69



# PUBLIC COMMENT FORM

## DRAFT FY2016 FOR NEW JERSEY



Item ID#

**Name:** Robert Cummings

**County:** Various Counties

**Project Title:** General Comment

**Comment:**

Dear Burlington County Freeholder Garganio and other DVRPC Board members,

I support the construction of new trails in Burlington County and throughout the rest of the region that together will build 750 miles of the Circuit, the region's trail network. I support the dedication of federal transportation funds towards Circuit Trails in Mercer, Burlington, Camden and Gloucester counties. Please consider adding a line item to the FY2016 TIP for Circuit Trails similar to the \$5 million line item that DVRPC recently created in the Pennsylvania TIP.

Robert Cummings

Browns Mills, NJ 08015

Comment ID: 70



# PUBLIC COMMENT FORM

## DRAFT FY2016 FOR NEW JERSEY



Item ID# 077

**Name:** Antonina Renner

**County:** Various Counties

**Project Title:** General Comment

**Comment:**

Dear Gloucester County Freeholder Chila and other DVRPC Board members,

I support the construction of new trails in Gloucester County and throughout the rest of the region that together will build 750 miles of the Circuit, the region's trail network. I support the dedication of federal transportation funds towards Circuit Trails in Mercer, Burlington, Camden and Gloucester counties. Please consider adding a line item to the FY2016 TIP for Circuit Trails similar to the \$5 million line item that DVRPC recently created in the Pennsylvania TIP.

Antonina Renner

Sewell, NJ 08080

Comment ID: 71



# PUBLIC COMMENT FORM

## DRAFT FY2016 FOR NEW JERSEY



Item ID# 124

**Name:** James Flaherty

**County:** Various Counties

**Project Title:** General Comment

**Comment:**

Dear Camden County Freeholder Cappelli and other DVRPC Board members,

I support the construction of new trails in Camden County and throughout the rest of the region that together will build 750 miles of the Circuit, the region's trail network. I support the dedication of federal transportation funds towards Circuit Trails in Mercer, Burlington, Camden and Gloucester counties. Please consider adding a line item to the FY2016 TIP for Circuit Trails similar to the \$5 million line item that DVRPC recently created in the Pennsylvania TIP.

James Flaherty

Collingswood, NJ 08108

Comment ID: 72



# PUBLIC COMMENT FORM

## DRAFT FY2016 FOR NEW JERSEY



Item ID# 131

**Name:** Joan Buehler

**County:** Various Counties

**Project Title:** General Comment

**Comment:**

Dear Camden County Freeholder Cappelli and other DVRPC Board members,

I support the construction of new trails in Camden County and throughout the rest of the region that together will build 750 miles of the Circuit, the region's trail network. I support the dedication of federal transportation funds towards Circuit Trails in Mercer, Burlington, Camden and Gloucester counties. Please consider adding a line item to the FY2016 TIP for Circuit Trails similar to the \$5 million line item that DVRPC recently created in the Pennsylvania TIP.

Joan Buehler

Collingswood, NJ 0810

Comment ID: 73



# PUBLIC COMMENT FORM

## DRAFT FY2016 FOR NEW JERSEY



Item ID# 170

**Name:** Paul Moul

**County:** Various Counties

**Project Title:** General Comment

**Comment:**

Dear Camden County Freeholder Cappelli and other DVRPC Board members,

I support the construction of new trails in Camden County and throughout the rest of the region that together will build 750 miles of the Circuit, the region's trail network. I support the dedication of federal transportation funds towards Circuit Trails in Mercer, Burlington, Camden and Gloucester counties. Please consider adding a line item to the FY2016 TIP for Circuit Trails similar to the \$5 million line item that DVRPC recently created in the Pennsylvania TIP.

Paul Moul

Haddonfield, NJ 08033

Comment ID: 74





# PUBLIC COMMENT FORM

## DRAFT FY2016 FOR NEW JERSEY



Item ID# 095

**Name:** Daniel Hauber

**County:** Various Counties

**Project Title:** General Comment

**Comment:**

Dear Camden County Freeholder Cappelli and other DVRPC Board members,

I support the construction of new trails in Camden County and throughout the rest of the region that together will build 750 miles of the Circuit, the region's trail network. I support the dedication of federal transportation funds towards Circuit Trails in Mercer, Burlington, Camden and Gloucester counties.

I believe this is especially important given the current state of development and transportation in Camden County and in the Philadelphia region. I also believe that these trails can have a direct and positive impact on our towns, and across many economic strata.

Please consider adding a line item to the FY2016 TIP for Circuit Trails similar to the \$5 million line item that DVRPC recently created in the Pennsylvania TIP.

Daniel Hauber

Haddonfield, NJ 08033

Comment ID: 75



# PUBLIC COMMENT FORM

## DRAFT FY2016 FOR NEW JERSEY



Item ID# 130

**Name:** Jess Everett

**County:** Various Counties

**Project Title:** General Comment

**Comment:**

Dear Gloucester County Freeholder Chila and other DVRPC Board members,

I support the construction of new trails in Gloucester County and throughout the rest of the region that together will build 750 miles of the Circuit, the region's trail network. I support the dedication of federal transportation funds towards Circuit Trails in Mercer, Burlington, Camden and Gloucester counties. Please consider adding a line item to the FY2016 TIP for Circuit Trails similar to the \$5 million line item that DVRPC recently created in the Pennsylvania TIP.

Jess Everett

Pitman, NJ 08071

Comment ID: 76



# PUBLIC COMMENT FORM

## DRAFT FY2016 FOR NEW JERSEY



Item ID# 161

**Name:** Mindy Gumminger

**County:** Various Counties

**Project Title:** General Comment

**Comment:**

Dear Camden County Freeholder Cappelli and other DVRPC Board members,

I support the construction of new trails in Camden County and throughout the rest of the region that together will build 750 miles of the Circuit, the region's trail network. I support the dedication of federal transportation funds towards Circuit Trails in Mercer, Burlington, Camden and Gloucester counties. Please consider adding a line item to the FY2016 TIP for Circuit Trails similar to the \$5 million line item that DVRPC recently created in the Pennsylvania TIP.

Mindy Gumminger

Haddon Township, NJ 08108

Comment ID: 77



# PUBLIC COMMENT FORM

## DRAFT FY2016 FOR NEW JERSEY



Item ID# 162

**Name:** Neil Samuels

**County:** Various Counties

**Project Title:** General Comment

**Comment:**

Dear Camden County Freeholder Cappelli and other DVRPC Board members,

I support the construction of new trails in Camden County and throughout the rest of the region that together will build 750 miles of the Circuit, the region's trail network. I support the dedication of federal transportation funds towards Circuit Trails in Mercer, Burlington, Camden and Gloucester counties. Please consider adding a line item to the FY2016 TIP for Circuit Trails similar to the \$5 million line item that DVRPC recently created in the Pennsylvania TIP.

Neil Samuels

Merchantville, NJ 08109

Comment ID: 93



# PUBLIC COMMENT FORM

## DRAFT FY2016 FOR NEW JERSEY



Item ID# 073

**Name:** Alan Mann

**County:** Various Counties

**Project Title:** General Comment

**Comment:**

Dear County Executive Hughes and other DVRPC Board members,

I support the construction of new trails in Mercer County and throughout the rest of the region that together will build 750 miles of the Circuit, the region's trail network. I support the dedication of federal transportation funds towards Circuit Trails in Mercer, Burlington, Camden and Gloucester counties. Please consider adding a line item to the FY2016 TIP for Circuit Trails similar to the \$5 million line item that DVRPC recently created in the Pennsylvania TIP.

Alan Mann

Princeton, NJ 08540

Comment ID: 94



# PUBLIC COMMENT FORM

## DRAFT FY2016 FOR NEW JERSEY



Item ID# 163

**Name:** Norman Beil

**County:** Various Counties

**Project Title:** General Comment

**Comment:**

Dear Camden County Freeholder Cappelli and other DVRPC Board members,

I support the construction of new trails in Camden County and throughout the rest of the region that together will build 750 miles of the Circuit, the region's trail network. I support the dedication of federal transportation funds towards Circuit Trails in Mercer, Burlington, Camden and Gloucester counties. Please consider adding a line item to the FY2016 TIP for Circuit Trails similar to the \$5 million line item that DVRPC recently created in the Pennsylvania TIP.

Norman Beil

Merchantville, NJ 08109

Comment ID: 95



# PUBLIC COMMENT FORM

## DRAFT FY2016 FOR NEW JERSEY



Item ID# 181

**Name:** Sam Hartman

**County:** Various Counties

**Project Title:** General Comment

**Comment:**

Dear Camden County Freeholder Cappelli and other DVRPC Board members,

I support the construction of new trails in Camden County and throughout the rest of the region that together will build 750 miles of the Circuit, the region's trail network. I support the dedication of federal transportation funds towards Circuit Trails in Mercer, Burlington, Camden and Gloucester counties. Please consider adding a line item to the FY2016 TIP for Circuit Trails similar to the \$5 million line item that DVRPC recently created in the Pennsylvania TIP. May I add that Winslow Township needs Bike Lanes. Why are we the forgotten Camden County.

Sam Hartman

Sicklerville, NJ 08081

Comment ID: 96



# PUBLIC COMMENT FORM

## DRAFT FY2016 FOR NEW JERSEY



Item ID# 108

**Name:** Douglas Cowperthwaite

**County:** Various Counties

**Project Title:** General Comment

**Comment:**

Dear Camden County Freeholder Cappelli and other DVRPC Board members,

I support the construction of new trails in Camden County and throughout the rest of the region that together will build 750 miles of the Circuit, the region's trail network. I support the dedication of federal transportation funds towards Circuit Trails in Mercer, Burlington, Camden and Gloucester counties. Please consider adding a line item to the FY2016 TIP for Circuit Trails similar to the \$5 million line item that DVRPC recently created in the Pennsylvania TIP.

Douglas Cowperthwaite

Cherry Hill, NJ 08034

Comment ID: 97





# PUBLIC COMMENT FORM

## DRAFT FY2016 FOR NEW JERSEY



Item ID# 079

**Name:** Ben Carter

**County:** Various Counties

**Project Title:** General Comment

**Comment:**

Aug 6, 2015

DVRPC Board Members

Dear Members,

I support the construction of new trails in Mercer County and throughout the rest of the region that together will build 750 miles of the Circuit, the region's trail network. I support the dedication of federal transportation funds toward Circuit trails in Mercer, Burlington, Camden and Gloucester counties. Please consider adding a line item to the FY2016 TIP for Circuit trails similar to the \$5 million line item that DVRPC recently created in the Pennsylvania TIP.

Sincerely,

Mr. Ben Carter

Trenton, NJ 08628

Comment ID: 98



# PUBLIC COMMENT FORM

## DRAFT FY2016 FOR NEW JERSEY



Item ID# 184

**Name:** Scott Krause

**County:** Various Counties

**Project Title:** General Comment

**Comment:**

Dear Camden County Freeholder Cappelli and other DVRPC Board members,

I support the construction of new trails in Camden County and throughout the rest of the region that together will build 750 miles of the Circuit, the region's trail network. I support the dedication of federal transportation funds towards Circuit Trails in Mercer, Burlington, Camden and Gloucester counties. Please consider adding a line item to the FY2016 TIP for Circuit Trails similar to the \$5 million line item that DVRPC recently created in the Pennsylvania TIP.

Scott Krause

Voorhees, NJ 08043

Comment ID: 99



# PUBLIC COMMENT FORM

## DRAFT FY2016 FOR NEW JERSEY



Item ID# 146

**Name:** Ken Goldberg

**County:** Various Counties

**Project Title:** General Comment

**Comment:**

Dear Camden County Freeholder Cappelli and other DVRPC Board members,

I support the construction of new trails in Camden County and throughout the rest of the region that together will build 750 miles of the Circuit, the region's trail network. I support the dedication of federal transportation funds towards Circuit Trails in Mercer, Burlington, Camden and Gloucester counties. Please consider adding a line item to the FY2016 TIP for Circuit Trails similar to the \$5 million line item that DVRPC recently created in the Pennsylvania TIP.

Ken Goldberg

Cherry Hill, NJ 08003

Comment ID: 100



# PUBLIC COMMENT FORM

## DRAFT FY2016 FOR NEW JERSEY



Item ID#

**Name:** Robert Cummings

**County:** Various Counties

**Project Title:** General Comment

**Comment:**

Dear Burlington County Freeholder Garganio and other DVRPC Board members,

I support the construction of new trails in Burlington County and throughout the rest of the region that together will build 750 miles of the Circuit, the region's trail network. I support the dedication of federal transportation funds towards Circuit Trails in Mercer, Burlington, Camden and Gloucester counties. Please consider adding a line item to the FY2016 TIP for Circuit Trails similar to the \$5 million line item that DVRPC recently created in the Pennsylvania TIP.

Robert Cummings

Browns Mills, NJ 0801

Comment ID: 101



# PUBLIC COMMENT FORM

## DRAFT FY2016 FOR NEW JERSEY



Item ID# 093

**Name:** Cyndi Steiner

**County:** Various Counties

**Project Title:** General Comment

**Comment:**

Please create a "line item" for Circuit Trails in the FY2016 TIP.

Comment ID: 89



# PUBLIC COMMENT FORM

## DRAFT FY2016 FOR NEW JERSEY



Item ID# 026

**Name:** Joseph Russell

**County:** Camden County

**Project Title:** General Comment

**Comment:**

I would like to see Camden County receive money from the state to implement its Bicycle and Multi-use Trail master plan.

Comment ID: 90



# PUBLIC COMMENT FORM

## DRAFT FY2016 FOR NEW JERSEY



**Name:** The Circuit Coalition

**County:** Various Counties

**Project Title:** General Comment

**Comment:**

The Circuit Coalition, a collaboration of non-profit organizations and foundations working to advance completion of a connected network of trails â€” the Circuit â€” in the Greater Philadelphia region, commends the progress being made to improve non-motorized transportation throughout Mercer, Burlington, Camden and Gloucester counties. FY 2016 NJ TIP Projects such as the â€œRiver Road Improvementsâ€” in the City of Camden, which add pedestrian safety infrastructure like crosswalks and median islands to existing roadways, will help area residents to safely reach local destinations and regional trails without having to use a motor vehicle. Furthermore, Circuit trail projects, like Gloucester Countyâ€™s extension of the Glassboro-Elk Trail will aid in the goal of connecting regionally significant destinations, like Rowan University, with multi-use trails that can be used as transportation routes for pedestrians and bicyclists.

Several Circuit trail projects are underway in each of the four New Jersey counties within the DVRPC region and are expected to be complete by Spring 2017. These include the new ramp on the Ben Franklin Bridge, a three mile section of the Kinkora Trail, the Carter Road section of the Lawrence Hopewell Trail and the Glassboro-Elk Trail extension.

To further capitalize on the benefits of these individual projects, the Circuit Coalition encourages the regionâ€™s leaders to continue working together to prioritize the planning and design of trail segments throughout the region. To that end, the time is right to create a New Jersey TIP â€œline itemâ€” that would set aside dedicated funding for the regionâ€™s trails projects. As a model, the New Jersey counties can look to the recent unanimous action of the DVRPC Board approving such a line item for the Pennsylvania TIP, which designated five million in federal congestion mitigation air quality (CMAQ) dollars for construction of Circuit trails in Delaware, Montgomery, Chester, Bucks and Philadelphia counties.

A line item for Circuit trails in the Draft DVRPC FY2016 TIP for New Jersey would create an opportunity to leverage the existing William Penn Foundation-funded â€œRegional Trails Programâ€” and other non-federal grants with federal transportation dollars. Such a line item would reinforce DVRPCâ€™s strong commitment to advance one of its 2040 Connections Plan goals â€” building 750 miles of Circuit trails by 2040.

There is strong public support for the Circuit, which further highlights the benefits of including a TIP line item for New Jersey Circuit trails in the DVRPC FY2016 NJ TIP. In May 2015, the Bicycle Coalition of Greater Philadelphia conducted a public opinion phone survey across all nine counties of the Delaware Valley, which reached 1000 households, with a minimum of 100 in each of DVRPCâ€™s nine counties. The survey found high levels of support for trails in the region. Overall, 85 percent support building more trails in their counties and 70 percent are in favor of spending two dollars per person annually of public funds to pay for new miles of trails. Sixty percent of respondents said they would like to have access to a trail within ten minutes of their homes.

The Circuit Coalition thanks Mercer, Burlington, Camden and Gloucester counties for working together to improve the conditions for walking and biking throughout the region and we encourage area leaders to continue to advance significant regional trail connections, including building a trail alongside the future Glassboro-Camden Light Rail line. By setting aside federal transportation dollars to advance the goal of completing the Circuit in the FY2016 TIP, further steady progress in completing the network will be made, giving Delaware Valley residents a safe, convenient and affordable way to reach daily destinations and recreational activities.

Comment ID: 102





# PUBLIC COMMENT FORM

## DRAFT FY2016 FOR NEW JERSEY



Item ID# 031

**Name:** Kevin Somdahl-Sands

**County:** Gloucester County

**Project Title:** Gloucester County Multi-Purpose Trail Extension - Glassboro Elk Trail

**DB#:** D1203

**Comment:**

Wasn't this funded in 2014 TIP?? I would love to see it built, but I'm frustrated that it is taking so long to get it done. Survey crews were out there in April 2014. Nothing happening since. If this is the main bicycling project in Gloucester County for the second TIP round in a row - then it seems like Gloucester County is not getting its share of funds to improve running/bicycling infrastructure. Please include more funding in the future.

Comment ID: 103



# PUBLIC COMMENT FORM

## DRAFT FY2016 FOR NEW JERSEY



Item ID# 041

**Name:** Mayor Liz Lempert

**County:** Mercer County

**Project Title:** General Comment

**Comment:**

Dear Sir or Madame: Thank you for the opportunity to comment on the Draft DVRPC Fiscal Year (FY) 2016 Transportation Improvement Program for New Jersey (TIP). The TIP process is an opportunity to set statewide, regional and local transportation priorities. The Princeton community is impacted by major state and county highways that move traffic both north-south and east-west to various destination in our area and within the region. Princeton is also served by bus and rail lines that provides both local and regional service, Deficiencies in major state, county and local roads such as Route 1, Route 206, Route 27, Alexander Street, Washington Road and Harrison Street and NJ Transit bus and rail service should be addressed in the TIP. The TIP should also put forth projects that improve the region's air quality, move people and goods efficiently and improve the quality of life. Princeton has reviewed the TIP document and offers the following comments.

**Route 1:**

Route 1 is the main commercial corridor in central New Jersey and we note a number of

maintenance projects are proposed in our area. Missing from the TIP is funding for much needed improvements to the Route 1 and Washington Road/Harrison Street interchanges. The lack of movement on adding lanes and improving these intersections allows congestion to worsen, degrades our air quality and negatively impacts the quality of life for Princeton residents. Route 206:

Route 206 is a major north south connector traversing the heart of Princeton and we note

improvements are slated outside of Princeton which could have a deleterious impact. The effect of widening Route 206, which is a two-lane highway through Princeton, to four-lanes in Hillsborough and Montgomery should be carefully evaluated for its impact on air quality, congestion and quality of life.

**Route 27:**

Route 27 is Princeton's main street and serves not only our downtown. But Princeton University. We would like to see the TIP address pedestrian and bicycle safety along this roadway. Alexander Street/Washington Road/Harrison Street. These three roads are the major entry into the Princeton Community and changes along Route 1 will have major impacts on them. Of immediate concern to Princeton is the bridge on Alexander Road over the Stony Brook which needs replacement. Very truly yours, Liz Lempert, Mayor

Comment ID: 134



**Office of the Mayor**  
**Princeton Municipal Building**  
**400 Witherspoon Street**  
**Princeton, NJ 08540**  
**609-924-5704**  
[www.princetonnj.gov](http://www.princetonnj.gov)  
[llemper@princetonnj.gov](mailto:llemper@princetonnj.gov)

Plan/TIP/Conformity Comments  
DVRPC  
ACP Building  
8<sup>th</sup> Floor  
190 N. Independence Mall West  
Philadelphia, PA 19106

Re: Draft FY 2016-2019 NJ TIP

Dear Sir or Madame:

Thank you for the opportunity to comment on the Draft DVRPC Fiscal Year (FY) 2016 Transportation Improvement Program for New Jersey (TIP). The TIP process is an opportunity to set statewide, regional and local transportation priorities. The Princeton community is impacted by major state and county highways that move traffic both north-south and east-west to various destination in our area and within the region. Princeton is also served by bus and rail lines that provides both local and regional service.

Deficiencies in major state, county and local roads such as Route 1, Route 206, Route 27, Alexander Street, Washington Road and Harrison Street and NJ Transit bus and rail service should be addressed in the TIP. The TIP should also put forth projects that improve the region's air quality, move people and goods efficiently and improve the quality of life.

Princeton has reviewed the TIP document and offers the following comments.

#### **Route 1**

Route 1 is the main commercial corridor in central New Jersey and we note a number of maintenance projects are proposed in our area. Missing from the TIP is funding for much needed improvements to the Route 1 and Washington Road/Harrison Street interchanges. The lack of movement on adding lanes and improving these intersections allows congestion to worsen, degrades our air quality and negatively impacts the quality of life for Princeton residents.

#### **Route 206**

Route 206 is a major north south connector traversing the heart of Princeton and we note improvements are slated outside of Princeton which could have a deleterious impact. The effect of

widening Route 206, which is a two-lane highway through Princeton, to four-lanes in Hillsborough and Montgomery should be carefully evaluated for its impact on air quality, congestion and quality of life.

**Route 27**

Route 27 is Princeton's main street and serves not only our downtown but Princeton University. We would like to see the TIP address pedestrian and bicycle safety along this roadway.

**Alexander Street/Washington Road/Harrison Street**

These three roads are the major entry into the Princeton Community and changes along Route 1 will have major impacts on them. Of immediate concern to Princeton is the bridge on Alexander Road over the Stony Brook which needs replacement.

Very truly yours,

A handwritten signature in black ink, appearing to read 'Liz Lempert', with a stylized flourish at the end.

Liz Lempert, Mayor



# PUBLIC COMMENT FORM

## DRAFT FY2016 FOR NEW JERSEY



Item ID# 153

**Name:** M. Murphy

**County:** Various Counties

**Project Title:** General Comment

**Comment:**

Aug 7, 2015

DVRPC Board Members

Dear Members,

I support the construction of new trails in Camden County and throughout the rest of the region that together will build 750 miles of the Circuit, the region's trail network. I support the dedication of federal transportation funds toward Circuit trails in Mercer, Burlington, Camden and Gloucester counties. Please consider adding a line item to the FY2016 TIP for Circuit trails similar to the \$5 million line item that DVRPC recently created in the Pennsylvania TIP.

Sincerely,

Ms. M. Murphy

Cherry Hill, NJ 08034-2608

Comment ID: 177



# PUBLIC COMMENT FORM

## DRAFT FY2016 FOR NEW JERSEY



Item ID# 172

**Name:** Paul Viggiano

**County:** Various Counties

**Project Title:** General Comment

**Comment:**

Aug 7, 2015

DVRPC Board Members

Dear Members,

I support the construction of new trails in Camden County and throughout the rest of the region that together will build 750 miles of the Circuit, the region's trail network. I support the dedication of federal transportation funds toward Circuit trails in Mercer, Burlington, Camden and Gloucester counties. Please consider adding a line item to the FY2016 TIP for Circuit trails similar to the \$5 million line item that DVRPC recently created in the Pennsylvania TIP.

Sincerely,

Mr. Paul Viggiano

Haddon Heights, NJ 08035-1404

Comment ID: 178



# PUBLIC COMMENT FORM

## DRAFT FY2016 FOR NEW JERSEY



Item ID# 105

**Name:** Diane Bacher

**County:** Various Counties

**Project Title:** General Comment

**Comment:**

Aug 7, 2015

DVRPC Board Members

Dear Members,

I support the construction of new trails in Gloucester County and throughout the rest of the region that together will build 750 miles of the Circuit, the region's trail network. I support the dedication of federal transportation funds toward Circuit trails in Mercer, Burlington, Camden and Gloucester counties. Please consider adding a line item to the FY2016 TIP for Circuit trails similar to the \$5 million line item that DVRPC recently created in the Pennsylvania TIP. Elk Township does not provide safe biking roads, so many times people have thrown things at me or hit me as I'm trying to get to a safer road... This would add such value to this twp... hope you don't miss this wonderful opportunity.... I should not have to drive to C&D tow path to get a good 20 mile ride. Of course they have wonderful places for lunch while riding..

Sincerely,

Mrs. Diane Bacher Monroeville, NJ 08343-2721

Comment ID: 179





# PUBLIC COMMENT FORM

## DRAFT FY2016 FOR NEW JERSEY



Item ID# 189

**Name:** Stephen Nerney

**County:** Various Counties

**Project Title:** General Comment

**Comment:**

Dear Camden County Freeholder Cappelli and other DVRPC Board members,

I support the construction of new trails in Camden County and throughout the rest of the region that together will build 750 miles of the Circuit, the region's trail network. I support the dedication of federal transportation funds towards Circuit Trails in Mercer, Burlington, Camden and Gloucester counties. Please consider adding a line item to the FY2016 TIP for Circuit Trails similar to the \$5 million line item that DVRPC recently created in the Pennsylvania TIP.

Stephen Nerney

MARLTON, NJ 08053

Comment ID: 196





# PUBLIC COMMENT FORM

## DRAFT FY2016 FOR NEW JERSEY



Item ID# 087

**Name:** Cheryl Dzubak

**County:** Various Counties

**Project Title:** General Comment

**Comment:**

Aug 7, 2015

DVRPC Board Members

Dear Members,

I support the construction of new trails in Mercer County and throughout the rest of the region that together will build 750 miles of the Circuit, the region's trail network. I support the dedication of federal transportation funds toward Circuit trails in Mercer, Burlington, Camden and Gloucester counties. Please consider adding a line item to the FY2016 TIP for Circuit trails similar to the \$5 million line item that DVRPC recently created in the Pennsylvania TIP.

Sincerely,

Ms. Cheryl Dzubak

Trenton, NJ 08620-1531

Comment ID: 197



# PUBLIC COMMENT FORM

## DRAFT FY2016 FOR NEW JERSEY



Item ID# 074

**Name:** Alan Mattioni

**County:** Various Counties

**Project Title:** General Comment

**Comment:**

Aug 7, 2015

DVRPC Board Members

Dear Members,

I support the construction of new trails in Burlington County and throughout the rest of the region that together will build 750 miles of the Circuit, the region's trail network. I support the dedication of federal transportation funds toward Circuit trails in Mercer, Burlington, Camden and Gloucester counties. Please consider adding a line item to the FY2016 TIP for Circuit trails similar to the \$5 million line item that DVRPC recently created in the Pennsylvania TIP.

Sincerely,

Mr. Alan Mattioni

Moorestown, NJ 08057-2701

Comment ID: 198



# PUBLIC COMMENT FORM

## DRAFT FY2016 FOR NEW JERSEY



Item ID# 141

**Name:** Julie Quinn

**County:** Various Counties

**Project Title:** General Comment

**Comment:**

Aug 7, 2015

DVRPC Board Members

Dear Members,

I support the construction of new trails in Burlington County and throughout the rest of the region that together will build 750 miles of the Circuit, the region's trail network. I support the dedication of federal transportation funds toward Circuit trails in Mercer, Burlington, Camden and Gloucester counties. Please consider adding a line item to the FY2016 TIP for Circuit trails similar to the \$5 million line item that DVRPC recently created in the Pennsylvania TIP.

It is a great opportunity to improve the quality of life and health of the citizens, Thank you.

Sincerely,

Mrs. Julie Quinn

Medford, NJ 08055-9358

Comment ID: 199



# PUBLIC COMMENT FORM

## DRAFT FY2016 FOR NEW JERSEY



Item ID# 197

**Name:** Tom Messick

**County:** Various Counties

**Project Title:** General Comment

**Comment:**

Aug 7, 2015

DVRPC Board Members

Dear Members,

I support the construction of new trails in Camden County and throughout the rest of the region that together will build 750 miles of the Circuit, the region's trail network. I support the dedication of federal transportation funds toward Circuit trails in Mercer, Burlington, Camden and Gloucester counties. Please consider adding a line item to the FY2016 TIP for Circuit trails similar to the \$5 million line item that DVRPC recently created in the Pennsylvania TIP.

Sincerely,

Mr. Tom Messick

Collingswood, NJ 08108-2015

Comment ID: 200



# PUBLIC COMMENT FORM

## DRAFT FY2016 FOR NEW JERSEY



Item ID# 159

**Name:** Michael Wisniewski

**County:** Various Counties

**Project Title:** General Comment

**Comment:**

Dear Camden County Freeholder Cappelli and other DVRPC Board members,

I support the construction of new trails in Camden County and throughout the rest of the region that together will build 750 miles of the Circuit, the region's trail network. I support the dedication of federal transportation funds towards Circuit Trails in Mercer, Burlington, Camden and Gloucester counties. Please consider adding a line item to the FY2016 TIP for Circuit Trails similar to the \$5 million line item that DVRPC recently created in the Pennsylvania TIP.

Michael Wisniewski

Marlton, NJ 08053

Comment ID: 201



# PUBLIC COMMENT FORM

## DRAFT FY2016 FOR NEW JERSEY



Item ID# 116

**Name:** Glen Davis

**County:** Various Counties

**Project Title:** General Comment

**Comment:**

Aug 7, 2015

DVRPC Board Members

Dear Members,

I support the construction of new trails in Camden County and throughout the rest of the region that together will build 750 miles of the Circuit, the region's trail network. I support the dedication of federal transportation funds toward Circuit trails in Mercer, Burlington, Camden and Gloucester counties. Please consider adding a line item to the FY2016 TIP for Circuit trails similar to the \$5 million line item that DVRPC recently created in the Pennsylvania TIP.

Sincerely,

Mr. Glen Davis

Somerdale, NJ 08083-1105

Comment ID: 202



# PUBLIC COMMENT FORM

## DRAFT FY2016 FOR NEW JERSEY



Item ID# 094

**Name:** Dan Cogan

**County:** Various Counties

**Project Title:** General Comment

**Comment:**

Aug 7, 2015

DVRPC Board Members

Dear Members,

I support the construction of new trails in Gloucester County and throughout the rest of the region that together will build 750 miles of the Circuit, the region's trail network. I support the dedication of federal transportation funds toward Circuit trails in Mercer, Burlington, Camden and Gloucester counties. Please consider adding a line item to the FY2016 TIP for Circuit trails similar to the \$5 million line item that DVRPC recently created in the Pennsylvania TIP.

Sincerely,

Mr. Dan Cogan

Clementon, NJ 08021-6474

Comment ID: 203



# PUBLIC COMMENT FORM

## DRAFT FY2016 FOR NEW JERSEY



Item ID# 083

**Name:** Bryan Richards

**County:** Various Counties

**Project Title:** General Comment

**Comment:**

Dear Gloucester County Freeholder Chila and other DVRPC Board members,

I support the construction of new trails in Gloucester County and throughout the rest of the region that together will build 750 miles of the Circuit, the region's trail network. I support the dedication of federal transportation funds towards Circuit Trails in Mercer, Burlington, Camden and Gloucester counties. Please consider adding a line item to the FY2016 TIP for Circuit Trails similar to the \$5 million line item that DVRPC recently created in the Pennsylvania TIP.

Bryan Richards

Glassboro, NJ 08028

Comment ID: 204





# PUBLIC COMMENT FORM

## DRAFT FY2016 FOR NEW JERSEY



Item ID# 177

**Name:** Robert Bonner

**County:** Various Counties

**Project Title:** General Comment

**Comment:**

Aug 7, 2015

DVRPC Board Members

Dear Members,

I support the construction of new trails in Camden County and throughout the rest of the region that together will build 750 miles of the Circuit, the region's trail network. I support the dedication of federal transportation funds toward Circuit trails in Mercer, Burlington, Camden and Gloucester counties. Please consider adding a line item to the FY2016 TIP for Circuit trails similar to the \$5 million line item that DVRPC recently created in the Pennsylvania TIP.

Sincerely,

Mr. Robert Bonner

Mount Ephraim, NJ 08059-1342

Comment ID: 205



# PUBLIC COMMENT FORM

## DRAFT FY2016 FOR NEW JERSEY



Item ID# 132

**Name:** Joan Prins

**County:** Various Counties

**Project Title:** General Comment

**Comment:**

Aug 7, 2015

DVRPC Board Members

Dear Members,

I support the construction of new trails in Mercer County and throughout the rest of the region that together will build 750 miles of the Circuit, the region's trail network. I support the dedication of federal transportation funds toward Circuit trails in Mercer, Burlington, Camden and Gloucester counties. Please consider adding a line item to the FY2016 TIP for Circuit trails similar to the \$5 million line item that DVRPC recently created in the Pennsylvania TIP.

Sincerely,

Ms. Joan Prins

West Windsor, NJ 08550-2935

Comment ID: 206



# PUBLIC COMMENT FORM

## DRAFT FY2016 FOR NEW JERSEY



Item ID#

**Name:** Michael Cannon

**County:** Various Counties

**Project Title:** General Comment

**Comment:**

Dear Camden County Freeholder Cappelli and other DVRPC Board members,

I support the construction of new trails in Camden County and throughout the rest of the region that together will build 750 miles of the Circuit, the region's trail network. I support the dedication of federal transportation funds towards Circuit Trails in Mercer, Burlington, Camden and Gloucester counties. Please consider adding a line item to the FY2016 TIP for Circuit Trails similar to the \$5 million line item that DVRPC recently created in the Pennsylvania TIP.

Michael Cannon

Laurel Springs, NJ 08021

Comment ID: 207



# PUBLIC COMMENT FORM

## DRAFT FY2016 FOR NEW JERSEY



Item ID# 191

**Name:** Steven Fenster

**County:** Various Counties

**Project Title:** General Comment

**Comment:**

Aug 8, 2015

DVRPC Board Members

Dear Members,

As a constituent and someone who hikes or walks on Burlington County trails weekly, I support the construction of new trails in Burlington County and throughout the rest of the region that together will build 750 miles of the Circuit, the region's trail network. I support the dedication of federal transportation funds toward Circuit trails in Mercer, Burlington, Camden and Gloucester counties. Please consider adding a line item to the FY2016 TIP for Circuit trails similar to the \$5 million line item that DVRPC recently created in the Pennsylvania TIP.

Sincerely,

Mr. Steven Fenster

Pemberton, NJ 08068-1231

Comment ID: 208



# PUBLIC COMMENT FORM

## DRAFT FY2016 FOR NEW JERSEY



Item ID# 088

**Name:** Cheryl Huntzinger

**County:** Various Counties

**Project Title:** General Comment

**Comment:**

Aug 8, 2015

DVRPC Board Members

Dear Members,

I support the construction of new trails in Gloucester County and throughout the rest of the region that together will build 750 miles of the Circuit, the region's trail network. I support the dedication of federal transportation funds toward Circuit trails in Mercer, Burlington, Camden and Gloucester counties. Please consider adding a line item to the FY2016 TIP for Circuit trails similar to the \$5 million line item that DVRPC recently created in the Pennsylvania TIP.

My husband and I have been a resident of Gloucester County since 1973.

We are avid bicycle riders. We use the Glassboro to Monroe trail several times a week. We have traveled the country riding trails.

Thus spending our money in other states. Adding additional trails in Gloucester County and New Jersey may result in tourist money being spent here. It is our opinion that any additional funding spent on the expansion of trails suitable for walking, running or biking is an excellent use of tax dollars.

Sincerely,

Ms. Cheryl Huntzinger

Grenloch, NJ 08032-0096

Comment ID: 210





# PUBLIC COMMENT FORM

## DRAFT FY2016 FOR NEW JERSEY



**Name:** Lyndsey Fraser

**County:** Various Counties

**Project Title:** General Comment

**Comment:**

Aug 8, 2015

DVRPC Board Members

Dear Members,

I support the construction of new trails in Gloucester County and throughout the rest of the region that together will build 750 miles of the Circuit, the region's trail network. I support the dedication of federal transportation funds toward Circuit trails in Mercer, Burlington, Camden and Gloucester counties. Please consider adding a line item to the FY2016 TIP for Circuit trails similar to the \$5 million line item that DVRPC recently created in the Pennsylvania TIP. New trails and improved maintenance of existing trails will provide greater opportunity for spending more time outdoors. I encourage the use of trails to all bikers, runners, and walkers alike to avoid the dangers of busy roads. Trails in this area will be utilized by a variety of ages; therefore, providing ample opportunity for personal growth and physical conditioning. I ask, today, that you consider continuing the growth of trails in the Gloucester County and surrounding areas so everyone can experience the joy of being outdoors. Thank you for your time.

Sincerely,

Ms. Lyndsey Fraser

Monroeville, NJ 08343-1864

Comment ID: 211





# PUBLIC COMMENT FORM

## DRAFT FY2016 FOR NEW JERSEY



Item ID# 190

**Name:** Steve Friedlander

**County:** Various Counties

**Project Title:** General Comment

**Comment:**

Aug 8, 2015

DVRPC Board Members

Dear Members,

I support the construction of new trails in Mercer County and throughout the rest of the region that together will build 750 miles of the Circuit, the region's trail network. I support the dedication of federal transportation funds toward Circuit trails in Mercer, Burlington, Camden and Gloucester counties. Please consider adding a line item to the FY2016 TIP for Circuit trails similar to the \$5 million line item that DVRPC recently created in the Pennsylvania TIP.

Sincerely,

Mr. Steve Friedlander

Hamilton Square, NJ 08690-1947

Comment ID: 212



# PUBLIC COMMENT FORM

## DRAFT FY2016 FOR NEW JERSEY



Item ID# 114

**Name:** Frank Kearney

**County:** Various Counties

**Project Title:** General Comment

**Comment:**

Aug 8, 2015

DVRPC Board Members

Dear Members,

I support the construction of new trails in Burlington County and throughout the rest of the region that together will build 750 miles of the Circuit, the region's trail network. I support the dedication of federal transportation funds toward Circuit trails in Mercer, Burlington, Camden and Gloucester counties. Please consider adding a line item to the FY2016 TIP for Circuit trails similar to the \$5 million line item that DVRPC recently created in the Pennsylvania TIP.

Sincerely,

Mr. Frank Kearney

Medford, NJ 08055-8338

Comment ID: 213



# PUBLIC COMMENT FORM

## DRAFT FY2016 FOR NEW JERSEY



Item ID# 117

**Name:** Gwyn Hurd

**County:** Various Counties

**Project Title:** General Comment

**Comment:**

Aug 9, 2015

DVRPC Board Members

Dear Members,

I support the construction of new trails in Burlington County and throughout the rest of the region that together will build 750 miles of the Circuit, the region's trail network. I support the dedication of federal transportation funds toward Circuit trails in Mercer, Burlington, Camden and Gloucester counties. Please consider adding a line item to the FY2016 TIP for Circuit trails similar to the \$5 million line item that DVRPC recently created in the Pennsylvania TIP.

Sincerely,

Ms. Gwyn Hurd

Medford, NJ 08055-2365

Comment ID: 214



# PUBLIC COMMENT FORM

## DRAFT FY2016 FOR NEW JERSEY



Item ID# 186

**Name:** Shelley Hill

**County:** Various Counties

**Project Title:** General Comment

**Comment:**

Aug 9, 2015

DVRPC Board Members

Dear Members,

I support the construction of new trails in Gloucester County and throughout the rest of the region that together will build 750 miles of the Circuit, the region's trail network. I support the dedication of federal transportation funds toward Circuit trails in Mercer, Burlington, Camden and Gloucester counties. Please consider adding a line item to the FY2016 TIP for Circuit trails similar to the \$5 million line item that DVRPC recently created in the Pennsylvania TIP.

Sincerely,

Ms. Shelley Hill

West Deptford, NJ 08086-3178

Comment ID: 215



# PUBLIC COMMENT FORM

## DRAFT FY2016 FOR NEW JERSEY



Item ID# 183

**Name:** Sandra Shapiro

**County:** Various Counties

**Project Title:** General Comment

**Comment:**

Aug 9, 2015

DVRPC Board Members

Dear Members,

I support the construction of new trails in Mercer County and throughout the rest of the region that together will build 750 miles of the Circuit, the region's trail network. I support the dedication of federal transportation funds toward Circuit trails in Mercer, Burlington, Camden and Gloucester counties. Please consider adding a line item to the FY2016 TIP for Circuit trails similar to the \$5 million line item that DVRPC recently created in the Pennsylvania TIP. The more off-road trails there are, the safer the transportation system will be.

Thank you for your attention.

Sincerely,

Mrs. Sandra Shapiro

Princeton Junction, NJ 08550-1223

Comment ID: 216



# PUBLIC COMMENT FORM

## DRAFT FY2016 FOR NEW JERSEY



Item ID# 174

**Name:** Richard Moore

**County:** Various Counties

**Project Title:** General Comment

**Comment:**

Dear Burlington County Freeholder Garganio and other DVRPC Board members,

I support the construction of new trails in Burlington County and throughout the rest of the region that together will build 750 miles of the Circuit, the region's trail network. I support the dedication of federal transportation funds towards Circuit Trails in Mercer, Burlington, Camden and Gloucester counties. Please consider adding a line item to the FY2016 TIP for Circuit Trails similar to the \$5 million line item that DVRPC recently created in the Pennsylvania TIP.

Richard Moore

Palmyra, NJ 08065

Comment ID: 217



# PUBLIC COMMENT FORM

## DRAFT FY2016 FOR NEW JERSEY



Item ID# 089

**Name:** Chris Cominetto

**County:** Various Counties

**Project Title:** General Comment

**Comment:**

Dear Camden County Freeholder Cappelli and other DVRPC Board members,

I support the construction of new trails in Camden County and throughout the rest of the region that together will build 750 miles of the Circuit, the region's trail network. I support the dedication of federal transportation funds towards Circuit Trails in Mercer, Burlington, Camden and Gloucester counties. Please consider adding a line item to the FY2016 TIP for Circuit Trails similar to the \$5 million line item that DVRPC recently created in the Pennsylvania TIP.

Chris Cominetto

Cherry Hill, NJ 08003

Comment ID: 218



# PUBLIC COMMENT FORM

## DRAFT FY2016 FOR NEW JERSEY



Item ID# 119

**Name:** Hilary Butera

**County:** Various Counties

**Project Title:** General Comment

**Comment:**

Aug 7, 2015

DVRPC Board Members

Dear Members,

I support the construction of new trails in Mercer County and throughout the rest of the region that together will build 750 miles of the Circuit, the region's trail network. I support the dedication of federal transportation funds toward Circuit trails in Mercer, Burlington, Camden and Gloucester counties. Please consider adding a line item to the FY2016 TIP for Circuit trails similar to the \$5 million line item that DVRPC recently created in the Pennsylvania TIP.

Sincerely,

Mrs. Hilary Butera

Lawrenceville, NJ 08648-3247

Comment ID: 180





# PUBLIC COMMENT FORM

## DRAFT FY2016 FOR NEW JERSEY



Item ID# 185

**Name:** Scott Layou

**County:** Various Counties

**Project Title:** General Comment

**Comment:**

Aug 7, 2015

DVRPC Board Members

Dear Members,

I support the construction of new trails in Burlington County and throughout the rest of the region that together will build 750 miles of the Circuit, the region's trail network. I support the dedication of federal transportation funds toward Circuit trails in Mercer, Burlington, Camden and Gloucester counties. Please consider adding a line item to the FY2016 TIP for Circuit trails similar to the \$5 million line item that DVRPC recently created in the Pennsylvania TIP.

Sincerely,

Mr. Scott Layou

Sewell, NJ 08080-1235

Comment ID: 181



# PUBLIC COMMENT FORM

## DRAFT FY2016 FOR NEW JERSEY



Item ID# 110

**Name:** Ed Arnold

**County:** Various Counties

**Project Title:** General Comment

**Comment:**

Aug 7, 2015

DVRPC Board Members

Dear Members,

I support the construction of new trails in Gloucester County and throughout the rest of the region that together will build 750 miles of the Circuit, the region's trail network. I support the dedication of federal transportation funds toward Circuit trails in Mercer, Burlington, Camden and Gloucester counties. Please consider adding a line item to the FY2016 TIP for Circuit trails similar to the \$5 million line item that DVRPC recently created in the Pennsylvania TIP.

Sincerely,

Mr. Ed Arnold

Sicklerville, NJ 08081-4007

Comment ID: 182



# PUBLIC COMMENT FORM

## DRAFT FY2016 FOR NEW JERSEY



Item ID# 104

**Name:** Dennis McDonald

**County:** Various Counties

**Project Title:** General Comment

**Comment:**

Aug 7, 2015

DVRPC Board Members

Dear Members,

I support the construction of new trails in Burlington County and throughout the rest of the region that together will build 750 miles of the Circuit, the region's trail network. I support the dedication of federal transportation funds toward Circuit trails in Mercer, Burlington, Camden and Gloucester counties. Please consider adding a line item to the FY2016 TIP for Circuit trails similar to the \$5 million line item that DVRPC recently created in the Pennsylvania TIP.

Sincerely,

Mr. Dennis McDonald

Medford, NJ 08055-9240

Comment ID: 183



# PUBLIC COMMENT FORM

## DRAFT FY2016 FOR NEW JERSEY



Item ID# 179

**Name:** Ron Bruner

**County:** Various Counties

**Project Title:** General Comment

**Comment:**

Aug 7, 2015

DVRPC Board Members

Dear Members,

I support the construction of new trails in Gloucester County and throughout the rest of the region that together will build 750 miles of the Circuit, the region's trail network. I support the dedication of federal transportation funds toward Circuit trails in Mercer, Burlington, Camden and Gloucester counties. Please consider adding a line item to the FY2016 TIP for Circuit trails similar to the \$5 million line item that DVRPC recently created in the Pennsylvania TIP.

Sincerely,

Mr. Ron Bruner

Sewell, NJ 08080-1832

Comment ID: 184



# PUBLIC COMMENT FORM

## DRAFT FY2016 FOR NEW JERSEY



Item ID# 080

**Name:** Bill Garrett

**County:** Various Counties

**Project Title:** General Comment

**Comment:**

Aug 7, 2015

DVRPC Board Members

Dear Members,

I support the construction of new trails in Mercer County and throughout the rest of the region that together will build 750 miles of the Circuit, the region's trail network. I support the dedication of federal transportation funds toward Circuit trails in Mercer, Burlington, Camden and Gloucester counties. Please consider adding a line item to the FY2016 TIP for Circuit trails similar to the \$5 million line item that DVRPC recently created in the Pennsylvania TIP.

Sincerely,

Mr. Bill Garrett

Princeton Junction, NJ 08550-3415

Comment ID: 185



# PUBLIC COMMENT FORM

## DRAFT FY2016 FOR NEW JERSEY



Item ID# 175

**Name:** Richard Titley

**County:** Various Counties

**Project Title:** General Comment

**Comment:**

Aug 7, 2015

DVRPC Board Members

Dear Members,

I support the construction of new trails in Gloucester County and throughout the rest of the region that together will build 750 miles of the Circuit, the region's trail network. I support the dedication of federal transportation funds toward Circuit trails in Mercer, Burlington, Camden and Gloucester counties. Please consider adding a line item to the FY2016 TIP for Circuit trails similar to the \$5 million line item that DVRPC recently created in the Pennsylvania TIP.

Sincerely,

Mr. Richard Titley

Pitman, NJ 08071-1551

Comment ID: 186



# PUBLIC COMMENT FORM

## DRAFT FY2016 FOR NEW JERSEY



Item ID# 136

**Name:** John Mueller

**County:** Various Counties

**Project Title:** General Comment

**Comment:**

Aug 7, 2015

DVRPC Board Members

Dear Members,

I support the construction of new trails in Camden County and throughout the rest of the region that together will build 750 miles of the Circuit, the region's trail network. I support the dedication of federal transportation funds toward Circuit trails in Mercer, Burlington, Camden and Gloucester counties. Please consider adding a line item to the FY2016 TIP for Circuit trails similar to the \$5 million line item that DVRPC recently created in the Pennsylvania TIP.

Sincerely,

Mr. John Mueller

Cherry Hill, NJ 08034-3101

Comment ID: 187



# PUBLIC COMMENT FORM

## DRAFT FY2016 FOR NEW JERSEY



Item ID# 133

**Name:** Joe Orr

**County:** Various Counties

**Project Title:** General Comment

**Comment:**

Aug 7, 2015

DVRPC Board Members

Dear Members,

I support the construction of new trails in Burlington County and throughout the rest of the region that together will build 750 miles of the Circuit, the region's trail network. I support the dedication of federal transportation funds toward Circuit trails in Mercer, Burlington, Camden and Gloucester counties. Please consider adding a line item to the FY2016 TIP for Circuit trails similar to the \$5 million line item that DVRPC recently created in the Pennsylvania TIP.

Sincerely,

Mr. Joe Orr

3121 Harbour Dr

Palmyra, NJ 08065-2219

Comment ID: 188





# PUBLIC COMMENT FORM

## DRAFT FY2016 FOR NEW JERSEY



Item ID# 180

**Name:** S. Nisenfeld

**County:** Various Counties

**Project Title:** General Comment

**Comment:**

Aug 7, 2015

DVRPC Board Members

Dear Members,

I support the construction of new trails in Camden County and throughout the rest of the region that together will build 750 miles of the Circuit, the region's trail network. I support the dedication of federal transportation funds toward Circuit trails in Mercer, Burlington, Camden and Gloucester counties. Please consider adding a line item to the FY2016 TIP for Circuit trails similar to the \$5 million line item that DVRPC recently created in the Pennsylvania TIP.

Sincerely,

Mr. S. Nisenfeld

Audubon, NJ 08106-1107

Comment ID: 189



# PUBLIC COMMENT FORM

## DRAFT FY2016 FOR NEW JERSEY



Item ID# 158

**Name:** Michael Vitez

**County:** Various Counties

**Project Title:** General Comment

**Comment:**

Aug 7, 2015

DVRPC Board Members

Dear Members,

I support the construction of new trails in Camden County and throughout the rest of the region that together will build 750 miles of the Circuit, the region's trail network. I support the dedication of federal transportation funds toward Circuit trails in Mercer, Burlington, Camden and Gloucester counties. Please consider adding a line item to the FY2016 TIP for Circuit trails similar to the \$5 million line item that DVRPC recently created in the Pennsylvania TIP.

Sincerely,

Mr. Michael Vitez

Haddonfield, NJ 08033-1470

Comment ID: 190



# PUBLIC COMMENT FORM

## DRAFT FY2016 FOR NEW JERSEY



Item ID# 109

**Name:** Dr. Mark Waltzer

**County:** Various Counties

**Project Title:** General Comment

**Comment:**

Aug 7, 2015

DVRPC Board Members

Dear Members,

I support the construction of new trails in Camden County and throughout the rest of the region that together will build 750 miles of the Circuit, the region's trail network. I support the dedication of federal transportation funds toward Circuit trails in Mercer, Burlington, Camden and Gloucester counties. Please consider adding a line item to the FY2016 TIP for Circuit trails similar to the \$5 million line item that DVRPC recently created in the Pennsylvania TIP.

Sincerely,

Dr. Mark Waltzer

Cherry Hill, NJ 08003-1536

Comment ID: 191



# PUBLIC COMMENT FORM

## DRAFT FY2016 FOR NEW JERSEY



**Name:** James Andrews

**County:** Various Counties

**Project Title:** General Comment

**Comment:**

Aug 7, 2015

DVRPC Board Members

Dear Members,

I support the construction of new trails in Mercer County and throughout the rest of the region that together will build 750 miles of the Circuit, the region's trail network. I support the dedication of federal transportation funds toward Circuit trails in Mercer, Burlington, Camden and Gloucester counties. Please consider adding a line item to the FY2016 TIP for Circuit trails similar to the \$5 million line item that DVRPC recently created in the Pennsylvania TIP.

There are opportunities in Mercer County, like the Hamilton-Robbinsville Conrail tracks that could become part of the network of bicycling-walking trails in Mercer County. I ride on the Lawrence-Hopewell Trail and the trail along the D&R Canal and would like to have more trails to ride that go a long distance and are free from cars.

Thank you,

Jim Andrews

Hopewell NJ

Sincerely,

Mr. James Andrews

Hopewell, NJ 08525-1108

Comment ID: 192



# PUBLIC COMMENT FORM

## DRAFT FY2016 FOR NEW JERSEY



Item ID# 155

**Name:** Marie Holmdal

**County:** Various Counties

**Project Title:** General Comment

**Comment:**

Aug 7, 2015

DVRPC Board Members

Dear Members,

Once again, I am writing to express my support for the construction of new trails in Gloucester County and throughout the rest of the region that together will build 750 miles of the Circuit, the region's trail network. I support the dedication of federal transportation funds toward Circuit trails in Mercer, Burlington, Camden and Gloucester counties.

I personally have used a number of the exiting trails in these counties and see the value to the communities served. The trails provide for safe, outdoor exercise and quality social time out of doors for friends and families.

Please consider adding a line item to the FY2016 TIP for Circuit trails similar to the \$5 million line item that DVRPC recently created in the Pennsylvania TIP.

Sincerely,

Ms. Marie Holmdal

Woodbury, NJ 08096-2838

Comment ID: 193



# PUBLIC COMMENT FORM

## DRAFT FY2016 FOR NEW JERSEY



**Name:** Jeffrey Laurenti

**County:** Various Counties

**Project Title:** General Comment

**Comment:**

Aug 7, 2015

DVRPC Board Members

Dear Members,

Dear Brian (CoEx) and freeholders Sam (ch.), Andy (v-ch), Ann, Tony, John, Pasquale "Pat," and Lucy (I think I've alphabetized you in proper order!):

I had addressed the freeholders a year or so ago about Complete Streets, and as a cheerleader of and for the Trenton Cycling Revolution group I now want to join other supporters of the proposed regional trails development program advanced by the Delaware Valley Regional Planning Commission and by our area Rails-to-Trails group.

In particular, I hope you will support the construction of a major new trail in eastern Mercer County on the truly historic Camden and Amboy rail bed, initially between Yardville and Robbinsville and, insha'allah, eventually to Bordentown in the south and Hightstown/Cranbury to the north. The full program throughout the rest of the region will build 750 miles of the Circuit, the region's trail network. We'd hope our enlightened Democratic-led county government will set the example for Mercer, Burlington, Camden and Gloucester counties by dedication of federal transportation funds toward Circuit trails.

Please consider adding a line item to the FY2016 TIP for Circuit trails similar to the \$5 million line item that DVRPC recently created in the Pennsylvania TIP.

Sincerely,

Mr. Jeffrey Laurenti

Trenton, NJ 08609-2711

Comment ID: 194





# PUBLIC COMMENT FORM

## DRAFT FY2016 FOR NEW JERSEY



Item ID# 182

**Name:** Sam Spanier

**County:** Various Counties

**Project Title:** General Comment

**Comment:**

Dear Camden County Freeholder Cappelli and other DVRPC Board members,

I support the construction of new trails in Camden County and throughout the rest of the region that together will build 750 miles of the Circuit, the region's trail network. I support the dedication of federal transportation funds towards Circuit Trails in Mercer, Burlington, Camden and Gloucester counties. Please consider adding a line item to the FY2016 TIP for Circuit Trails similar to the \$5 million line item that DVRPC recently created in the Pennsylvania TIP.

Sam Spanier

Haddon heights, NJ 08035

Comment ID: 195



# PUBLIC COMMENT FORM

## DRAFT FY2016 FOR NEW JERSEY



Item ID# 020

**Name:** Cyndi Steiner

**County:** Camden County

**Project Title:** ADA Improvements

**DB#:** D1505

**Comment:**

Projects we support without additional comment: DB# D9902 D1505 D0902 95040 X065 D0204 06327 06403 06401 99409 X107 DR046

Comment ID: 152



# PUBLIC COMMENT FORM

## DRAFT FY2016 FOR NEW JERSEY



Item ID# 018

**Name:** Cyndi Steiner

**County:** Camden County

**Project Title:** River Road Improvements, Cramer Hill

**DB#:** D0902

**Comment:**

Projects we support without additional comment: DB# D9902 D1505 D0902 95040 X065 D0204 06327 06403 06401 99409 X107 DR046

Comment ID: 153



# PUBLIC COMMENT FORM

## DRAFT FY2016 FOR NEW JERSEY



Item ID# 037

**Name:** Cyndi Steiner

**County:** Mercer County

**Project Title:** Route 206, Whitehorse Circle (CR 533, 524)

**DB#:** 95040

**Comment:**

Projects we support without additional comment: DB# D9902 D1505 D0902 95040 X065 D0204 06327 06403 06401 99409 X107 DR046

Comment ID: 154



# PUBLIC COMMENT FORM

## DRAFT FY2016 FOR NEW JERSEY



Item ID# 060

**Name:** Cyndi Steiner

**County:** Various Counties

**Project Title:** Local CMAQ Initiatives

**DB#:** X065

**Comment:**

Projects we support without additional comment: DB# D9902 D1505 D0902 95040 X065 D0204 06327 06403 06401 99409 X107 DR046

Comment ID: 155



# PUBLIC COMMENT FORM

## DRAFT FY2016 FOR NEW JERSEY



Item ID# 056

**Name:** Cyndi Steiner

**County:** Various Counties

**Project Title:** Transportation and Community Development Initiative (TCDI) DVRPC

**DB#:** D0204

**Comment:**

Projects we support without additional comment: DB# D9902 D1505 D0902 95040 X065 D0204 06327 06403 06401 99409 X107 DR046

Comment ID: 156



# PUBLIC COMMENT FORM

## DRAFT FY2016 FOR NEW JERSEY



Item ID# 042

**Name:** Cyndi Steiner

**County:** Various Counties

**Project Title:** Local Aid Grant Management System

**DB#:** 06327

**Comment:**

Projects we support without additional comment: DB# D9902 D1505 D0902 95040 X065 D0204 06327 06403 06401 99409 X107 DR046

Comment ID: 157



# PUBLIC COMMENT FORM

## DRAFT FY2016 FOR NEW JERSEY



Item ID# 044

**Name:** Cyndi Steiner

**County:** Various Counties

**Project Title:** Pedestrian Safety Improvement Program

**DB#:** 06401

**Comment:**

Projects we support without additional comment: DB# D9902 D1505 D0902 95040 X065 D0204 06327 06403 06401 99409 X107 DR046

Comment ID: 158





# PUBLIC COMMENT FORM

## DRAFT FY2016 FOR NEW JERSEY



Item ID# 048

**Name:** Cyndi Steiner

**County:** Various Counties

**Project Title:** Pedestrian Safety Improvement Design and Construction

**DB#:** 06403

**Comment:**

Projects we support without additional comment: DB# D9902 D1505 D0902 95040 X065 D0204 06327 06403 06401 99409 X107 DR046

Comment ID: 159



# PUBLIC COMMENT FORM

## DRAFT FY2016 FOR NEW JERSEY



Item ID# 054

**Name:** Cyndi Steiner

**County:** Various Counties

**Project Title:** Recreational Trails Program

**DB#:** 99409

**Comment:**

Projects we support without additional comment: DB# D9902 D1505 D0902 95040 X065 D0204 06327 06403 06401 99409 X107 DR046

Comment ID: 160



# PUBLIC COMMENT FORM

## DRAFT FY2016 FOR NEW JERSEY



Item ID# 062

**Name:** Cyndi Steiner

**County:** Various Counties

**Project Title:** Transportation Alternatives Program

**DB#:** X107

**Comment:**

Projects we support without additional comment: DB# D9902 D1505 D0902 95040 X065 D0204 06327 06403 06401 99409 X107 DR046

Comment ID: 161



# PUBLIC COMMENT FORM

## DRAFT FY2016 FOR NEW JERSEY



Item ID# 202

**Name:** Cyndi Steiner

**County:** DRPA/PATCO

**Project Title:** DRPA - Rebuild PATCO Cars

**DB#:** DR046

**Comment:**

Projects we support without additional comment: DB# D9902 D1505 D0902 95040 X065 D0204 06327 06403 06401 99409 X107 DR046

Comment ID: 162



# PUBLIC COMMENT FORM

## DRAFT FY2016 FOR NEW JERSEY



Item ID# 008

**Name:** Cyndi Steiner

**County:** Burlington County

**Project Title:** Route 130, Van Sciver Pkwy to Crafts Creek

**DB#:** 12415

**Comment:**

A safe pedestrian crossing is needed at Van Sciver Parkway to accommodate businesses on both sides of the highway (Willingboro Town Center, Dealerships, Various Small businesses).

Comment ID: 148



# PUBLIC COMMENT FORM

## DRAFT FY2016 FOR NEW JERSEY



Item ID# 113

**Name:** Eleanor Horne

**County:** Various Counties

**Project Title:** General Comment

**Comment:**

Dear County Executive Hughes and other DVRPC Board members,

I support the construction of new trails in Mercer County and throughout the rest of the region that together will build 750 miles of the Circuit, the region's trail network. I support the dedication of federal transportation funds towards Circuit Trails in Mercer, Burlington, Camden and Gloucester counties. Please consider adding a line item to the FY2016 TIP for Circuit Trails similar to the \$5 million line item that DVRPC recently created in the Pennsylvania TIP.

Eleanor Horne

Lawrenceville, NJ 08648

Comment ID: 163



# PUBLIC COMMENT FORM

## DRAFT FY2016 FOR NEW JERSEY



Item ID# 084

**Name:** Carmen Viola

**County:** Various Counties

**Project Title:** General Comment

**Comment:**

Aug 7, 2015

DVRPC Board Members

Dear Members,

I support the construction of new trails in Gloucester County and throughout the rest of the region that together will build 750 miles of the Circuit, the region's trail network. I support the dedication of federal transportation funds toward Circuit trails in Mercer, Burlington, Camden and Gloucester counties. Please consider adding a line item to the FY2016 TIP for Circuit trails similar to the \$5 million line item that DVRPC recently created in the Pennsylvania TIP.

Sincerely,

Mr. Carmen Viola

Williamstown, NJ 08094-1988

Comment ID: 164



# PUBLIC COMMENT FORM

## DRAFT FY2016 FOR NEW JERSEY



Item ID# 076

**Name:** Anthony Goodman

**County:** Various Counties

**Project Title:** General Comment

**Comment:**

Aug 7, 2015

DVRPC Board Members

Dear Members,

I support the construction of new trails in Camden County and throughout the rest of the region that together will build 750 miles of the Circuit, the region's trail network. I support the dedication of federal transportation funds toward Circuit trails in Mercer, Burlington, Camden and Gloucester counties. Please consider adding a line item to the FY2016 TIP for Circuit trails similar to the \$5 million line item that DVRPC recently created in the Pennsylvania TIP.

Sincerely,

Mr. Anthony Goodman

Sicklerville, NJ 08081-1139

Comment ID: 165





# PUBLIC COMMENT FORM

## DRAFT FY2016 FOR NEW JERSEY



Item ID# 111

**Name:** Eddie Monterrosa

**County:** Various Counties

**Project Title:** General Comment

**Comment:**

Aug 7, 2015

DVRPC Board Members

Dear Members,

I support the construction of new trails in Camden County and throughout the rest of the region that together will build 750 miles of the Circuit, the region's trail network. I support the dedication of federal transportation funds toward Circuit trails in Mercer, Burlington, Camden and Gloucester counties. Please consider adding a line item to the FY2016 TIP for Circuit trails similar to the \$5 million line item that DVRPC recently created in the Pennsylvania TIP.

Sincerely,

Mr. Eddie Monterrosa

Cherry Hill, NJ 08002-1305

Comment ID: 166



# PUBLIC COMMENT FORM

## DRAFT FY2016 FOR NEW JERSEY



Item ID# 188

**Name:** Stephen Brown

**County:** Various Counties

**Project Title:** General Comment

**Comment:**

Aug 7, 2015

DVRPC Board Members

Dear Members,

I support the construction of new trails in Gloucester County and throughout the rest of the region that together will build 750 miles of the Circuit, the region's trail network. I support the dedication of federal transportation funds toward Circuit trails in Mercer, Burlington, Camden and Gloucester counties. Please consider adding a line item to the FY2016 TIP for Circuit trails similar to the \$5 million line item that DVRPC recently created in the Pennsylvania TIP.

Sincerely,

Mr. Stephen Brown

Williamstown, NJ 08094-2150

Comment ID: 167



# PUBLIC COMMENT FORM

## DRAFT FY2016 FOR NEW JERSEY



Item ID# 097

**Name:** Daniel Rappoport

**County:** Various Counties

**Project Title:** General Comment

**Comment:**

Aug 7, 2015

DVRPC Board Members

Dear Members,

I support the construction of new trails in Mercer County and throughout the rest of the region that together will build 750 miles of the Circuit, the region's trail network. I support the dedication of federal transportation funds toward Circuit trails in Mercer, Burlington, Camden and Gloucester counties. Please consider adding a line item to the FY2016 TIP for Circuit trails similar to the \$5 million line item that DVRPC recently created in the Pennsylvania TIP.

Sincerely,

Mr. Daniel Rappoport

Princeton, NJ 08540-2886

Comment ID: 168



# PUBLIC COMMENT FORM

## DRAFT FY2016 FOR NEW JERSEY



Item ID# 148

**Name:** Kevin Caviston

**County:** Various Counties

**Project Title:** General Comment

**Comment:**

Aug 7, 2015

DVRPC Board Members

Dear Members,

I support the construction of new trails in Camden County and throughout the rest of the region that together will build 750 miles of the Circuit, the region's trail network. I support the dedication of federal transportation funds toward Circuit trails in Mercer, Burlington, Camden and Gloucester counties. Please consider adding a line item to the FY2016 TIP for Circuit trails similar to the \$5 million line item that DVRPC recently created in the Pennsylvania TIP.

Sincerely,

Mr. Kevin Caviston

Barrington, NJ 08007-1407

Comment ID: 169



# PUBLIC COMMENT FORM

## DRAFT FY2016 FOR NEW JERSEY



Item ID# 143

**Name:** Justin Clerval

**County:** Various Counties

**Project Title:** General Comment

**Comment:**

Aug 7, 2015

DVRPC Board Members

Dear Members,

I support the construction of new trails in Gloucester County and throughout the rest of the region that together will build 750 miles of the Circuit, the region's trail network. I support the dedication of federal transportation funds toward Circuit trails in Mercer, Burlington, Camden and Gloucester counties. Please consider adding a line item to the FY2016 TIP for Circuit trails similar to the \$5 million line item that DVRPC recently created in the Pennsylvania TIP.

Sincerely,

Mr. Justin Clerval

Sewell, NJ 08080-1565

Comment ID: 170



# PUBLIC COMMENT FORM

## DRAFT FY2016 FOR NEW JERSEY



Item ID# 169

**Name:** Patrick Randow

**County:** Various Counties

**Project Title:** General Comment

**Comment:**

Aug 7, 2015

DVRPC Board Members

Dear Members,

I support the construction of new trails in Burlington County and throughout the rest of the region that together will build 750 miles of the Circuit, the region's trail network. I support the dedication of federal transportation funds toward Circuit trails in Mercer, Burlington, Camden and Gloucester counties. Please consider adding a line item to the FY2016 TIP for Circuit trails similar to the \$5 million line item that DVRPC recently created in the Pennsylvania TIP.

Sincerely,

Mr. Patrick Randow

Burlington, NJ 08016-1030

Comment ID: 171



# PUBLIC COMMENT FORM

## DRAFT FY2016 FOR NEW JERSEY



Item ID# 127

**Name:** Jay Meier

**County:** Various Counties

**Project Title:** General Comment

**Comment:**

Aug 7, 2015

DVRPC Board Members

Dear Members,

I support the construction of new trails in Burlington County and throughout the rest of the region that together will build 750 miles of the Circuit, the region's trail network. I support the dedication of federal transportation funds toward Circuit trails in Mercer, Burlington, Camden and Gloucester counties. Please consider adding a line item to the FY2016 TIP for Circuit trails similar to the \$5 million line item that DVRPC recently created in the Pennsylvania TIP.

Sincerely,

Mr. Jay Meier

Bordentown, NJ 08505-4411

Comment ID: 172



# PUBLIC COMMENT FORM

## DRAFT FY2016 FOR NEW JERSEY



Item ID# 092

**Name:** Crystal Swanson

**County:** Various Counties

**Project Title:** General Comment

**Comment:**

Aug 7, 2015

DVRPC Board Members

Dear Members,

I support the construction of new trails in Gloucester County and throughout the rest of the region that together will build 750 miles of the Circuit, the region's trail network. I support the dedication of federal transportation funds toward Circuit trails in Mercer, Burlington, Camden and Gloucester counties. Please consider adding a line item to the FY2016 TIP for Circuit trails similar to the \$5 million line item that DVRPC recently created in the Pennsylvania TIP.

Sincerely,

Ms. Crystal Swanson

Glassboro, NJ 08028-3332

Comment ID: 173





# PUBLIC COMMENT FORM

## DRAFT FY2016 FOR NEW JERSEY



Item ID# 140

**Name:** Judyann McCarthy

**County:** Various Counties

**Project Title:** General Comment

**Comment:**

Aug 7, 2015

DVRPC Board Members

Dear Members,

I support the construction of new trails in Camden County and throughout the rest of the region that together will build 750 miles of the Circuit, the region's trail network. I support the dedication of federal transportation funds toward Circuit trails in Mercer, Burlington, Camden and Gloucester counties. Please consider adding a line item to the FY2016 TIP for Circuit trails similar to the \$5 million line item that DVRPC recently created in the Pennsylvania TIP.

Sincerely,

Mrs. Judyann McCarthy

Merchantville, NJ 08109-2036

Comment ID: 174



# PUBLIC COMMENT FORM

## DRAFT FY2016 FOR NEW JERSEY



Item ID# 145

**Name:** Karen Dieterly

**County:** Various Counties

**Project Title:** General Comment

**Comment:**

Aug 7, 2015

DVRPC Board Members

Dear Members,

I support the construction of new trails in Burlington County and throughout the rest of the region that together will build 750 miles of the Circuit, the region's trail network. I support the dedication of federal transportation funds toward Circuit trails in Mercer, Burlington, Camden and Gloucester counties. Please consider adding a line item to the FY2016 TIP for Circuit trails similar to the \$5 million line item that DVRPC recently created in the Pennsylvania TIP.

Sincerely,

Ms. Karen Dieterly

Columbus, NJ 08022-2250

Comment ID: 175



# PUBLIC COMMENT FORM

## DRAFT FY2016 FOR NEW JERSEY



Item ID# 178

**Name:** Robert Cummings

**County:** Various Counties

**Project Title:** General Comment

**Comment:**

Aug 7, 2015

DVRPC Board Members

Dear Members,

I support the construction of new trails in Burlington County and throughout the rest of the region that together will build 750 miles of the Circuit, the region's trail network. I support the dedication of federal transportation funds toward Circuit trails in Mercer, Burlington, Camden and Gloucester counties. Please consider adding a line item to the FY2016 TIP for Circuit trails similar to the \$5 million line item that DVRPC recently created in the Pennsylvania TIP.

Sincerely,

Mr. Robert Cummings

Browns Mills, NJ 08015-3321

Comment ID: 176



# PUBLIC COMMENT FORM

## DRAFT FY2016 FOR NEW JERSEY



Item ID# 035

**Name:** Jeff Taylor

**County:** Gloucester County

**Project Title:** General Comment

**Comment:**

See attached letter: Rt 42 and Cross Keys Rd

Comment ID: 224

DVRPC: This box hides the individual's personal contact information.

New Jersey FY 2016 TIP Comments  
 Delaware Valley Regional Planning Commission  
 190 N. Independence Mall West – 8<sup>th</sup> Floor  
 Philadelphia, PA 19106-1520  
[tip-plan-comments@dvrpc.org](mailto:tip-plan-comments@dvrpc.org)

August 10, 2015

*Please note: This letter was originally sent in for the FY12 New Jersey TIP. However, even though the jurisdiction for NJ 42 is NJDOT, for unknown reasons, the letter was forwarded to Gloucester County's Public Works department, which of course responded back that it wasn't their jurisdiction. I have updated this letter. Please forward this letter to NJDOT for their review.*

Please consider adding an intersection modification project to NJDOT FY16. The intersection is State Route 42 and Gloucester County Route 689, commonly known as Berlin-Cross Keys Rd. The current configuration on Rt. 42 North and South is a left turn lane, two thru lanes, and a full right shoulder. On Rt. 689, the current configuration is a left turn lane, a thru lane, and a thru/right turn lane.

This intersection should be reconstructed to allow dual left turn lanes from Rt. 42 to Rt. 689. Because of the width of the median, dual left turn lanes should fit within the existing median by removing the existing grass portion of the median between the left turn lane and the opposing lane of traffic. A narrow width curb can be installed to maintain separation of traffic. The current phasing at this intersection on Rt. 42 provides for dedicated left turn signals on Rt. 42, prohibiting left turning traffic when through-traffic on Rt. 42 has a green signal, and this phasing is assumed to stay the same under this proposed alignment. Additionally, the full right shoulder should be re-lined or widened as necessary as to legally allow right turning traffic to turn right. Depending on the sharpness of the curb, it may also be necessary to cut back the curb a little to allow vehicles to properly turn. This will remove turning traffic from the through lanes.

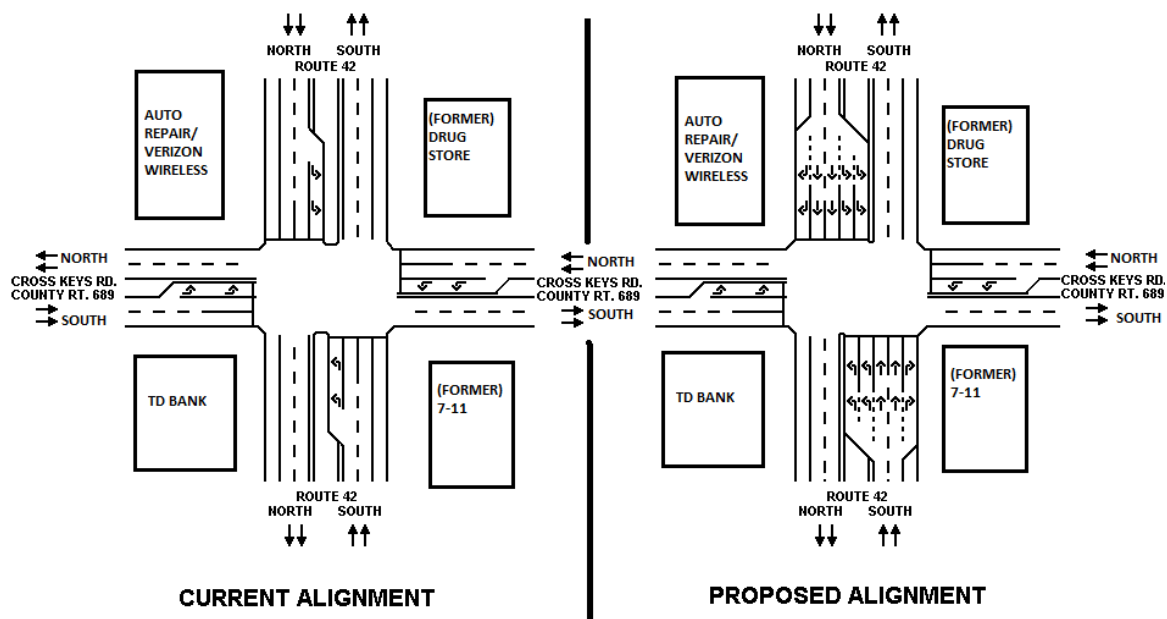

Additionally, Rt. 689 (Berlin-Cross Keys Rd.) at Rt. 42 has a leading left turn light for traffic heading on Rt. 689 South to Rt. 42 South. However, traffic on Rt. 689 North to Rt. 42 North does not have a left turn signal. An additional left turn green arrow should be added to allow opposing left turns at the same time, prior to the full phase green on Cross Keys Rd.

It is also noted that the intersection has a peak and off-peak timing. During the peak timing, traffic from all directions generally seems to be able to get through the traffic light on a single cycle (with the exception of some left turning traffic). However, during the off-peak timing, traffic - especially motorists on Northbound Cross-Keys Road - experiences a very short green cycle, and traffic can often back up significantly and takes several light cycles to get through the light. The timing of this light should be visited to determine if the cycling timing currently used for peak-volume hours should be used at all times, as this appears to provide for efficient traffic flow from all directions.

There has been a large increase of residential and commercial development on Cross Keys Road, which has been increasing the amount of traffic utilizing this intersection, especially turning onto Cross Keys Road, as well as through traffic on Cross Keys Road itself. However, the intersection has not been upgraded to accommodate this increased traffic.

What could be short-term, quick fixes will be to lengthen the left turn lane to allow more traffic to sit in the lane without blocking Rt. 42 thru traffic. Another minor adjustment will be to lengthen the left turn light from Rt. 42 North and South to Cross Keys Rd, and from Cross Keys Road to Route 42 South to allow additional traffic to make the turn, as so long as it does not cause Rt. 42's green phase to be significantly reduced, causing congestion on Rt. 42 itself. In the long-term though, the intersection should be widened to accommodate the increased traffic utilizing Cross Keys Road.

Sincerely,

Jeff Taylor



# PUBLIC COMMENT FORM

## DRAFT FY2016 FOR NEW JERSEY



Item ID# 025

**Name:** Jeff Taylor

**County:** Camden County

**Project Title:** General Comment

**Comment:**

See attached letter: Rt 73 overhead cantilever sign

Comment ID: 225

Jeff Taylor

DVRPC: This box hides the individual's personal contact information.

New Jersey FY 2016 TIP Comments  
Delaware Valley Regional Planning Commission  
190 N. Independence Mall West – 8<sup>th</sup> Floor  
Philadelphia, PA 19106-1520  
tip-plan-comments@dvrpc.org

August 10, 2015

*Please note: This letter was originally sent in for the FY12 TIP. It was stated at the time that it would be looked into by NJDOT, but since that time I haven't seen any mention regarding this idea. As the traffic volume continues to increase on this stretch of highway, with many motorists being unfamiliar with the area, I am re-submitting this letter (with minor revisions) as I feel it is an important and needed project to assist with traffic flow in this busy area.*

On Rt. 73, between I-295 and the NJ Turnpike, this congested 1/2 mile of roadway has many options for drivers, many of whom are from out of town visiting businesses, dining, staying in one of over a dozen hotels in the immediate area, and transitioning from the NJ Turnpike to I-295. However, the only signs in the area detailing the proper lane to be utilizing are along the right shoulder of the highway, and often not seen by travelers, especially those in the lanes to the left of the roadway and due to the heavy truck traffic which can be blocking the view of the signage.

A solution is to place an overhead cantilever sign above the roadway between I-295 and Fellowship Road at approximately milepost 27.42. The overhead signs, facing both directions of traffic, would easily be seen by both cars and trucks, and would allow travelers to merge more safely into the proper lane as they approach the turnpike traveling southbound, and 295 traveling northbound. This will definitely improve safety and reduce confusion from traffic quickly swerving to make the proper turns in this short but busy section of Rt. 73. Examples are attached on the next page.

This should be a fairly low cost project that should yield large benefits for travelers, many of whom are not familiar with the region. It would also provide assistance when the turnpike or 295 are closed or heavily congested, and the detour route utilizes Route 73 between these two highways.

Should you have additional questions concerning my design or other inquiries, please feel free to contact me.

Sincerely,

Jeff Taylor



Examples of potential signage:

Rt. 73 South, between I-295 & Fellowship Road, approaching the NJ Turnpike:

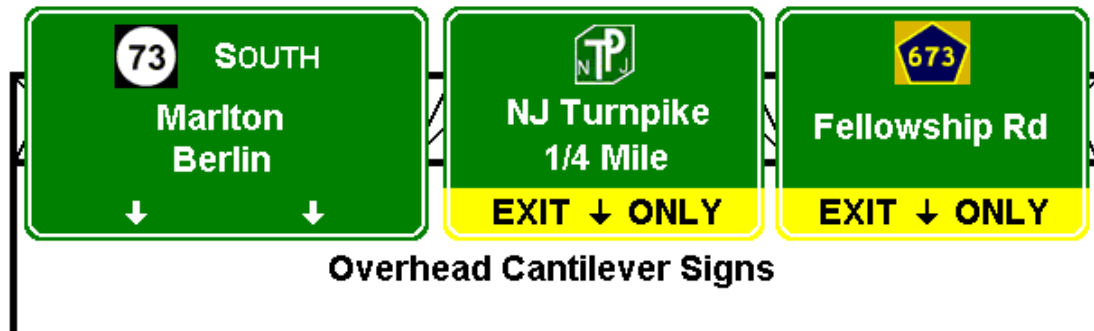

Rt. 73 North, approaching I-295:



Location of overhead signage: (Note: due to lane limitations the Northbound VMS sign would extend slightly over the concrete median)

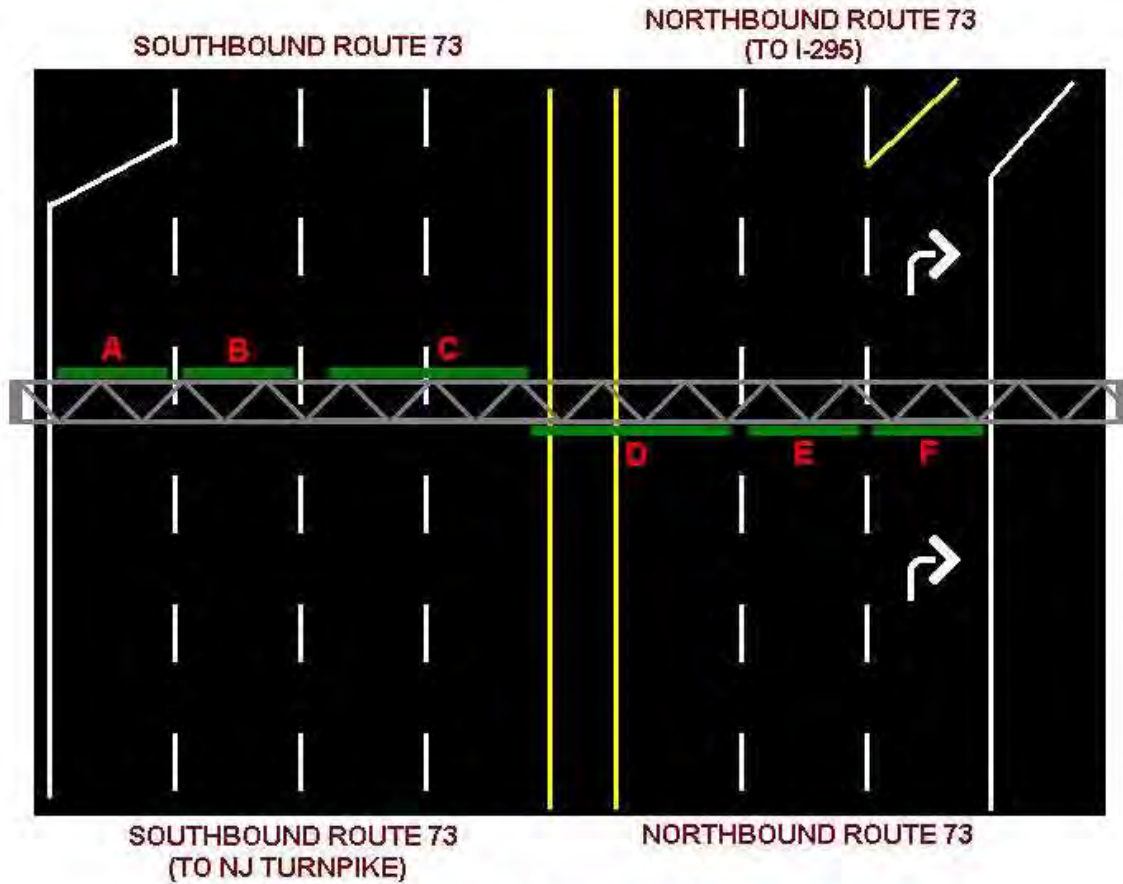

**Sign Legend:**

- |                             |                    |
|-----------------------------|--------------------|
| A - Fellowship Rd.          | D - Rt. 73 North * |
| B - NJ Turnpike             | E - I-295 South    |
| C - Rt. 73 South *          | F - I-295 North    |
| * - Destination Sign or VMS |                    |

Sign Location: Milepost 27.42  
( 1/4 mile south of I-295, 1/10 mile north of Fellowship Rd.)

Above diagram Not To Scale



# PUBLIC COMMENT FORM

## DRAFT FY2016 FOR NEW JERSEY



Item ID# 192

**Name:** Tara Emrick

**County:** Various Counties

**Project Title:** General Comment

**Comment:**

Dear Gloucester County Freeholder Chila and other DVRPC Board members,

I support the construction of new trails in Gloucester County and throughout the rest of the region that together will build 750 miles of the Circuit, the region's trail network. I support the dedication of federal transportation funds towards Circuit Trails in Mercer, Burlington, Camden and Gloucester counties. Please consider adding a line item to the FY2016 TIP for Circuit Trails similar to the \$5 million line item that DVRPC recently created in the Pennsylvania TIP.

Tara Emrick

Woolwich, NJ 08085

Comment ID: 219



# PUBLIC COMMENT FORM

## DRAFT FY2016 FOR NEW JERSEY



Item ID# 096

**Name:** Daniel Kramer

**County:** Various Counties

**Project Title:** General Comment

**Comment:**

Dear Burlington County Freeholder Garganio and other DVRPC Board members,

I support the construction of new trails in Burlington County and throughout the rest of the region that together will build 750 miles of the Circuit, the region's trail network. I support the dedication of federal transportation funds towards Circuit Trails in Mercer, Burlington, Camden and Gloucester counties. Please consider adding a line item to the FY2016 TIP for Circuit Trails similar to the \$5 million line item that DVRPC recently created in the Pennsylvania TIP.

Daniel Kramer

Mt Laurel, NJ 08054

Comment ID: 220



# PUBLIC COMMENT FORM

## DRAFT FY2016 FOR NEW JERSEY



Item ID# 098

**Name:** Daniel Wakeman

**County:** Various Counties

**Project Title:** General Comment

**Comment:**

Aug 10, 2015

DVRPC Board Members

Dear Members,

I support the construction of new trails in Mercer County and throughout the rest of the region that together will build 750 miles of the Circuit, the region's trail network. I support the dedication of federal transportation funds toward Circuit trails in Mercer, Burlington, Camden and Gloucester counties. Please consider adding a line item to the FY2016 TIP for Circuit trails similar to the \$5 million line item that DVRPC recently created in the Pennsylvania TIP.

Sincerely,

Mr. Daniel wakeman

Lawrenceville, NJ 08648-5546

Comment ID: 221



# PUBLIC COMMENT FORM

## DRAFT FY2016 FOR NEW JERSEY



Item ID# 090

**Name:** Craig Boddorff

**County:** Various Counties

**Project Title:** General Comment

**Comment:**

Aug 10, 2015

DVRPC Board Members

Dear Members,

I support the construction of new trails in Camden County and throughout the rest of the region that together will build 750 miles of the Circuit, the region's trail network. I support the dedication of federal transportation funds toward Circuit trails in Mercer, Burlington, Camden and Gloucester counties. Please consider adding a line item to the FY2016 TIP for Circuit trails similar to the \$5 million line item that DVRPC recently created in the Pennsylvania TIP.

Trails are a relatively inexpensive way to promote healthy, earth-friendly transit options in Camden County. Take a bike ride on one of the existing trails and you WILL be convinced !

Sincerely,

Mr. Craig Boddorff

Collingswood, NJ 08108-3308

Comment ID: 222



# PUBLIC COMMENT FORM

## DRAFT FY2016 FOR NEW JERSEY



Item ID# 167

**Name:** Patricia Addis-Hudson

**County:** Various Counties

**Project Title:** General Comment

**Comment:**

Aug 10, 2015

DVRPC Board Members

Dear Members,

I support the construction of new trails in Gloucester County and throughout the rest of the region that together will build 750 miles of the Circuit, the region's trail network. I support the dedication of federal transportation funds toward Circuit trails in Mercer, Burlington, Camden and Gloucester counties. Please consider adding a line item to the FY2016 TIP for Circuit trails similar to the \$5 million line item that DVRPC recently created in the Pennsylvania TIP.

Sincerely,

Mrs. Patricia Addis-Hudson

Clarksboro, NJ 08020-1318

Comment ID: 223